

#0182

COPYRIGHT NOTICE
These drawings and specifications are copyrighted and subject to copyright protection as an "architectural work" under sec. 102 of the copyright act 17 U.S.C. 102. The protection includes, without limitation, the overall form, arrangement and composition of spaces and elements of the design. Linear scale protection, unauthorized use of these drawings and specifications may result in violation of construction, building, zoning, and/or municipal liability.

**BOULEVARD SHOPS
1206 WALTON BOULEVARD
ROCHESTER HILLS, MICHIGAN 48309**



BISTRO (PATIO) SEATING PLAN

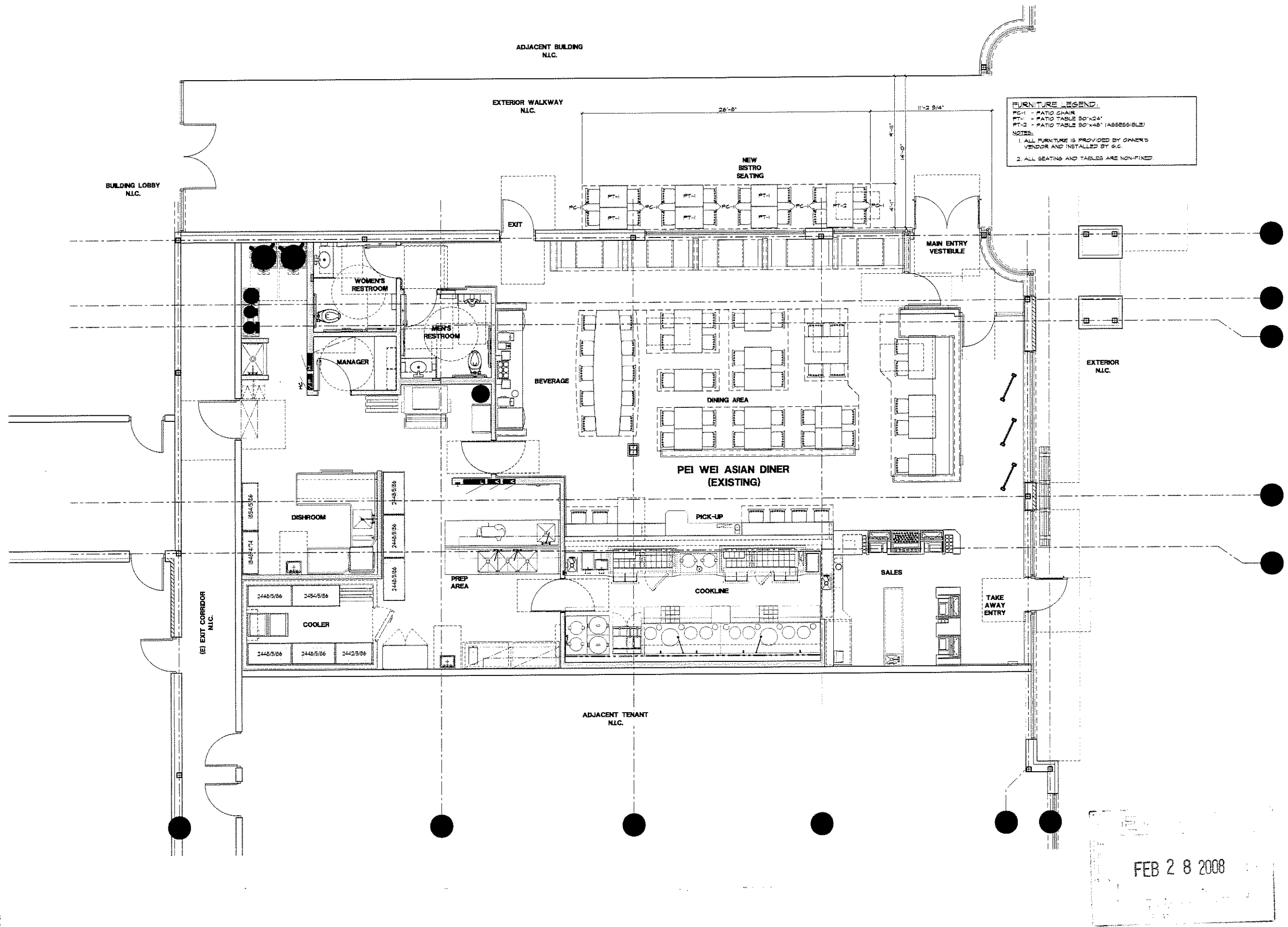

FURNITURE LEGEND:
PC-1 - PATIO CHAIR
PT-1 - PATIO TABLE 80"x24"
PT-2 - PATIO TABLE 80"x40" (ACCESSIBLE)
NOTES:
1. ALL FURNITURE IS PROVIDED BY OWNER'S VENDOR AND INSTALLED BY G.C.
2. ALL SEATING AND TABLES ARE NON-FIXED.

CONSULTING ENGINEER: _____
REVISIONS: _____

D.A.U.
David A. Udkow, Architect
11881 North 113th Way
Scottsdale, Arizona 85259
480.614.3385 fax / 480.514.0209

FITCH
Project Management
16435 North Scottsdale Road, Ste. 195
Scottsdale Arizona 85254
480.998.4200 fax / 480.998.7223

FEB 28 2008

BISTRO (PATIO) SEATING PLAN



DATE: 04/13/07 SHEET: A2.2
SCALE: 1/4\" = 1'-0\"
DRAWN BY: _____
PROJECT No.: PEI-06-036

NO. 10000000
SHEET NO. 0002 - OF 0004

#0182

GENERAL NOTE:
These drawings and specifications are copyrighted and subject to copyright protection as on "architectural work" under sec. 102 of the copyright act, 17 U.S.C. 41, amended December 1990. The protection includes, without limitation, the overall form, arrangement and composition of spaces, and elements of the design. Under such protection, unauthorized use of these drawings and specifications may result in cessation of construction, building seizure, and/or monetary liability.

BOULEVARD SHOPS
1206 WALTON BOULEVARD
ROCHESTER HILLS, MICHIGAN 48309



BISTRO (PATIO) SEATING
SITE PLAN

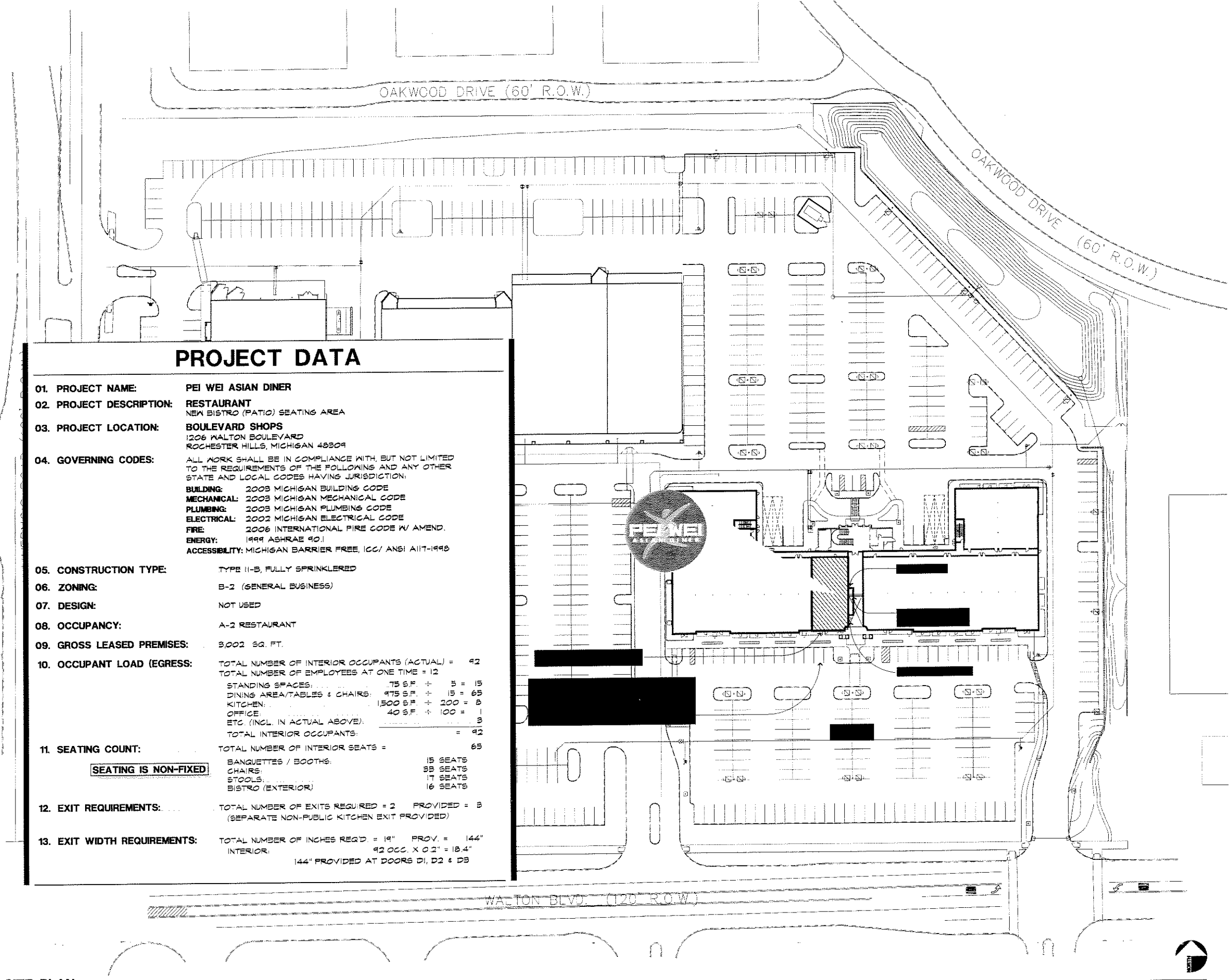

PROJECT DATA

- 01. PROJECT NAME: PEI WEI ASIAN DINER
- 02. PROJECT DESCRIPTION: RESTAURANT
NEW BISTRO (PATIO) SEATING AREA
- 03. PROJECT LOCATION: BOULEVARD SHOPS
1206 WALTON BOULEVARD
ROCHESTER HILLS, MICHIGAN 48309
- 04. GOVERNING CODES: ALL WORK SHALL BE IN COMPLIANCE WITH, BUT NOT LIMITED TO THE REQUIREMENTS OF THE FOLLOWING AND ANY OTHER STATE AND LOCAL CODES HAVING JURISDICTION:
BUILDING: 2003 MICHIGAN BUILDING CODE
MECHANICAL: 2003 MICHIGAN MECHANICAL CODE
PLUMBING: 2003 MICHIGAN PLUMBING CODE
ELECTRICAL: 2002 MICHIGAN ELECTRICAL CODE
FIRE: 2006 INTERNATIONAL FIRE CODE W/ AMEND.
ENERGY: 1999 ASHRAE 90.1
ACCESSIBILITY: MICHIGAN BARRIER FREE, ICC/ ANSI A117-1998
- 05. CONSTRUCTION TYPE: TYPE II-B, FULLY SPRINKLERED
- 06. ZONING: B-2 (GENERAL BUSINESS)
- 07. DESIGN: NOT USED
- 08. OCCUPANCY: A-2 RESTAURANT
- 09. GROSS LEASED PREMISES: 3,002 SQ. FT.
- 10. OCCUPANT LOAD (EGRESS):
TOTAL NUMBER OF INTERIOR OCCUPANTS (ACTUAL) = 42
TOTAL NUMBER OF EMPLOYEES AT ONE TIME = 12
STANDING SPACES: 75 S.F. + 5 = 15
DINING AREA/TABLES & CHAIRS: 975 S.F. + 15 = 65
KITCHEN: 1,500 S.F. + 200 = 8
OFFICE: 40 S.F. + 100 = 1
ETC. (INCL. IN ACTUAL ABOVE): = 3
TOTAL INTERIOR OCCUPANTS: = 42
- 11. SEATING COUNT:
SEATING IS NON-FIXED
TOTAL NUMBER OF INTERIOR SEATS = 65
BANQUETTES / BOOTHS: 15 SEATS
CHAIRS: 33 SEATS
STOOLS: 17 SEATS
BISTRO (EXTERIOR): 16 SEATS
- 12. EXIT REQUIREMENTS: TOTAL NUMBER OF EXITS REQUIRED = 2 PROVIDED = 3
(SEPARATE NON-PUBLIC KITCHEN EXIT PROVIDED)
- 13. EXIT WIDTH REQUIREMENTS: TOTAL NUMBER OF INCHES REQ'D = 19" PROV. = 144"
INTERIOR: 42,000 X 0.2" = 18.4"
144" PROVIDED AT DOORS D1, D2 & D3

CONSULTING ENGINEER
REVISORS

D.A.U.
David A. Udkow, Architect
11881 North 113th Way
Scottsdale, Arizona 85259
480.614.3385 fax/480.614.0209

FITCH
Project Management
16435 North Scottsdale Road, Ste. 195
Scottsdale, Arizona 85254
480.998.4200 fax/480.998.7223

PLANNING SUBMITTAL - 02/06/08

SITE PLAN



DATE: 04/15/07 SHEET:
SCALE: NO SCALE
DRAWN BY: JH
PROJECT No.: PEI-06-026

SP

DATE PLOTTED: 04/15/07 08:53AM