

REDWOOD ROCHESTER HILLS

E. AVON ROAD
ROCHESTER HILLS, MI 48307
OAKLAND COUNTY

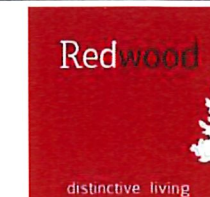

7510 E. PLEASANT VALLEY RD
INDEPENDENCE, OH 44131

B BERGMANN
ARCHITECTS ENGINEERS PLANNERS

Bergmann Associates, Architects, Engineers,
Landscape Architects & Surveyors, D.P.C.
7050 West Saginaw Hwy.
Suite 200
Lansing, MI 48917

office: 517.272.9835
fax: 517.272.9836

www.bergmannpc.com

DATE	DESCRIPTION
11/16/2018	PUD REVIEW
02/04/2019	REV. PER CITY COMMENTS
02/21/2019	2ND REV. PER CITY COMMENTS
05/02/2019	3RD REV. PER CITY COMMENTS
09/22/2019	4TH REV. PER CITY COMMENTS
09/23/2019	STEP ONE PUD REVIEW
12/23/2019	CITY RESUBMITTAL
01/17/2020	PERMIT REVIEW
03/02/2020	ENGINEERING RESUBMITTAL
05/06/2020	ENGINEERING RESUBMITTAL
05/06/2020	ENGINEERING RESUBMITTAL

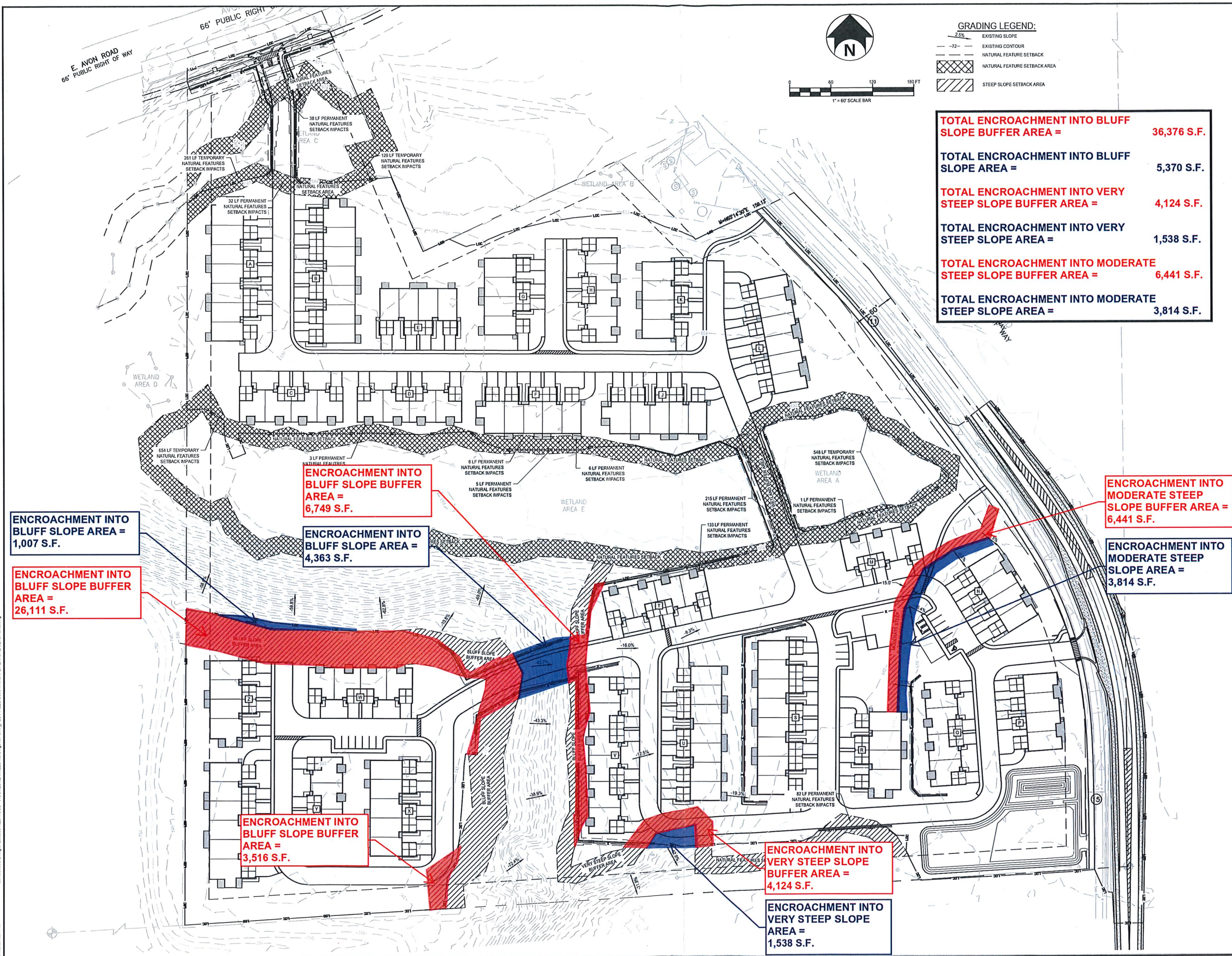

TOTAL ENCROACHMENT INTO BLUFF SLOPE BUFFER AREA =	36,376 S.F.
TOTAL ENCROACHMENT INTO BLUFF SLOPE AREA =	5,370 S.F.
TOTAL ENCROACHMENT INTO VERY STEEP SLOPE BUFFER AREA =	4,124 S.F.
TOTAL ENCROACHMENT INTO VERY STEEP SLOPE AREA =	1,538 S.F.
TOTAL ENCROACHMENT INTO MODERATE STEEP SLOPE BUFFER AREA =	6,441 S.F.
TOTAL ENCROACHMENT INTO MODERATE STEEP SLOPE AREA =	3,814 S.F.

ENCROACHMENT INTO BLUFF SLOPE BUFFER AREA = 1,007 S.F.

ENCROACHMENT INTO BLUFF SLOPE BUFFER AREA = 26,111 S.F.

ENCROACHMENT INTO BLUFF SLOPE BUFFER AREA = 6,749 S.F.

ENCROACHMENT INTO BLUFF SLOPE BUFFER AREA = 4,363 S.F.

ENCROACHMENT INTO BLUFF SLOPE BUFFER AREA = 3,516 S.F.

ENCROACHMENT INTO VERY STEEP SLOPE BUFFER AREA = 4,124 S.F.

ENCROACHMENT INTO VERY STEEP SLOPE AREA = 1,538 S.F.

ENCROACHMENT INTO MODERATE STEEP SLOPE BUFFER AREA = 6,441 S.F.

ENCROACHMENT INTO MODERATE STEEP SLOPE AREA = 3,814 S.F.

Not For Construction

Copyright © Bergmann Associates, Architects, Engineers,
Landscape Architects & Surveyors, D.P.C.

Prepared By: P. FURTAW, PE	Checked By: P. FURTAW, PE
Designed By: I. GRAHAM, PE	Drawn By: I. GRAHAM, PE
Date Issued: NOVEMBER 9, 2018	Project Number: 12963.00

NATURAL FEATURE SETBACKS

C601

CITY FILE #18-022 SECTION 13

D:\Redwood Living\12963.00 REDWOOD - ROCHESTER HILLS\4.0 Dwg\4.1 Civil_PLOT FILES\C601 NATURAL FEATURE SETBACKS.dwg
09/20/20 3:24 PM