

## STANDARD AGREEMENT FOR MUNICIPAL STREET LIGHTING

DTE Internal Work Order/IO Number 34507968

This Standard Agreement For Municipal Street Lighting ("Agreement") is between The Detroit Edison Company ("Company") and City of Rochester Hills ("Customer"). Customer requests the Company to furnish, install, operate and maintain street lighting equipment in the municipality set forth on Exhibit A attached hereto at the specific location set forth on Exhibit A (the "Location") and the Company agrees to do so in accordance with the terms set forth in this Agreement.

Therefore, in consideration of the mutual promises set forth in this Agreement, and for other good and valuable consideration, the receipt and adequacy of which is hereby acknowledged, Company and Customer each hereby agree as follows:

1. Description of Equipment

Subject to and in accordance with the terms of this Agreement, the Company will undertake activities to install the street lighting equipment set forth on Exhibit A attached hereto (the "Equipment").

2. Rules Governing Installation of Equipment and Electric Service

Installation of street light facilities and the extension of electric service to serve those facilities are subject to the provisions of The Michigan Public Service Commission (MPSC) Rules Governing Services Supplied by Electric Utilities, Rule B-3.3, Extension of Service.

3. Contribution in Aid of Construction

In accordance with the applicable Orders of the MPSC, Customer shall pay to Company a contribution in aid of construction ("CIAC") for the installation of the Equipment and the recovery of costs associated with the removal of existing equipment, if any. The amount of the CIAC (the "CIAC Amount") shall be an amount equal to the total construction cost (including all labor, materials and overhead charges), less an amount equal to three years revenue expected from such new equipment. The CIAC Amount is as set forth on Exhibit A attached hereto. The CIAC Amount does not include charges for any additional cost or expense for unforeseen underground objects not identified by Miss Dig, or unusual conditions encountered in the construction and installation of the Equipment. If Company encounters any such unforeseen or unusual conditions, which would increase the CIAC Amount, it will suspend the construction and installation of the Equipment and give notice of such conditions to the Customer. The Customer will either pay additional costs or modify the work to be performed. If the work is modified, the CIAC Amount will be adjusted to account for such modification. Upon any such suspension and/or subsequent modification of the work, the schedule for completion of the work shall also be appropriately modified.

4. Payment of CIAC Amount

Customer shall pay to Company the CIAC Amount set forth on Exhibit A promptly upon execution of this Agreement. Failure to pay such amount at such time shall relieve Company of its obligations to perform the construction work required herein until such amount is paid.

5. Modifications

Subject to written permission of the respective municipality, after installation of the Equipment, any cost for additional modifications, relocations or removals will be the responsibility of the requesting party.

6. Maintenance and Replacement Equipment

In accordance with the applicable Orders of the MPSC, under the Municipal Street Lighting Rate (as defined below), Company shall provide the necessary maintenance of the Equipment, including such replacement material and equipment as may be necessary.

7. Street Lighting Service Rate

Upon the installation of the Equipment, the Company will provide street lighting service to Customer under Option 1 of the Municipal Street Lighting Rate, as approved by the MPSC.

This street lighting service is also governed by Rules for Electrical Service established by the MPSC (MPSC Case Number U-6400). The Street Lighting Rate is subject to change from time to time by orders issued by the MPSC. The Municipal Street Lighting Rate as of the date of this Agreement is hereby incorporated by reference into this Agreement.

8. Contract Term

The initial term of this Agreement shall begin on the date that billing for the street light service begins, and shall continue for five years thereafter. Upon the expiration of the initial term of this Agreement, the term of this Agreement shall continue on a month-to-month basis thereafter until terminated by mutual written consent or twelve months written notice by either party, which written notice may be given at any time.

9. Design Responsibility for Street Light Installation

The Company installs municipal street lighting installations following Illuminating Engineering Society of North America ("IESNA") recommended practices. If the Customer submits its own street lighting design for the street light installation (as shown on Exhibit A), or if the street lighting installation requested by Customer on Exhibit A does not meet the IESNA recommended practices (as shown on Exhibit A), Customer acknowledges the Company is not responsible for lighting design standards.

10. New Subdivisions

Company agrees to install street lights in new subdivisions when subdivision occupancy reaches a minimum of 80%. If Customer wishes to have installation occur prior to 80% occupancy, then Customer acknowledges it will be financially responsible for all damages (knockdowns, etc.) and requests for modifications (movements due to modified curb cuts from original design, etc.).

11. Force Majeure

The obligation of Company to perform this Agreement shall be suspended or excused to the extent such performance is prevented or delayed because of acts beyond Company's reasonable control, including without limitation acts of God, fires, adverse weather conditions (including severe storms and blizzards), malicious mischief, strikes and other labor disturbances, compliance with any directives of any government authority, including but not limited to obtaining permits, and force majeure events affecting suppliers or subcontractors.

12. Subcontractors

Company may sub-contract in whole or in part its obligations under this Agreement to install the Equipment and Replacement Equipment.

13. Waiver; Limitation of Liability

To the maximum extent allowed by law, Customer hereby waives, releases and fully discharges Company from and against any and all claims, causes of action, rights, liabilities or damages whatsoever, including attorneys fees, arising out of the installation of the Equipment and/or any Replacement Equipment, including claims for bodily injury or death and property damage, unless such matter is caused by or arises as a result of the sole negligence of Company and/or its subcontractors. Company shall not be liable under this Agreement for any special, incidental or consequential damages, including loss of business or profits, whether based upon breach of warranty, breach of contract, negligence, strict liability, tort or any other legal theory, and whether or not Company has been advised of the possibility of such damages. In no event will Company's liability to Customer for any and all claims related to or arising out of this Agreement exceed the CIAC Amount.

14. Notices

All notices required by the Agreement shall be in writing. Such notices shall be sent to Company at The Detroit Edison Company, Community Lighting Group, 2000 Second Ave., Room 440 SB, Detroit, MI 48226 and to Customer at the address set forth on Exhibit A attached hereto. Notice shall be deemed given hereunder upon personal delivery to the addresses set forth above or, if properly addressed, on the date sent by certified mail, return receipt requested, or the date such notice is placed in the custody of a nationally recognized overnight delivery service. A party may change its address for notices by giving notice of such change of address in the manner set forth herein.

15. Representations and Warranties

Company and Customer each represent and warrant that: (a) it has full corporate or public, as applicable, power and authority to execute and deliver this Agreement and to carry out the actions required of it by this Agreement; (b) the execution and delivery of this Agreement and the transactions contemplated hereby have been duly and validly authorized by all necessary corporate or public, as applicable, action required on the part of such party; and (c) this Agreement constitutes a legal, valid, and binding agreement of such party.

16. Miscellaneous

(a) This Agreement is the entire agreement of the parties concerning the subject matter hereof and supersedes all prior agreements and understandings.

(b) No party other than Company and Customer, and their respective successors and assigns, shall have any rights to enforce or rely upon this Agreement, which is binding upon and made solely for the benefit of Company and Customer, and their respective successors, and assigns, and not for the benefit of any other party.

(c) Failure of either party to complain of any act or omission on the part of the other party, no matter how long the same may continue, shall not be deemed to be a waiver by such party of any of its rights hereunder. No waiver by any party at any time, expressed or implied, of any breach of any provision of this Agreement shall be deemed a waiver or a breach of any other provision of this Agreement or a consent to any subsequent breach of the same or any other provision.

(d) The captions and section numbers appearing in this Agreement are inserted only as a matter of convenience, and do not define, limit, construe or describe the scope or intent of such sections or articles of this Agreement nor in any way affect this Agreement.

(e) This Agreement, and the rights, obligations and liabilities of the parties hereto shall be construed in accordance with the law of the State of Michigan, without regard to its conflict of law principles. The parties agree that any action with respect to this Agreement shall be brought in a court of competent subject matter jurisdiction located in the State of Michigan and the parties hereby submit themselves to the exclusive jurisdiction and venue of such court for the purpose of such action.

(f) This Agreement may be executed in one or more counterparts, each of which shall be deemed an original but all of which together will constitute one and the same instrument.

(g) If any term or provision of this Agreement is held to be invalid or unenforceable in any situation in any jurisdiction, it shall not affect the validity or enforceability of the remaining terms and provisions hereof or the validity or enforceability of the offending term or provision in any other situation or in any other jurisdiction.

THE DETROIT EDISON COMPANY

CITY OF ROCHESTER HILLS

By \_\_\_\_\_

By \_\_\_\_\_

Printed Name: \_\_\_\_\_

Printed Name: \_\_\_\_\_

Its \_\_\_\_\_

Its \_\_\_\_\_

Date \_\_\_\_\_

Date \_\_\_\_\_

**EXHIBIT A**

Note: The usage of the notation "N/A" in any of the boxes below means that such matter is not applicable to the transactions contemplated by this Agreement and all sections of this Agreement relating to such matter shall be deemed to have no force and effect (but all other sections of this Agreement, shall otherwise remain in full force and effect).

Municipality where Equipment will be installed		City of Rochester Hills	
Specific Location where Equipment will be installed	Manchester Knolls – as per Exhibit B attached WO # 34515541 which is made part of this agreement.		
Description of Equipment to be installed	Installation of three (3) "acorn" style fixtures with 100 watt high pressure sodium lamp source mounted on 11'6" Mainstreet post and as per street lighting facilities in accordance with Exhibit B WO # 34515541 which is made part of this agreement.		
Computation of Street Lighting Contribution In Aid of Construction CIAC Amount	Total Estimated Construction Cost, including labor, materials, and overhead		\$ 18,015.94
	Lamp Charges for 3 yrs		\$ 3,130.98
	Contribution ( Cost minus 3 yrs revenue)		\$ 14,884.95
	Total Annual Lamp Charges		\$ 1,043.66
Box 1 Is this a Company designed installation? (check "Yes" or "No")	YES <input type="checkbox"/> (if checked please complete Box: 2 3 4)      NO <input type="checkbox"/> (if checked please complete Box: 5 6)		
Box 2 If Box 1 is checked please select the appropriate Roadway Classification	<input type="checkbox"/>	<input type="checkbox"/> Expressway <input type="checkbox"/> Collector	<input type="checkbox"/> Major <input type="checkbox"/> Local
Box 3 If Box 1 is checked please select the appropriate Pedestrian Conflict Classification	<input type="checkbox"/> High	<input type="checkbox"/> Medium	<input type="checkbox"/> Low
Box 4 If Box 1 is checked please select the appropriate Pavement Classification	<input type="checkbox"/> R1	<input type="checkbox"/> R2 & R3	<input type="checkbox"/> R4
Box 5 Does the Customer lighting design requested meet IESNA recommended practices? (check "Yes" or "No")	YES <input type="checkbox"/>	NO <input type="checkbox"/> (if checked please complete Box: 6)	
Box 6 If the Customer lighting design does not meet IESNA recommended practices, the Customer must sign the block to the right.	_____ (Customer signature indicating acknowledgement the lighting design does not meet IESNA recommended practices)		
Box 7 New Residential Subdivision?	YES <input type="checkbox"/>	(if checked please complete Box: 8)	NO <input type="checkbox"/>
Box 8 If Box 7 is checked Yes, and customer authorizes installation prior to 80% occupancy, Customer signature required	_____ (Customer acknowledgement that lighting is being installed prior to 80% occupancy)		
Customer Address for Notices			

# EXHIBIT "B"

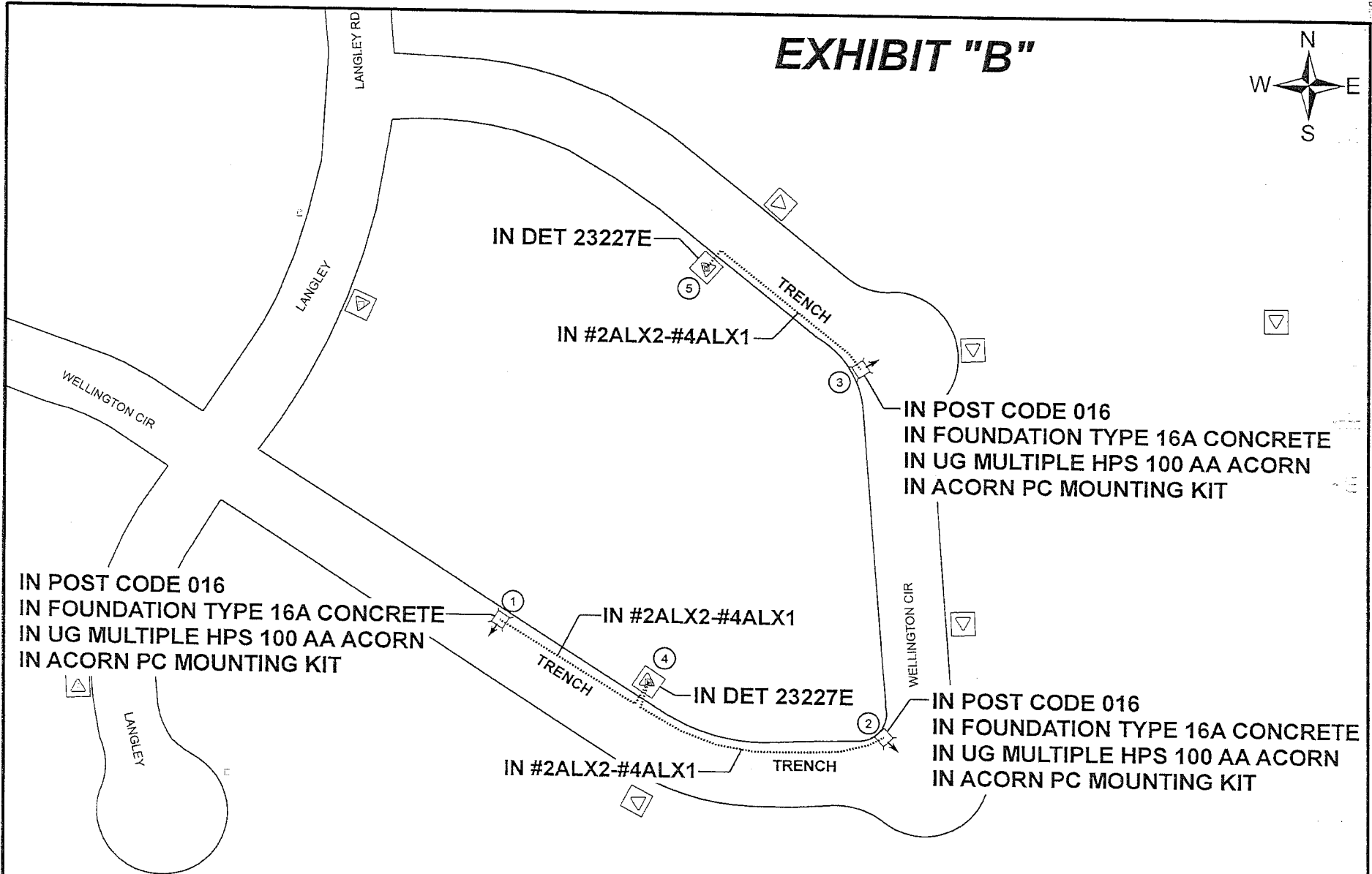
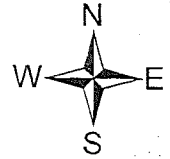

**DTE Energy**



*Detroit Edison*

Work Order # 34515541		Work Order Description CWO-SL-City of Rochester Hls-UG-Manchester Knolls Sub-IN-3				GIS-DSN	SRW	PH	PLC	
Service Center		Circuit #1	Circuit #2		COH	CCS	CUG	CUL	CUS	
Worksite City CITY OF ROCHESTER HILLS					Worksite Twp. Worksite County					
Town	Range	Section	Qtr	Planner Name Wincel, Thomas J		Plot Date	CUE Request # 281059	Version 1	Scale	Target Finish Date

# Manchester Knolls II Street Light Request

## Section # 8

5/10/20121

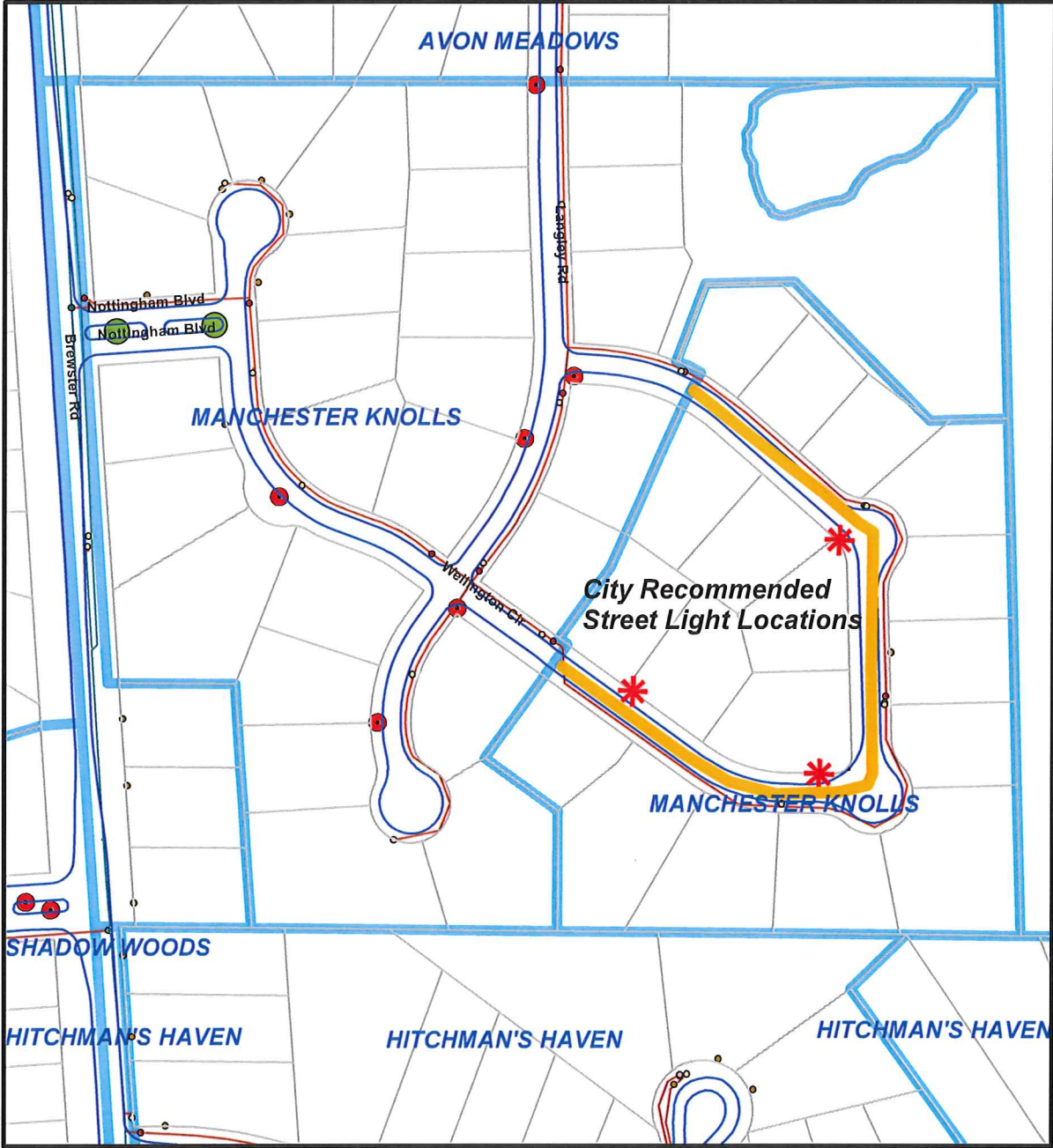

**Legend**

- RoadEdge
- street\_lights**
  - <all other values>
- GenJurisdi**
  - City Paid
  - Other Public Agencies
  - Private
  - Subdivision Paid - Dual Light
  - Subdivision Paid - Single Light
- ▭ Subdivisions

