

CITY OF ROCHESTER HILLS



Jane Leslie, Clerk

2461

DATE: 3/14/07

TO: Liquor Tech. Rev. Committee

RE: Stock Transfer

The Clerk's Office has received a Local Approval Notice from Michigan Liquor Control Commission for the transfer of all stock in 2006 Class C licensed business located at 1366-1368 Walton Blvd.

The new stockholders are Yong S. Tingley and Chang H. Song. They have submitted their application and paid the application fee. Enclosed are the following:

- Class C Application
- TAM Certification for Yong S. Tingley (Techniques of Alcohol Management)
- Floor Plan
- Menu
- Cash Receipt for Application Fee
- Excerpt from Lease Agreement
- MLCC Local Approval Notice
- Sample resolution for the Committee's recommendation to City Council.
- Financial information

The application also includes fingerprints that will remain on file in the Clerk's Office as well as a copy of all paperwork submitted to MLCC pertaining to the application for the transfer. MLCC has conducted their investigation and has found the application acceptable to forward the Local Approval Notice. There are no plans for remodeling and they passed the Annual Liquor Inspection on November 30, 2006 that was conducted by Building Department.

CITY OF ROCHESTER HILLS
CLASS C LIQUOR LICENSE APPLICATION

APPLICANT'S CHECK LIST FOR SUBMISSION

- Completed Application
- Listing of Corporation/Partners
- Building/Site Plans
- Financial Statement
- Lease Agreement (if applicable)
- Menu
- Training Policy
- Fingerprints
- N/A Dance/Entertainment Agreement (if applicable)

TAKE SUSHI 3/14/07

CITY OF ROCHESTER HILLS

CLASS C LIQUOR LICENSE APPLICATION

Date: 2-5-2007

New Class C License
 Transfer Class C License
 Dance Permit
 Entertainment Permit
 Dance Entertainment Permit

Applicant's Name: Take Sushi, Inc/stockholder Yong Tingley Phone No. 248-880-8585
Address: 6803 Edgewater City Troy ST MI
Age: 47 Citizenship: United States Date of Birth 5-4-1959 Birthplace: South Korea
If naturalized, year and place: 2005, Troy Michigan

If a partnership, please complete the following:

Partner's Name: Chang-Hun Song Phone No. 248-561-4466
Address: 6795 Edgewater Dr City Troy ST MI
Age: 37 Citizenship: Korean Date of Birth 3-11-1969 Birthplace: South Korea
If naturalized, year and place: Permanent resident visa

Manager's Name: both are managers Phone No. _____
Address: _____ City _____ ST _____
Age: _____ Date of Birth: _____

If a corporation, the names, addresses of the officers and directors, date of birth and age of each:

Yong Suk Tingley, 6803 Edgewater, Troy, MI 48085-President and Treasurer

Chang Hun Song, 6795 Edgewater, Troy, MI 48085-Vice President and Secretary

Page 2
Liquor License Application

Location of Proposed License: 1366-1368 Walton, Rochester Hills

Does applicant presently own the premises? no

If not, name of owner of premise: Remy & Associates, LLC

Legal Description of Property (Sidwell #) _____

Length of time business has been in operation: Take Sushi has been operating for approximately 10 years

Has applicant ever been convicted of a felony? Yes ___ No

If convicted of felony, explain: _____

Has applicant previously applied for liquor license? Year requested: NO

Location of business: _____

Was liquor license granted: _____

Have any of the applicants or persons listed above been convicted of a violation of federal or state law concerning the manufacture, possession or sale of alcoholic beverages? Yes ___ No

Name of person _____

What is the applicant's current business? Managers at Take Sushi

Length of time in named business? both at Take Sushi since July 2005

List all uses in addition to sale of alcoholic beverages: Sushi restaurant

Does applicant presently operate a restaurant? Yes No _____

Name and address of restaurant: Managers at Take Sushi.

Does applicant presently hold a Class C liquor license? Yes ___ No

Name and address of restaurant: _____

List record and history of any liquor license violations by the applicant for preceding ten (10) years
None

Record history of any liquor license violations by the corporation or by a parent of subsidiary corporation of the applicant for the immediate preceding ten (10) years
November 2001, sale to a minor, paid a \$400 fine.

| <u>Proposed Liquor Establishment:</u> | <u>Existing Building</u> | <u>New Construction</u> |
|--|----------------------------------|-------------------------|
| Size of Site: | _____ | _____ |
| Size of Building: | 1,560 sq feet | _____ |
| Size of Kitchen: | _____ | _____ |
| Seating Capacity: | 49 | _____ |
| Size of Dance Floor, if any: | none | _____ |
| Percentage of Floor Area for Dining: | _____ | _____ |
| Percentage of Floor Area for Bar: | no bar | _____ |
| Present Zoning: | _____ | _____ |
| Required Zoning: | _____ | _____ |
| Cost of Remodeling: | none | _____ |
| Cost of Construction: | none | _____ |
| Estimated Dates of Construction | Start: _____ | Completion: _____ |
| Total cost to be expended by licensee for the licensed premises: _____ | | |
| Building Plans Submitted – 3 Sets Required: | Number of Copies Enclosed: _____ | |
| Site Plans Submitted – 6 Sets Required: | Number of Copies Enclosed: _____ | |
| Do Site Plans show off-street parking and lighting? | Yes _____ | No _____ |



NOTE: Take Sushi is an existing business. This is only a change of the ownership of the licensed entity. No Changes to the business or the licensed premises.

Page 4
Liquor License Application

Describe the proposed character/type of establishment (e.g. theme, entertainment, food)

Take Sushi is a full service Sushi restaurant. There is not a stand up bar in the establishment, only a sushi bar where customers can sit and dine and watch the sushi chef prepare the food.

Describe the proposed full food menu:

Take Sushi has been operating since 1997 as a sushi restaurant. Attached is the menu that is currently used at the establishment. The menu will not change with the change of ownership.

Proposed menu attached: Yes No

Describe the surrounding neighborhood and explain how the proposed establishment fits this location in Rochester Hills.

The restaurant is located in a strip mall on Walton Blvd between Livernois and Rochdale Roads. Also in the complex is Gordon Foods, Rite Aid, Whole foods, Bruegger's Bagels, and Greek Island Coney Island. It is located next to Pizza Hut, Wendy's and Sero's restaurant. Take Sushi adds a different option for dining and offers, take out and sit down dining.

Revenues: Provide a breakdown of the anticipated revenues from food, alcoholic beverages and other revenues (copy must be attached): _____

Evidence of Financial Responsibility:

Amount of Funds supplied by Principals: Purchasing stock for \$139,317, with \$14,000 down payment.

Amount of Funds to be Financed: Balance of the funds will be on a promissory note.

Name of Financer/Phone Number: _____

Liquor License Application

Personal References/Phone Number:

see attached list

Business References/Phone Number:

see attached list

Has applicant completed a certified training program? Yes ___ No xx **Will attend after licensed.**

Have employees completed a certified training program? Yes ___ No xx
Names and addresses of those completing program

All management staff will be trained.

Applicant understands that should any of the above information prove to be inaccurate or untruthful, it will be grounds to deny applicant's request or revoke any approvals.

I (We) Yong Tingley and Chang Song

affirm I (We) will not violate any of the laws of the State of Michigan or of the United States or any ordinances of the City of Rochester Hills in the conduct of my (our) business, and acknowledge receipt of a copy of Chapter 6, Alcoholic Liquor of the Rochester Hills Code of Ordinances.

I hereby certify the above information to be true and accurate to the best of my (our) knowledge.

Yong Tingley
Applicant Signature/Date

Chang Song
Applicant Signature/Date

This application is not considered complete until applicant has made contact with the Rochester Hills Contingent of the Oakland County Sheriff's Department and complied with fingerprinting and any other necessary requirements of the Oakland County Sheriff's Department.



Techniques of Alcohol Management®
P.O. Box 4067, E. Lansing, MI 48826-4067
800/292-2896

TAM® CERTIFICATION CARD

Yong S Tingley
TAM CARD - Card #9327 DOB: 05/04/1959
TAKE SUSHI
6803 Edgewater Dr.
Troy, MI 48085
Effective: 01/23/2007-01/23/2010
On Site by Marcy O'Brien
© 1983-2005 Michigan Licensed Beverage Association®

YONG Suk Tingley

BUSINESS

1. Tokyo Sushi & Seoul B.B.Q Restaurant

Buss: 586-997-9582

Cell 248-765-7772 } → Susie Choi (name)

2. Brothers Distributor inc

14410 Meyers rd

Detroit, Mi 48227

Buss: 313 - 333 - 8999

Cell: 248 - 505 - 3482 } Ted Chung (name)

3. Siro Restaurant name: Shin Jae Woong

43180 9 mile

Novie, Mi 48375

Buss: 248-348-1212

cell: 248-787-4466

1. Kyeong Black, Home: 248-650-366

2. Chin A Freund Cell: 248-321-3787

3. Jae Jung Davey: Cell

Chang Hun Song

Business

1. Sushi Samurai

NAME Dong Jang

work 248 - 737 - 4408

cell 248 - 935 - 0958

2. W.F. Bibimbab Restaurant

~~cell~~, 248 - 974 - 7481

office. 248 - 348 - 6800

3. Jim & Top Desines

Mike Song

248 390 - 3134

1. Hwa Ja putsy

Home. 248 - 373 - 1596

cell, 248 - 467 - 4071

2. Yoon Myong sun

cell 248 - 470 - 5477

3. Oh. Young - Ju

cell 248 - 390 - 3432

70'-11"

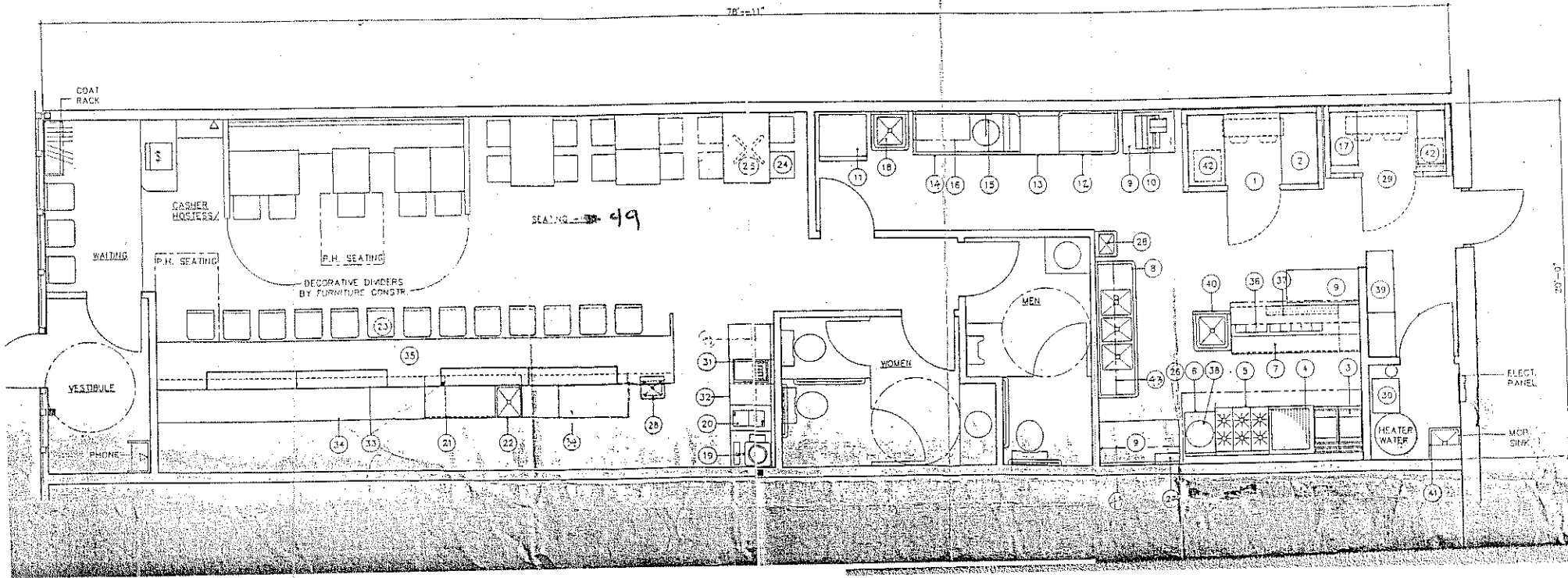

70'-9"

SEATING ~~48~~ 49

CASHIER HOSTESS/

WAITING

P.H. SEATING

P.H. SEATING

DECORATIVE DIVIDERS BY FURNITURE CONSTR.

PHONE BOOTH

WOMEN

MEN

HEATER WATER

ELECT. PANEL

MOP. SINK

Roll Combination

*Raw

- *No. 1 Roll Combo *Tuna, california and east rolll* ----- \$15.00
- *No. 2 Roll Combo *Crunch, california and spicy tuna roll* ----- \$18.95
- *No. 3 Roll Combo *Dragon, tuna, and alaskan roll* ----- \$18.95

Entree

*Raw

Served with rice

- 1. **Beef Teriyaki** *BBQ N.Y. stripe steak w/ teriyaki sauce* ----- \$15.00
- 2. **Salmon Teriyaki** ----- \$14.00
Fresh salmon, broiled and basted w/ teriyaki sauce
- 3. **Chicken Teriyaki** ----- \$11.50
Sauteed boneless chicken breast w/ teriyaki sauce
- 4. **Chicken Roll Katsu** ----- \$12.50
Deep fried breaded chicken breast stuffed w/ ground shrimp, onion and green peppers
- 5. **Chicken Katsu** ----- \$11.50
Deep fried breaded chicken cutlet served w/ delicious cutlet sauce
- 6. **Don Katsu** ----- \$11.50
Deep breaded pork cutlet served w/ delicious cutlet sauce
- 7. **Ebi Tempura** ----- \$14.50
Jumbo shrimp, lightly fried served w/ tempura sauce
- 8. **Tempura** ----- \$13.00
Shrimp and vegetable, lightly fried served w/ tempura sauce
- 9. **Vegetable Tempura** ----- \$ 9.00
Vegetable, lightly fried served w/ tempura sauce
- 10. **Negima** ----- \$13.50
Scallions rolled cheese w/ sliced beef broiled in teriyaki sauce
- 11. **Chicken Don** ----- \$ 9.95
Chicken, onion, kamaboko mushroom, green onion w/ sweet soy sauce on rice
- 12. **Katsu Don** ----- \$11.95
Pork cutlet, onion, kamaboko mushroom, egg w/ sauce on rice
- 13. **Unagi Don** *Broiled fresh water eel w/ smoked rice* ----- \$21.95
- *14. **Hwe Dup Bob** ----- ~~\$16.95~~
Vegetables and sashimi on the top of rice with special spicy sauce

Noodle

- 1. **Nabe Yaki Udon** ----- \$ 9.00
Thick noodle soup w/ shrimp tempura, egg and other delicacies
- 2. **Tempura Udon** *Thick noodle soup w/ shrimp tempura* ----- \$ 8.00
- 3. **Tempura Soba** *Buckwheat noodle soup w/ shrimp tempura* ----- \$ 8.00

'Soba' made of buckwheat flour. Soba is known for its contribution to good health; it lowers high blood pressure and is high in vitamins.

The Taste of Japan TAKE SUSHI

Carry Out Menu

Tel. 248.652.7800
Fax. 248.652.4602

Rochester Hills Plaza
1366 Walton Blvd.
Rochester Hills, MI 48309

Business Hours

MON-THUR 11:00AM-10:00PM
FRI 11:00AM-10:30PM
SAT 12:00PM-10:30PM
SUN 3:00PM- 9:00PM

NIGIRI SUSHI

| No. | Item | Price | Order (1pc) |
|------|--------------------------|-------|-------------|
| △ 1 | Egg (Tamago) | 1.50 | |
| ★ 2 | Flying fish roe (masago) | 2.00 | |
| ★ 3 | Mackerel (Saba) | 1.75 | |
| △ 4 | Surf Clam (Hokigai) | 2.00 | |
| △ 5 | Octopus (Tako) | 2.00 | |
| △ 6 | B.B.Q. Eel (Unagi) | 2.50 | |
| ★ 7 | Squid (Ika) | 2.00 | |
| ★ 8 | Salmon (Sake) | 2.00 | |
| ★ 9 | Salmon Roe (ikura) | 3.00 | |
| △ 10 | Shrimp (Ebi) | 2.00 | |
| ★ 11 | Tuna (maguro) | 2.50 | |
| ★ 12 | Yellowtail (hamachi) | 2.50 | |
| △ 13 | Sea Eel (Anago) | 2.50 | |
| △ 14 | Conch | 2.00 | |
| ★ 15 | Fresh Sea Urchin (Uni) | 3.50 | |
| ★ 16 | White Fish | 2.25 | |
| | Crab meat (Imitation) | 1.75 | |

★ Raw △ Cooked

★ Sushi may be served raw. Consuming raw fish and seafood may increase your risk of obtaining a food borne illness: especially if you have certain medical conditions.

Taste of Japan Take Sushi

Tel:248-652-7800, Fax:248-652-4602

Business hour: Mon ~ Fri. 11:30am ~ 10:00pm

Sat. Noon ~ 10:00pm

Sun. 3:00pm ~ 9:30pm

ROLL ALA CARTE

| No. | Item | Price | Order(cut 6pc) |
|------|-----------------------|-------|----------------|
| △ 1 | Cucumber Roll | 3.00 | |
| △ 2 | Oshinko(Pickle)Roll | 3.00 | |
| △ 3 | Ume Shiso Roll | 3.00 | |
| △ 4 | Kampyo(Dried Squash) | 3.00 | |
| △ 5 | Asparagus Roll | 3.00 | |
| △ 6 | California Roll | 4.50 | |
| △ 7 | Eel & Cucumber Roll | 5.00 | |
| ★ 8 | Spicy Tuna Roll | 5.00 | |
| ★ 9 | Tuna Roll | 4.00 | |
| △ 10 | Futomaki 1/2(4pc) | 5.00 | |
| ★ 11 | Negi Hama(Yellowtail) | 4.50 | |
| ★ 12 | Alaskan (salmon) Roll | 4.00 | |
| △ 13 | Boston Roll | 4.50 | |

Lunch Sushi Special

- ★ 1 NO1. SUSHI LUNCH \$9.95
(1 ROLL & 6Pc of sushi)
- ★ 2 NO2. SUSHI LUNCH \$10.95
(1/2 American Dream w/2pc tuna 3pc salmon)
- ★ 3 NO3. SUSHI LUNCH \$10.95
(1/2K-Roll w/2pc shrimp 3pc tuna)
- ★ 4 **회덮밥**(spicy sashimi salad w/rice) \$9.95
- ★ 5 SASHIMI LUNCH \$11.95
(3pc tuna,2pc salmon 2pc white fish)
- ★ 6 ROLL COMBINATION \$9.95
(California Roll,tuna,cucumber Roll)
- ★ 7 CHIRASHI SUSHI \$11.50
(Assorted Fresh Fish on Rice)
- ★ 8 TEKKA DON \$11.95
(Fresh Tuna on Sushi Rice)

| Quantity | | RAW MAKI ROLLS | price |
|----------|---|-----------------------|-------|
| 1 | Tuna Roll * | | 4.50 |
| 2 | Salmon Roll * | | 4.50 |
| 3 | Spicy Crunch Salmon Roll* <i>Salmon, Cucumber, Crunch bit w/sp sauce</i> | | 5.00 |
| 4 | Spicy Scallop Roll* <i>Scallop w/sp sauce</i> | | 5.50 |
| 5 | Spicy Tuna Roll* | | 5.00 |
| 6 | Alaskan Roll * <i>Salmon, Avocado, Cucumber</i> | | 5.00 |
| 7 | Tuna Avocado Roll * <i>Tuna, and Avocado</i> | | 5.00 |
| 8 | Salmon Avocado Roll * <i>Salmon, and Avocado</i> | | 5.00 |
| 9 | Pilla Roll * <i>Salmon, and Avocado w/cream cheese</i> | | 5.50 |
| 10 | Negi Hama * <i>Yellow Tail and Scallion</i> | | 5.00 |
| 11 | Negi Toro * <i>Toro and Scallion</i> | | 8.00 |
| 12 | Sunny California Roll * <i>California w/spicy tuna on top</i> | | 7.50 |
| 13 | Salmon Tsutsumi * <i>Avocado, Cucumber, Asparagus, Crab meat, masago w/salmon on top(4pc)</i> | | 9.95 |
| 14 | Salmon Fashion * <i>Salmon, Lettuce, Cucumber, Asparagus, and Avocado</i> | | 9.95 |
| 15 | Michigan Roll * <i>Tuna, Salmon, Yellow Tail, Avocado, Cucumber w/sp sauce</i> | | 11.95 |
| 16 | Wasabi Yam Yam * <i>Salmon, Tuna, Avocado, Cream Cheese, Wasabi Masago deep fried (4pc)</i> | | 9.95 |
| 17 | Rainbow Roll * <i>California Roll w/Tuna, Salmon, Flake on top</i> | | 11.95 |
| 18 | Jello Shot Roll* <i>Salmon, Avocado, Cucumber, Cream Cheese w/Masago, Scallion, dried tuna flake on top(4pc)</i> | | 8.95 |
| 19 | Dynamite Roll * <i>Spicy Scallop, Crab Meat, Cucumber w/Wasabi Masago on top</i> | | 8.50 |
| 20 | Luxury Roll * <i>Soy bean paper w/sp tuna, cheese, shrimp, avocado, cucumber w/ gold flake, red tobiko on top</i> | | 13.95 |
| 21 | Ninja Roll * <i>White Tuna, Tuna, Avocado, Crab Meat, Masago (4pc)</i> | | 8.95 |
| 22 | Shrek Roll * <i>Ebi Tempura, Crab Meat, Oshinko w/crunch bit</i> | | 9.95 |

* Consuming raw fish and uncooked seafood may increase your risk of food-borne illness.

| Quantity | | COOKED MAKI ROLLS | price |
|----------|---|--------------------------|-------|
| 1 | Eel Avocado Roll <i>Eel and Avocado</i> | | 5.50 |
| 2 | Eel Cucumber Roll <i>Eel and Cucumber</i> | | 5.50 |
| 3 | Green River Roll <i>Eel, Avocado, Cucumber w/sea weed flakes</i> | | 5.50 |
| 4 | Salmon Skin Roll <i>Salmon Skin and Cucumber</i> | | 5.00 |
| 5 | California Roll <i>Crab Meat, Avocado and Cucumber</i> | | 5.00 |
| 6 | East Roll <i>Shrimp, egg and Cucumber w/masago on the outside</i> | | 5.00 |
| 7 | Boston Roll <i>Shrimp, Lettuce, and Cucumber</i> | | 5.00 |
| 8 | American Dream Roll <i>Ebi Tempura, egg, Avocado, Crab Meat w/masago on the outside</i> | | 9.95 |
| 9 | Tiger American Dream Roll <i>American Dream Roll w/wasabi masago and sp sauce on top</i> | | 9.95 |
| 10 | Spider Roll <i>Soft Shell Crab, Crab Meat, Avocado, Cucumber w/masago</i> | | 9.95 |
| 11 | Tiger Spider Roll <i>Spider Roll w/wasabi masago, sp sauce on top</i> | | 9.95 |
| 12 | Crunch Roll <i>Ebi Tempura, Crab Meat and Avocado w/crunch bit, masago and sauce on the outside</i> | | 9.95 |
| 13 | Eel Fashion Roll <i>Eel, Lettuce, Cucumber, Avocado and Asparagus</i> | | 9.95 |
| 14 | Shrimp Fashion Roll <i>Shrimp, Lettuce, Cucumber, Avocado and Asparagus</i> | | 9.95 |
| 15 | Futo Maki <i>Seasoned Squash, Egg, Crab Meat, Oshinko, Cucumber and Masago</i> | | 9.95 |
| 16 | Salmon Tempura Roll <i>Salmon Tempura, Avocado and Cucumber w/cream cheese (4pc)</i> | | 7.95 |
| 17 | King Crab Roll <i>Real Alaskan King Crab, Avocado and Cucumber w/masago</i> | | 9.95 |
| 18 | Lobster Salad Roll <i>Seasoned Lobster meat, Avocado and Cucumber(4pc)</i> | | 8.95 |
| 19 | Dragon Roll <i>Eel, Cucumber and Ebi Tempura w/avocado on top</i> | | 11.95 |
| 20 | Ninja Turtle <i>Lobster Meat, Crab Meat, Avocado, Cucumber, Cream Cheese and Wasabi Masago w/wasabi tobiko on top</i> | | 11.95 |
| 21 | Catapilla Roll <i>Eel, Cucumber w/avocado on top</i> | | 8.95 |
| 22 | Tears Roll <i>Shrimp, Wasabi, Masago, Avocado, Cucumber and Cream Cheese w/sp sauce</i> | | 8.95 |

AMENDMENT TO LEASE

BY AND BETWEEN
Remy & Associates, L.L.C.
And
Take Sushi, Inc

Notwithstanding anything to the contrary of the Lease by and between Remy & Associates, L.L.C., and Take Sushi, Inc. dated July 11, 1995 the following shall be amended:

Effective July 1, 2005 the option to extend the term of your lease will be in effect as follows:

07/01/05- 06/30/10 \$20.50 Base Rent \$2,767.50

A Second five (5) year option rent schedule will be as follows:

| | |
|---------------------|---------|
| 07/01/10 - 06/30/11 | \$21.25 |
| 07/01/11 - 06/30/12 | \$22.00 |
| 07/01/12 - 06/30/13 | \$22.00 |
| 07/01/13 - 06/30/14 | \$22.75 |
| 07/01/14 - 06/30/15 | \$22.75 |

Please sign below as acknowledgement and acceptance to renew your lease for the aforementioned additional period.

Dated this 27 day of June, 2005

Witness:
Rise Thomas

Sam Lee
Mr. Sam Lee SOONAM LEE
Take Sushi

Witness:
Reena El

Laith Jonna
Laith Jonna, Managing Member
Remy & Associates, LLC

Rise Thomas
Notary Public Oakland County, MI My Commission Expires:

LEASE

BETWEEN

REMY & ASSOCIATES, L.L.C., d/b/a ROCHESTER HILLS PLAZA

AND

IHN-KYUNG-PARK ON BEHALF OF A CORPORATION TO BE FORMED

RECORDED
NOV 11 1994
11:11 AM '94

LEASE BETWEEN

REMY & ASSOCIATES, L.L.C., d/b/a ROCHESTER HILLS PLAZA

AND

IHN-KYUNG-PARK ON BEHALF OF A CORPORATION TO BE FORMED

TABLE OF CONTENTS

| | Page |
|---|------|
| ARTICLE I. GRANT AND TERM..... | 1 |
| ARTICLE II. RENT..... | 1 |
| ARTICLE III. TAXES..... | 2 |
| ARTICLE IV. OPERATION AND MAINTENANCE OF COMMON AREAS..... | 3 |
| ARTICLE V. CONDITION OF PREMISES, LANDLORD'S WORK AND TENANT'S WORK..... | 3 |
| ARTICLE VI. CONDUCT OF BUSINESS BY TENANT..... | 5 |
| ARTICLE VII. ALTERATIONS AND SIGNS..... | 6 |
| ARTICLE VIII. MAINTENANCE OF LEASED PREMISES..... | 7 |
| ARTICLE IX. INSURANCE AND INDEMNITY..... | 7 |
| ARTICLE X. UTILITY CHARGES..... | 8 |
| ARTICLE XI. ESTOPEL STATEMENT, ATTORNEYS' FEES AND SUBORDINATION..... | 8 |
| ARTICLE XII. ASSIGNMENT AND SUBLETTING..... | 8 |
| ARTICLE XIII. ADVERTISING, MERCHANTS' ASSOCIATION..... | 8 |
| ARTICLE XIV. DESTRUCTION OF LEASED PREMISES..... | 9 |
| ARTICLE XV. EMINENT DOMAIN..... | 9 |
| ARTICLE XVI. DEFAULT OF THE TENANT..... | 9 |
| ARTICLE XVII. BANKRUPTCY OR INSOLVENCY..... | 10 |
| ARTICLE XVIII. ACCESS BY LANDLORD..... | 11 |
| ARTICLE XIX. TENANT'S PROPERTY..... | 11 |
| ARTICLE XX. HOLDING OVER..... | 11 |
| ARTICLE XXI. RULES AND REGULATIONS..... | 12 |
| ARTICLE XXII. SECURITY PROVISIONS..... | 12 |
| ARTICLE XXIII. EXPANSION OF SHOPPING CENTER..... | 12 |
| ARTICLE XXIV. ROOF..... | 12 |
| ARTICLE XXV. LIGHTING..... | 12 |
| ARTICLE XXVI. EXCUSE OF PERFORMANCE..... | 12 |
| ARTICLE XXVII. CONTINUATION OF BUSINESS..... | 12 |
| ARTICLE XXVIII. FINANCING..... | 12 |
| ARTICLE XXIX. MISCELLANEOUS..... | 12 |