

# 2025 Application for Fireworks Other Than Consumer or Low Impact

FOR USE BY LEGISLATIVE BODY  
OF CITY, VILLAGE OR TOWNSHIP  
BOARD ONLY

DATE PERMIT(S) EXPIRE:

Authority: 2011 PA 256

The LEGISLATIVE BODY OF CITY, VILLAGE OR TOWNSHIP BOARD will not discriminate against any individual or group because of race, sex, religion, age, national origin, color, marital status, disability, or political beliefs. If you need assistance with reading, writing, hearing, etc., under the Americans with Disabilities Act, you may make your needs known to this Legislative Body of City, Village or Township Board.

TYPE OF PERMIT(S) (Select all applicable boxes)

- ☐ Agricultural or Wildlife Fireworks ☐ Articles Pyrotechnic ☒ Display Fireworks
- ☒ Public Display ☐ Private Display
- ☐ Special Effects Manufactured for Outdoor Pest Control or Agricultural Purposes

NAME OF APPLICANT

AMERICAN FIREWORKS CO. FOR OAKLAND CO. MI

ADDRESS OF APPLICANT

1000 ROCHESTER HILLS DRIVE, ROCHESTER HILLS, MI

AGE OF APPLICANT 18 YEARS OR OLDER

☐ YES ☐ NO

NAME OF PERSON OR RESIDENT AGENT REPRESENTING CORPORATION, LLC, DBA OR OTHER

ADDRESS PERSON OR RESIDENT AGENT REPRESENTING CORPORATION, LLC, DBA OR OTHER

IF A NON-RESIDENT APPLICANT (LIST NAME OF MICHIGAN ATTORNEY OR MICHIGAN RESIDENT AGENT)

LISA CUMMINS

ADDRESS (MICHIGAN ATTORNEY OR MICHIGAN RESIDENT AGENT)

1000 ROCHESTER HILLS DRIVE, ROCHESTER HILLS, MI

TELEPHONE NUMBER

NAME OF PYROTECHNIC OPERATOR

MIKE MURLAND

ADDRESS OF PYROTECHNIC OPERATOR

5196 S. US HIGHWAY, WILMINGTON, OH

AGE OF PYROTECHNIC OPERATOR 18 YEARS OR OLDER

☒ YES ☐ NO

NO. YEARS EXPERIENCE

20 YEARS

NO. DISPLAYS

200+

WHERE

THROUGHOUT OHIO, MICHIGAN, PENNSYLVANIA & INDIANA

NAME OF ASSISTANT

MICHELLE MURLAND

ADDRESS OF ASSISTANT

5196 S. US HIGHWAY, WILMINGTON, OH

AGE OF ASSISTANT 18 YEARS OR OLDER

☒ YES ☐ NO

NAME OF OTHER ASSISTANT

ADDRESS OF OTHER ASSISTANT

AGE OF OTHER ASSISTANT 18 YEARS OR OLDER

☐ YES ☐ NO

EXACT LOCATION OF PROPOSED DISPLAY

BORDEN PARK, 1400 EAST HAMLIN ROAD, ROCHESTER HILLS, MI

DATE OF PROPOSED DISPLAY

JUNE 25, 2025

TIME OF PROPOSED DISPLAY

APPROXIMATELY 9:30 PM

MANNER AND PLACE OF STORAGE, SUBJECT TO APPROVAL OF LOCAL FIRE AUTHORITIES, IN ACCORDANCE WITH NFPA 1123, 1124 & 1126 AND OTHER STATE OR FEDERAL REGULATIONS. PROVIDE PROOF OF PROPER LICENSING OR PERMITTING BY STATE OR FEDERAL GOVERNMENT

OVERNIGHT STORAGE IS BEING REQUESTED FOR JUNE 25, 2025 ARRIVAL TO BE STORED IN BOX TRUCK ON SITE (PLEASE SEE ATTACHED LETTER)

AMOUNT OF BOND OR INSURANCE (TO BE SET BY LOCAL GOVERNMENT)

\$10,000,000

NAME OF BONDING CORPORATION OR INSURANCE COMPANY

EVEREST INDEMNITY INS. CO. & EVEREST DANALI INS. CO.

ADDRESS OF BONDING CORPORATION OR INSURANCE COMPANY

BRITTON-GALLAGHER & ASSOCIATES, INC., ONE CLEVELAND CENTER, FLOOR 30, 1375 E. 9TH STREET, CLEVELAND, OH

NUMBER OF FIREWORKS

KIND OF FIREWORKS TO BE DISPLAYED (Please provide additional pages as needed)

2200

1.5" ASSORTED AERIAL SHELLS

936

3" ASSORTED AERIAL SHELLS

378

4" ASSORTED AERIAL SHELLS

234

5" ASSORTED AERIAL SHELLS

108

6" ASSORTED AERIAL SHELLS

19

8" ASSORTED AERIAL SHELLS

SIGNATURE OF APPLICANT

*Roberto Sorgi*

ROBERTO SORGI, PRESIDENT - AMERICAN FIREWORKS COMPANY

DATE

5-15-25

## Application for Fireworks Other Than Consumer or Low Impact

[illegible]



**Please Note: Not Valid for the Sale or Other Disposition of Explosives.**





# CERTIFICATE OF LIABILITY INSURANCE

DATE (MM/DD/YYYY)

5/3/2025

THIS CERTIFICATE IS ISSUED AS A MATTER OF INFORMATION ONLY AND CONFERS NO RIGHTS UPON THE CERTIFICATE HOLDER. THIS CERTIFICATE DOES NOT AFFIRMATIVELY OR NEGATIVELY AMEND, EXTEND OR ALTER THE COVERAGE AFFORDED BY THE POLICIES BELOW. THIS CERTIFICATE OF INSURANCE DOES NOT CONSTITUTE A CONTRACT BETWEEN THE ISSUING INSURER(S), AUTHORIZED REPRESENTATIVE OR PRODUCER, AND THE CERTIFICATE HOLDER.

**IMPORTANT:** If the certificate holder is an ADDITIONAL INSURED, the policy(ies) must have ADDITIONAL INSURED provisions or be endorsed. If SUBROGATION IS WAIVED, subject to the terms and conditions of the policy, certain policies may require an endorsement. A statement on this certificate does not confer rights to the certificate holder in lieu of such endorsement(s).

<b>PRODUCER</b> Acisire Great Lakes Partners Insurance Services 223 West Grand River Ave #1 Howell MI 48843	<b>CONTACT NAME:</b> <b>PHONE (A/C, No, Ext):</b> 216-658-7100 <b>E-MAIL ADDRESS:</b> info@brittongallagher.com <b>FAX (A/C, No):</b> 216-658-7101												
<b>INSURED</b> American Fireworks Company 7041 Darrow Road P.O. Box 1447 Hudson OH 44236-2254	<b>INSURER(S) AFFORDING COVERAGE</b> <table><tr><td><b>INSURER A:</b> Everest Indemnity Insurance Co.</td><td><b>NAIC #</b> 10851</td></tr><tr><td><b>INSURER B:</b> Everest Denali Insurance Company</td><td>16044</td></tr><tr><td><b>INSURER C:</b> Axis Surplus Ins Company</td><td>26620</td></tr><tr><td><b>INSURER D:</b> Accident Fund Ins. Co.</td><td></td></tr><tr><td><b>INSURER E:</b> Everest National Insurance Company</td><td>10120</td></tr><tr><td><b>INSURER F:</b></td><td></td></tr></table>	<b>INSURER A:</b> Everest Indemnity Insurance Co.	<b>NAIC #</b> 10851	<b>INSURER B:</b> Everest Denali Insurance Company	16044	<b>INSURER C:</b> Axis Surplus Ins Company	26620	<b>INSURER D:</b> Accident Fund Ins. Co.		<b>INSURER E:</b> Everest National Insurance Company	10120	<b>INSURER F:</b>	
<b>INSURER A:</b> Everest Indemnity Insurance Co.	<b>NAIC #</b> 10851												
<b>INSURER B:</b> Everest Denali Insurance Company	16044												
<b>INSURER C:</b> Axis Surplus Ins Company	26620												
<b>INSURER D:</b> Accident Fund Ins. Co.													
<b>INSURER E:</b> Everest National Insurance Company	10120												
<b>INSURER F:</b>													

**COVERAGES**

CERTIFICATE NUMBER: 1305956718

REVISION NUMBER:

THIS IS TO CERTIFY THAT THE POLICIES OF INSURANCE LISTED BELOW HAVE BEEN ISSUED TO THE INSURED NAMED ABOVE FOR THE POLICY PERIOD INDICATED. NOTWITHSTANDING ANY REQUIREMENT, TERM OR CONDITION OF ANY CONTRACT OR OTHER DOCUMENT WITH RESPECT TO WHICH THIS CERTIFICATE MAY BE ISSUED OR MAY PERTAIN, THE INSURANCE AFFORDED BY THE POLICIES DESCRIBED HEREIN IS SUBJECT TO ALL THE TERMS, EXCLUSIONS AND CONDITIONS OF SUCH POLICIES. LIMITS SHOWN MAY HAVE BEEN REDUCED BY PAID CLAIMS.

INSR LTR	TYPE OF INSURANCE	ADDL INSD	SUBR WVD	POLICY NUMBER	POLICY EFF (MM/DD/YYYY)	POLICY EXP (MM/DD/YYYY)	LIMITS														
E	<input checked="" type="checkbox"/> <b>COMMERCIAL GENERAL LIABILITY</b> <input type="checkbox"/> CLAIMS-MADE <input checked="" type="checkbox"/> OCCUR  GEN'L AGGREGATE LIMIT APPLIES PER: <input type="checkbox"/> POLICY <input checked="" type="checkbox"/> PROJECT <input type="checkbox"/> LOC OTHER:			GCN0010788-251	2/1/2025	2/1/2026	<table><tr><td>EACH OCCURRENCE</td><td>\$ 1,000,000</td></tr><tr><td>DAMAGE TO RENTED PREMISES (Ea occurrence)</td><td>\$ 500,000</td></tr><tr><td>MED EXP (Any one person)</td><td>\$</td></tr><tr><td>PERSONAL &amp; ADV INJURY</td><td>\$ 1,000,000</td></tr><tr><td>GENERAL AGGREGATE</td><td>\$ 2,000,000</td></tr><tr><td>PRODUCTS - COMP/OP AGG</td><td>\$ 2,000,000</td></tr><tr><td></td><td>\$</td></tr></table>	EACH OCCURRENCE	\$ 1,000,000	DAMAGE TO RENTED PREMISES (Ea occurrence)	\$ 500,000	MED EXP (Any one person)	\$	PERSONAL & ADV INJURY	\$ 1,000,000	GENERAL AGGREGATE	\$ 2,000,000	PRODUCTS - COMP/OP AGG	\$ 2,000,000		\$
EACH OCCURRENCE	\$ 1,000,000																				
DAMAGE TO RENTED PREMISES (Ea occurrence)	\$ 500,000																				
MED EXP (Any one person)	\$																				
PERSONAL & ADV INJURY	\$ 1,000,000																				
GENERAL AGGREGATE	\$ 2,000,000																				
PRODUCTS - COMP/OP AGG	\$ 2,000,000																				
	\$																				
B	<b>AUTOMOBILE LIABILITY</b> <input checked="" type="checkbox"/> ANY AUTO <input type="checkbox"/> OWNED AUTOS ONLY <input type="checkbox"/> SCHEDULED AUTOS <input checked="" type="checkbox"/> HIRED AUTOS ONLY <input checked="" type="checkbox"/> NON-OWNED AUTOS ONLY			GCD0010064-251	2/1/2025	2/1/2026	<table><tr><td>COMBINED SINGLE LIMIT (Ea accident)</td><td>\$ 1,000,000</td></tr><tr><td>BODILY INJURY (Per person)</td><td>\$</td></tr><tr><td>BODILY INJURY (Per accident)</td><td>\$</td></tr><tr><td>PROPERTY DAMAGE (Per accident)</td><td>\$</td></tr><tr><td></td><td>\$</td></tr></table>	COMBINED SINGLE LIMIT (Ea accident)	\$ 1,000,000	BODILY INJURY (Per person)	\$	BODILY INJURY (Per accident)	\$	PROPERTY DAMAGE (Per accident)	\$		\$				
COMBINED SINGLE LIMIT (Ea accident)	\$ 1,000,000																				
BODILY INJURY (Per person)	\$																				
BODILY INJURY (Per accident)	\$																				
PROPERTY DAMAGE (Per accident)	\$																				
	\$																				
C	<input type="checkbox"/> <b>UMBRELLA LIAB</b> <input checked="" type="checkbox"/> OCCUR <input checked="" type="checkbox"/> <b>EXCESS LIAB</b> <input type="checkbox"/> CLAIMS-MADE DED RETENTION \$			P-001-000841157-04	2/1/2025	2/1/2026	<table><tr><td>EACH OCCURRENCE</td><td>\$ 4,000,000</td></tr><tr><td>AGGREGATE</td><td>\$ 4,000,000</td></tr><tr><td></td><td>\$</td></tr></table>	EACH OCCURRENCE	\$ 4,000,000	AGGREGATE	\$ 4,000,000		\$								
EACH OCCURRENCE	\$ 4,000,000																				
AGGREGATE	\$ 4,000,000																				
	\$																				
D	<b>WORKERS COMPENSATION AND EMPLOYERS' LIABILITY</b> ANY PROPRIETOR/PARTNER/EXECUTIVE OFFICER/MEMBER EXCLUDED? (Mandatory in NH) If yes, describe under DESCRIPTION OF OPERATIONS below			ARP12001125200 (MI)	4/19/2025	4/19/2026	<table><tr><td><input checked="" type="checkbox"/> PER STATUTE <input type="checkbox"/> OTH-ER</td><td></td></tr><tr><td>E.L. EACH ACCIDENT</td><td>\$ 1,000,000</td></tr><tr><td>E.L. DISEASE - EA EMPLOYEE</td><td>\$ 1,000,000</td></tr><tr><td>E.L. DISEASE - POLICY LIMIT</td><td>\$ 1,000,000</td></tr></table>	<input checked="" type="checkbox"/> PER STATUTE <input type="checkbox"/> OTH-ER		E.L. EACH ACCIDENT	\$ 1,000,000	E.L. DISEASE - EA EMPLOYEE	\$ 1,000,000	E.L. DISEASE - POLICY LIMIT	\$ 1,000,000						
<input checked="" type="checkbox"/> PER STATUTE <input type="checkbox"/> OTH-ER																					
E.L. EACH ACCIDENT	\$ 1,000,000																				
E.L. DISEASE - EA EMPLOYEE	\$ 1,000,000																				
E.L. DISEASE - POLICY LIMIT	\$ 1,000,000																				
A	Excess Liability #2			GCI0010150-251	2/1/2025	2/1/2026	<table><tr><td>Each Occ/ Aggregate Total Excess Limits</td><td>\$5,000,000 \$9,000,000</td></tr></table>	Each Occ/ Aggregate Total Excess Limits	\$5,000,000 \$9,000,000												
Each Occ/ Aggregate Total Excess Limits	\$5,000,000 \$9,000,000																				

DESCRIPTION OF OPERATIONS / LOCATIONS / VEHICLES (ACORD 101, Additional Remarks Schedule, may be attached if more space is required)

Additional Insured extension of coverage is provided by above referenced General Liability and Auto Liability policies where required by written agreement.  
Display Date: June 25, 2025 Rain Date: July 9, 2025  
Location: Borden Park, 1400 East Hamlin Road, Rochester Hills, Michigan

RE: General Liability, the following are named as additional insured in respects to the negligence of the named insured:

See Attached...

**CERTIFICATE HOLDER****CANCELLATION**

City of Rochester Hills  
Rochester Hills MI

SHOULD ANY OF THE ABOVE DESCRIBED POLICIES BE CANCELLED BEFORE THE EXPIRATION DATE THEREOF, NOTICE WILL BE DELIVERED IN ACCORDANCE WITH THE POLICY PROVISIONS.

AUTHORIZED REPRESENTATIVE

**ADDITIONAL REMARKS SCHEDULE**Page 1 of 1

AGENCY Acrisure Great Lakes Partners Insurance Services		NAMED INSURED American Fireworks Company 7041 Darrow Road P. O. Box 1447 Hudson OH 44236-2254
POLICY NUMBER		
CARRIER	NAIC CODE	
EFFECTIVE DATE:		

**ADDITIONAL REMARKS****THIS ADDITIONAL REMARKS FORM IS A SCHEDULE TO ACORD FORM,****FORM NUMBER:** 25 **FORM TITLE:** CERTIFICATE OF LIABILITY INSURANCE

Additional Insureds: the City of Rochester Hills, all elected and appointed officials, all employees and volunteers, all boards, commissions and/or authorities and board members, including employees and volunteers



# City of Rochester Hills: Festival of the Hills

Borden Park: 1400 East Hamlin Road, Rochester Hills, Michigan 48307

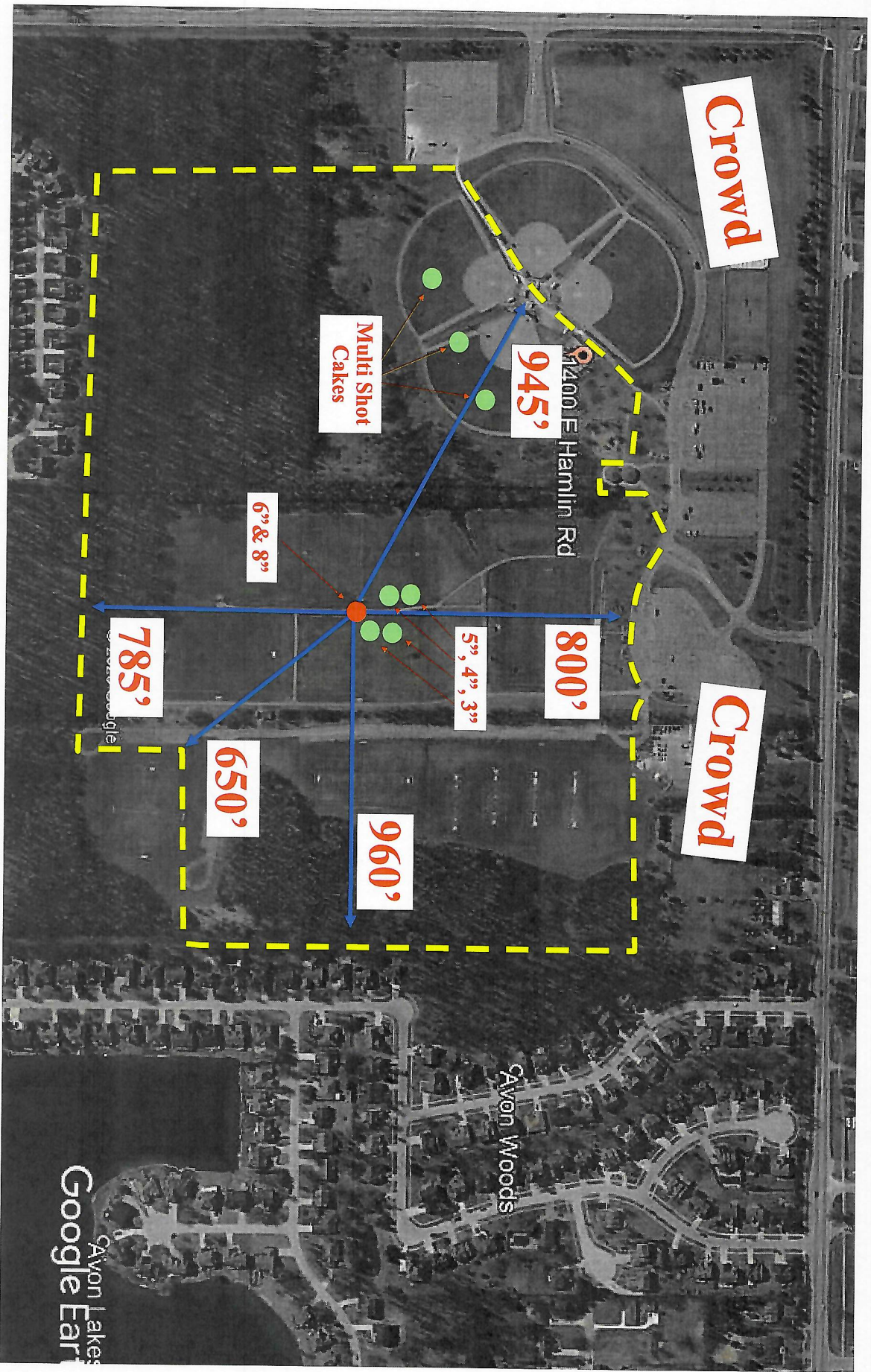

Distance Required to Meet NFPA 1123

1.5" —> 8"  
105' —> 560'

AMERICAN FIREWORKS COMPANY

RFS 2025



### **Pyrotechnic Application**

1. Completed Application for State Permit is attached.
2. Proof of liability insurance is attached.
3. Plan for the use of pyrotechnic special effects:
  - a. City of Rochester Hills, Festival of the Hills
  - b. June 25, 2025 at approximately 9:30 PM
  - c. The soccer fields and baseball diamonds (front show) at Borden Park, 1400 E. Hamlin Rd., Rochester Hills, MI 48307
  - d. Mike Murtland is the pyrotechnic operator.
  - e. 4 Assistants:
    - i. Michele Murtland – 49
    - ii. Connor Childs – 30
    - iii. Francesca Childs – 34
    - iv. Tim Bilbrey – 69
    - v. Dan Bilbrey – 64
    - vi. Robert Felmlly – 52
    - vii. Chip Davis – 61
  - f. Mike Murtland has successfully shot 10+ displays of the same size or larger than the Rochester Hills display. He attends American Fireworks Company yearly safety seminar.
  - g. Mike Murtland has been a pyrotechnic operator for over 10 years and has shot over 500 displays in the United States.
  - h. There is no license required to be a pyrotechnicians in the State of Michigan but he (along with his crew) has cleared a federal background check conducted by the BATFE and is allowed to work under American Fireworks Company's ATF license.
  - i. 22 – 1.5" Special Effect Barrages, 1.3 G Fireworks UN-0335 PGII, 936- 3" 1.3 G Fireworks, UN-0335 PGII, UN-0335 PGII; 378 – 4" 1.3 G Fireworks, UN-0335 PGII; 234 – 5" 1.3 G Fireworks, UN-0335 PGII; 108 – 6" 1.3 G Fireworks, 19 – 8" 1.3 G Fireworks, UN-0335 PGII. All items will be shot using electric match. The pyrotechnic operator and his assistants have worked extensively with all of these, shooting more than 50 shows a year using these same types of devices. General responsibilities of the assistants will be setting up and securing racks, loading and plugging in shells, assisting with continuity check and failed electric match checks and resolving any

problems which can be resolved before shooting display, checking for unexploded materials after the display is shot and disassembling equipment, loading it back on the truck and cleaning the shoot site.

- j. Site diagram is attached.
- k. All equipment will be assembled in its designated area on the shoot site, marked with the green pins on the site diagram.
- l. Pyrotechnics will arrive Wednesday morning the day of the display.
- m. SDS sheets are attached.
- n. All of our mortar racks are made of HDPE (high density polyethylene) or fiberglass, both of which are permitted for use of shooting pyrotechnic devices per NFPA 1123 (4.3.7.1), PGI (Official Fireworks Safety Guidelines 6.C.2) and A.P.A. (APA Display Fireworks Training Program 7.1.4.1.).



SAFETY DATA SHEET

QUICK IDENTIFIER

UN0335 1.3G DISPLAY FIREWORKS

May be used to comply with OSHA’s Hazard Communication Standard. 29CFR 1910. 1200. Standard must be consulted for specific requirements.

Common Name: (Used on label and list)

SECTION 1

Manufacturer’s Name:		Emergency Telephone No.
Address:		Other
City, State & Zip		Information Calls: <b>Enroute Inquiry</b>
Signature of Person		Date
Responsible for Preparation (Optional)		Prepared: <b>January 1, 2025</b>

SECTION 2 - HAZARDOUS INGREDIENTS/IDENTIFY

Hazardous Component(s) (chemical & common name(s))	% (Optional)	OSHA PEL	ACGIH TL	Other Exposure Limits	CAS NO
--	--------------	----------	----------	-----------------------	--------

**CONTAINS EXPLOSIVE AND PYROTECHNIC COMPOSITIONS AND ARE CLASSIFIED AS EXPLOSIVES**  
**1.3G UN0335 PGII BY THE DEPARTMENT OF TRANSPORTATION.**

**NO CHEMICAL COMPOSITIONS ARE EXPOSED DURING HANDLING AND STORAGE**

SECTION 3 - PHYSICAL & CHEMICAL CHARACTERISTICS

Boiling Point	<b>N/A</b>	Specific Gravity (H <sub>2</sub> O = 1)	<b>N/A</b>	Vapor Pressure (mm Hg)	<b>N/A</b>
		Vapor Density (Air = 1)	<b>N/A</b>		
Solubility in Water	<b>SLIGHT</b>	Reactivity in Water	<b>N/A</b>		
Appearance and Odor	<b>CONTAINED IN CARDBOARD CASING</b>	Melting Point	<b>N/A</b>		

SECTION 4 - FIRE & EXPLOSION DATA

Flash Point	<b>N/A</b>	Method	Flammable Limits	LEL	UEL
		F. C. Used	In Air % by Volume	Lower	Upper
Auto-Ignition Temperature	Extinguisher			<b>N/A</b>	<b>N/A</b>
Special Fire	Media	<b>DO NOT ATTEMPT TO FIGHT FIRE IN VICINITY - EVACUATE</b>			
Fighting Procedures	<b>EVACUATE FIRE AREA IMMEDIATELY AND SEEK SHELTER</b>				
Unusual Fire and Explosion Hazards	<b>MAY MASS EXPLODE</b>				

## SECTION 5 - PHYSICAL HAZARDS (REACTIVITY DATA)

Stability      Unstable ☐ Conditions  
Stable ☒ to Avoid

**OPEN FLAMES, SMOKING OR MOISTURE/FRICTION & IMPACT**

Incompatibility

(Materials to Avoid)

**SOAKING WET OR DAMP**

Hazardous

Decomposition Products

**DEVICES WILL EXPLODE IN FIRE SITUATION**

Hazardous      May Occur ☐ Conditions

Polymerization      Will Not Occur ☐ to Avoid

## SECTION 6 - HEALTH HAZARDS

1. Acute (Immediate)

2. Chronic (Delayed Effect)

**CLORATE OF SODA-ALUMINUM**

Signs and

Symptoms of Exposure

Medical Conditions Generally

Aggravated by Exposure      **N/A**

Chemical Listed as Carcinogen

National Toxicology      Yes ☐

I.A.R.C.      Yes ☐

OSHA      Yes ☐

or Potential Carcinogen      **N/A**

Program      No ☒

Monographs      No ☒

No ☒

Emergency and

First Aid Procedures

**N/A**

ROUTES

OF

ENTRY

1. Inhalation      **NO**

2. Eyes      **NO**

3. Skin      **NO**

4. Ingestion      **NO**

AMERICAN

## SECTION 7 - SPECIAL PRECAUTIONS AND SPILL/LEAK PROCEDURES

Precautions to be Taken

in Handling and Storage

**KEEP COOL AND DRY, AVOID IMPACT, NO SMOKING**

Other

Precautions

**KEEP FIRE AWAY - HANDLE CAREFULLY**

Steps to be Taken in Case

Material is Released or Spilled

**CAUTIOUSLY PICK UP SPILLED DEVICES AND PLACE IN CASE**

Waste Disposal Methods

(Consult Federal, State and Local Regulations)

**REPACK PRODUCT AND TRANSPORT BACK TO ATF APPROVED  
MAGAZINE**

## SECTION 8 - SPECIAL PROTECTION INFORMATION/CONTROL MEASURES

Respiratory Protection

(Specify Type)      **N/A**

Ventilation

Local

Mechanical

Special

Other

**OUTDOOR USE ONLY**

Exhaust

(General)

Protective

Eye

Gloves

**N/A**

Protection

**N/A**

Other Protective

Clothing or Equipment

**N/A**

Work/Hygienic Practices

**N/A**

### IMPORTANT

Do not leave any blank spaces. If required information is unavailable, unknown or does not apply, so indicate.

CU-F1R Printed by Labelmaster, An American Labelmark Company, Chicago, IL 60646 (800) 621-5808



# EMERGENCY RESPONSE INFORMATION

## SPECIAL FIREWORKS (UN0335 -FIREWORKS 1.3G)

Special Fireworks contain explosive and pyrotechnic compositions and are classified as Fireworks 1.3G by the U.S. Department of Transportation. No chemical components are released during normal handling and storage of shells.

No chemical components are released during normal handling of shells, storage, and transportation. In the event of a vehicle fire that reached the cargo area, the fireworks are likely to ignite. They will explode rapidly, spreading burning particles over a several hundred-foot areas. A mass explosion is unlikely, but precautions should be taken if one does occur. Smoke and potentially irritating gases will be produced in a fire. If the fireworks are spilled as the result of an accident but do not ignite, they can safely be picked up and repackaged. The area should be kept cleared of unnecessary people while this is being done.

### **EMERGENCY ACTION**

In case of fire, stop traffic and begin to clear the area for 2,500 feet (1/2 mile) in all directions. Keep unnecessary people away. **DO NOT** fight fire in cargo area. Try to prevent other types of fire from reaching the cargo area. Self-contained breathing apparatus (SCBA) and structural firefighter's protective clothing will provide some limited protection. Firefighters should retreat if fire approaches cargo area.

For additional information, call the shipper using the emergency telephone number listed on the shipping papers; if there is no answer, call Chemtel's 24-Hour number 800-255-3924.

### **FIRE**

Truck fire (other than cargo area): Flood with water. The fires may start again. Unhook and separate tractor from trailer, if possible.

Cargo fire: **DO NOT** move cargo or vehicle if cargo has been exposed to heat. **DO NOT** fight fire when it reaches cargo. Withdraw from area and let fire burn. Use firefighting team to prevent spread of fire to adjacent structures and materials. Promptly isolate the scene by removing all persons from the vicinity of the incident. First, move people out of line-of-sight of the scene and away from windows. Obtain more information from competent authorities listed on the shipping papers.

### **SPILL OF CARGO**

Shut off all ignition sources. There shall be no flares, smoking, tools capable of producing sparks, or flames in the vicinity of the spilled material. Cautiously pick up the spilled devices and place them in cardboard cartons.

### **FIRST AID**

Call emergency medical care.

Use first aid treatment according to the nature of the injury.

2025

**Permit for Fireworks Other Than Consumer or Low Impact**  
Michigan Department of Licensing & Regulatory Affairs  
Bureau of Fire Services  
P.O. Box 30700  
Lansing MI 48909  
(517) 241-8847

Authority:	2011 PA 256	The Department of Licensing & Regulatory Affairs will not discriminate against any individual or group because of race, sex, religion, age, national origin, color, marital status, disability, or political beliefs. If you need assistance with reading, writing, hearing, etc., under the Americans with Disabilities Act, you may make your needs known to this agency.
Compliance:	Voluntary	
Penalty:	Permit will not be issued	

*This permit is not transferable. Possession of this permit authorizes the herein named person to possess, transport and display fireworks in the amounts, for the purpose of and at the place listed below only.*

Display Fireworks		
ISSUED TO AMERICAN FIREWORKS COMPANY FOR THE CITY OF ROCHESTER HILLS, MICHIGAN		AGE (18 or over)
ADDRESS 7041 DARROW ROAD, HUDSON, OHIO		
NAME OF ORGANIZATION, GROUP, FIRM OR CORPORATION CITY OF ROCHESTER HILLS, MICHIGAN - LISA CUMMINGS		
ADDRESS 1000 ROCHESTER HILLS DRIVE, ROCHESTER HILLS, MI		
NUMBER AND TYPES OF FIREWORKS		
2200	1.5" ASSORTED AERIAL SHELLS	
936	3" ASSORTED AERIAL SHELLS	
378	4" ASSORTED AERIAL SHELLS	
234	5" ASSORTED AERIAL SHELLS	
108	6" ASSORTED AERIAL SHELLS	
19	8" ASSORTED AERIAL SHELLS	
EXACT LOCATION OF DISPLAY OR USE BORDEN PARK, 1400 EAST HAMLIN ROAD, ROCHESTER HILLS, MI		
CITY, VILLAGE, TOWNSHIP ROCHESTER HILLS, MICHIGAN		DATE JUNE 25, 2025
BOND OR INSURANCE FILED <input checked="" type="checkbox"/> YES <input type="checkbox"/> NO		TIME 9:30 PM
		AMOUNT \$10,000,000

Issued by action of the Legislative Body of a

☐ City ☐ Village ☐ Township of \_\_\_\_\_ on the \_\_\_\_\_ day of \_\_\_\_\_

(Signature and Title of Legislative Body Representative)

**\*THIS FORM IS VALID FOR THE YEAR SHOWN ONLY\***