



Special License Application

A completed Special License application must be submitted as early as possible before your event(s) to avoid any delays in processing. **It is strongly recommended that you submit the application as soon as you know the date of your event(s).** Failure to submit a completed application at least ten (10) business days prior to the event(s) may result in no Special License being issued, pursuant to administrative rule R 436.575.

Part 1 - Applicant Organization Information

Applicant organization name: The Rochester Hills Museum at Van Hoosen Farm		
Applicant address: 1005 Van Hoosen Road		
City: Rochester Hills		Zip Code: 48306
Contact name: Jenna Raschke	Phone: 248-841-2674	Email: raschkej@rochesterhills.org
Alternate contact name: <i>Cathy Fitzpatrick</i>	Phone: <i>248 841-2690</i>	Email: <i>fitzpatrickc@rochesterhills.org</i>
1. Has the applicant organization previously received a Special License? <input checked="" type="radio"/> Yes <input type="radio"/> No If No, the applicant organization must submit documentary proof of its non-profit status (e.g. charter, bylaws, IRS tax exemption, Articles of Incorporation, etc.)		<i>Leave Blank - MLCC Use Only</i>
2. Has the applicant organization been established for one (1) year or longer? <input checked="" type="radio"/> Yes <input type="radio"/> No Date the applicant organization was established (month/day/year): <u>11/19/1984</u>		
3. Is the applicant organization a municipality? <input checked="" type="radio"/> Yes <input type="radio"/> No		

Part 2 - Event Information - For requests at more than one location, submit separate forms for each location.

Address of event location: 1005 Van Hoosen Road Rochester Hills MI 48306	
City, township, or village where event will be held: Rochester Hills	County: Oakland ▼
1. Will you submit your completed application at least ten (10) business days before your event? <i>It is strongly recommended that you submit the application as soon as you know the date of your event(s).</i> <input checked="" type="radio"/> Yes <input type="radio"/> No	
2. Do you have permission from the property owner of the location listed above to hold your event(s) on the date(s) listed below (see pages 2-3) at this location? <input checked="" type="radio"/> Yes <input type="radio"/> No	
3. Has the local law enforcement agency with primary jurisdiction over the event location approved this application for a Special License? (See Part 5 on Page 5) <input checked="" type="radio"/> Yes <input type="radio"/> No	
4. Is the event location within 500 feet of a church or school? If Yes, the church or school must consent to the event(s). (See Part 6 on Page 5) <input type="radio"/> Yes <input checked="" type="radio"/> No	
5. Is the event location outdoors or partially outdoors? <input checked="" type="radio"/> Yes <input type="radio"/> No If Yes, list the exact dimensions of the outdoor area: Submit a clear diagram of the outdoor service area with your application form.	
<div style="border: 1px solid black; padding: 5px; display: inline-block;">250</div> feet X <div style="border: 1px solid black; padding: 5px; display: inline-block;">200</div> feet = <div style="border: 1px solid black; padding: 5px; display: inline-block;">50,000</div> square feet <small>Width Length</small>	Describe type and height of the barrier that will be used to enclose the outdoor area: Portable barricades will enclose the event area. <i>4ft high</i>
6. Describe type of security that will be used for event(s) and how it will be utilized to secure and monitor to prevent sales to minors and visibly intoxicated persons: Local Oakland County Sherriff and City of Rochester Police agencies will be notified of event. Bartenders are TIPS certified, licesned and insured through Crank's Catering.	

7. Is the event location situated in or on state owned land, such as a state park or National Guard armory? Yes No
 If Yes, attach a copy of your documentary proof of approval to use the state owned land.

8. Is there an existing liquor licensee issued at the event location, such as a Class C or Club license? Yes No
 If Yes, the existing licensee must request to place its license in escrow during the event(s). (See Part 7 on Page 5)

9. Will the event(s) involve an auction of donated wine? Yes No
 If Yes, please check "Wine Auction" for the applicable event date(s) on pages 2-3. Only donated wine may be auctioned under a Special License; beer and spirits cannot be auctioned. If you request a Special License for on-premises consumption AND for a Wine Auction both on the same date at the same location, you are requesting two (2) separate licenses and you must pay a license fee for both licenses.

10. Have you applied for or been issued a Temporary Marihuana Event License from the Marijuana Regulatory Agency (MRA) for the event(s)? Yes No

11. Is the event location in a Social District? Yes No
 If Yes, you must obtain written confirmation from the local governmental unit that the Social District Permit holders will not sell or serve alcohol for consumption in the Social District during the time period of the event(s) pursuant to [MCL 436.1551\(3\)](#). Submit the written confirmation with this application.

12. The applicant organization may request up to twelve (12) Special Licenses total (one Special License per day) in a calendar year. Please complete the information below **for each individual date** for which you are requesting a Special License at this location. **If you are requesting Special Licenses for consecutive days, completely fill out a separate box for each date. If you request a Special License for on-premises consumption AND for a Wine Auction both on the same date at the same location, you are requesting two (2) separate licenses and you must pay a license fee for both licenses.**

1	9/18/2021	Describe event being held: Museum fundraiser-music in the park event. "Barns and Brews"
	Date	
	4pm 8pm	
Special License will be used for: <input checked="" type="checkbox"/> Beer & Wine Service <input type="checkbox"/> Beer, Wine, & Spirit Service <input type="checkbox"/> Wine Auction		
Start Time End Time	Is this date a Sunday? <input type="radio"/> Yes <input checked="" type="radio"/> No	If Yes, will alcohol be served between 7:00AM and 12:00 Noon? <input type="radio"/> Yes <input type="radio"/> No

2		Describe event being held:
	Date	
	Start Time End Time	
Special License will be used for: <input type="checkbox"/> Beer & Wine Service <input type="checkbox"/> Beer, Wine, & Spirit Service <input type="checkbox"/> Wine Auction		
Start Time End Time	Is this date a Sunday? <input type="radio"/> Yes <input type="radio"/> No	If Yes, will alcohol be served between 7:00AM and 12:00 Noon? <input type="radio"/> Yes <input type="radio"/> No

3		Describe event being held:
	Date	
	Start Time End Time	
Special License will be used for: <input type="checkbox"/> Beer & Wine Service <input type="checkbox"/> Beer, Wine, & Spirit Service <input type="checkbox"/> Wine Auction		
Start Time End Time	Is this date a Sunday? <input type="radio"/> Yes <input type="radio"/> No	If Yes, will alcohol be served between 7:00AM and 12:00 Noon? <input type="radio"/> Yes <input type="radio"/> No

4		Describe event being held:
	Date	
	Start Time End Time	
Special License will be used for: <input type="checkbox"/> Beer & Wine Service <input type="checkbox"/> Beer, Wine, & Spirit Service <input type="checkbox"/> Wine Auction		
Start Time End Time	Is this date a Sunday? <input type="radio"/> Yes <input type="radio"/> No	If Yes, will alcohol be served between 7:00AM and 12:00 Noon? <input type="radio"/> Yes <input type="radio"/> No

5		Describe event being held:
	Date	
	Start Time End Time	
Special License will be used for: <input type="checkbox"/> Beer & Wine Service <input type="checkbox"/> Beer, Wine, & Spirit Service <input type="checkbox"/> Wine Auction		
Start Time End Time	Is this date a Sunday? <input type="radio"/> Yes <input type="radio"/> No	If Yes, will alcohol be served between 7:00AM and 12:00 Noon? <input type="radio"/> Yes <input type="radio"/> No

6		Describe event being held:
	Date	
	Start Time End Time	
Special License will be used for: <input type="checkbox"/> Beer & Wine Service <input type="checkbox"/> Beer, Wine, & Spirit Service <input type="checkbox"/> Wine Auction		
Start Time End Time	Is this date a Sunday? <input type="radio"/> Yes <input type="radio"/> No	If Yes, will alcohol be served between 7:00AM and 12:00 Noon? <input type="radio"/> Yes <input type="radio"/> No

12. Special license date information Continued from Page 2.

7	Date		Describe event being held:			
	Special License will be used for:		<input type="checkbox"/> Beer & Wine Service	<input type="checkbox"/> Beer, Wine, & Spirit Service	<input type="checkbox"/> Wine Auction	
	Start Time	End Time	Is this date a Sunday? <input type="radio"/> Yes <input type="radio"/> No		If Yes, will alcohol be served between 7:00AM and 12:00 Noon? <input type="radio"/> Yes <input type="radio"/> No	

8	Date		Describe event being held:			
	Special License will be used for:		<input type="checkbox"/> Beer & Wine Service	<input type="checkbox"/> Beer, Wine, & Spirit Service	<input type="checkbox"/> Wine Auction	
	Start Time	End Time	Is this date a Sunday? <input type="radio"/> Yes <input type="radio"/> No		If Yes, will alcohol be served between 7:00AM and 12:00 Noon? <input type="radio"/> Yes <input type="radio"/> No	

9	Date		Describe event being held:			
	Special License will be used for:		<input type="checkbox"/> Beer & Wine Service	<input type="checkbox"/> Beer, Wine, & Spirit Service	<input type="checkbox"/> Wine Auction	
	Start Time	End Time	Is this date a Sunday? <input type="radio"/> Yes <input type="radio"/> No		If Yes, will alcohol be served between 7:00AM and 12:00 Noon? <input type="radio"/> Yes <input type="radio"/> No	

10	Date		Describe event being held:			
	Special License will be used for:		<input type="checkbox"/> Beer & Wine Service	<input type="checkbox"/> Beer, Wine, & Spirit Service	<input type="checkbox"/> Wine Auction	
	Start Time	End Time	Is this date a Sunday? <input type="radio"/> Yes <input type="radio"/> No		If Yes, will alcohol be served between 7:00AM and 12:00 Noon? <input type="radio"/> Yes <input type="radio"/> No	

11	Date		Describe event being held:			
	Special License will be used for:		<input type="checkbox"/> Beer & Wine Service	<input type="checkbox"/> Beer, Wine, & Spirit Service	<input type="checkbox"/> Wine Auction	
	Start Time	End Time	Is this date a Sunday? <input type="radio"/> Yes <input type="radio"/> No		If Yes, will alcohol be served between 7:00AM and 12:00 Noon? <input type="radio"/> Yes <input type="radio"/> No	

12	Date		Describe event being held:			
	Special License will be used for:		<input type="checkbox"/> Beer & Wine Service	<input type="checkbox"/> Beer, Wine, & Spirit Service	<input type="checkbox"/> Wine Auction	
	Start Time	End Time	Is this date a Sunday? <input type="radio"/> Yes <input type="radio"/> No		If Yes, will alcohol be served between 7:00AM and 12:00 Noon? <input type="radio"/> Yes <input type="radio"/> No	

A completed Special License application must be submitted as early as possible before your event(s) to avoid any delays in processing. It is strongly recommended that you submit the application as soon as you know the date of your event(s). Failure to submit a completed application at least ten (10) business days prior to the event(s) may result in no Special License being issued, pursuant to administrative rule R 436.575.

Part 3 - Special License Fees - Complete the Special License fee calculation on Page 4

For Organizations established less than one year or are municipalities - a \$50.00 Special License base fee for each separate, consecutive day of the event is required. If the event is held on a Sunday and spirits will be served after 12:00 Noon, an additional \$7.50 Sunday Sales Permit (P.M.) fee is required. In addition, if any alcoholic beverages, including beer, wine, and spirits, will be served between 7:00AM and 12:00 Noon, an additional \$160.00 Sunday Sales Permit (A.M.) fee is required. Sunday Sales Permit (A.M.) and/or Sunday Sales Permit (P.M.) fees will be required for each date that is a Sunday. **If you request a Special License for on-premises consumption AND for a Wine Auction both on the same date at the same location, you are requesting two (2) separate licenses and you must pay a license fee for both licenses.**

For Organizations established one year or more - a \$25.00 Special License base fee for each separate, consecutive day of the event is required. If the event is held on a Sunday and spirits will be served after 12:00 Noon, an additional \$3.75 Sunday Sales Permit (P.M.) fee is required. In addition, if any alcoholic beverages, including beer, wine, and spirits, will be served between 7:00AM and 12:00 Noon, an additional \$160.00 Sunday Sales Permit (A.M.) fee is required. Sunday Sales Permit (A.M.) and/or Sunday Sales Permit (P.M.) fees will be required for each date that is a Sunday. **If you request a Special License for on-premises consumption AND for a Wine Auction both on the same date at the same location, you are requesting two (2) separate licenses and you must pay a license fee for both licenses.**

The fees must be paid by check, bank or postal money order, or by credit card, using the attached Credit Card Authorization Form (LCC-300). Checks and money orders should be made payable to **State of Michigan**.

Part 3 Continued - Special License Fees Calculation

Special License Base Fee: <i>(per Special License requested)</i>	50 ⁰⁰
x Number of Special Licenses:	1
= Special License Fees: <i>MLCC Fee Code: 4008</i>	
+ Sunday Sales Permit (P.M.) Fees: <i>MLCC Fee Code: 4032</i>	
+ Sunday Sales Permit (A.M.) Fee: <i>MLCC Fee Code: 4033</i>	
= TOTAL FEES DUE:	50 ⁰⁰

If you request a Special License for on-premises consumption AND for a Wine Auction both on the same date at the same location, you are requesting two (2) separate licenses and you must pay a license fee for both licenses.

Make checks payable to:
State of Michigan

Leave Blank - MLCC Use Only

Part 4 - Signatures of Applicant Organization's Officers, Witnesses, and Notary

Pursuant to administrative rule R 436.575, the president and secretary of the organization making application shall sign the application and the signatures shall be notarized. Political candidates only need to sign the president section and have it notarized.

By signing below the applicant organization's officers attest that:

We certify that all profits from the sale of beer, wine and/or spirits or from a wine auction will go to the applicant organization and not to any individual. We further certify that any license issued by the Michigan Liquor Control Commission is a contract subject to suspension or revocation by the Commission, that there shall be no liability on the part of the State of Michigan, the Commission, or any of its officers or employees by reason of such suspension or revocation, and that the granting of the license does not create a vested right.

Under administrative rule R 436.1003, the licensee shall comply with all state and local building, plumbing, zoning, sanitation, and health laws, rules, and ordinances as determined by the state and local law enforcements officials who have jurisdiction over the licensee. Approval of this application by the Michigan Liquor Control Commission does not waive any of these requirements. The licensee must obtain all other required state and local licenses, permits, and approvals for this business before using this license for the sale of alcoholic liquor on the licensed premises.

We certify that the information contained in this form is true and accurate to the best of our knowledge and belief. We agree to comply with all requirements of the Michigan Liquor Control Code and Administrative Rules. We also understand that providing **false** or **fraudulent** information is a violation of the Liquor Control Code pursuant to MCL 436.2003.

A completed Special License application must be submitted as early as possible before your event(s) to avoid any delays in processing. It is strongly recommended that you submit the application as soon as you know the date of your event(s). Failure to submit a completed application at least ten (10) business days prior to the event(s) may result in no Special License being issued, pursuant to administrative rule R 436.575.

Print Name and Phone Number of President _____ Signature of President _____ Date _____

Print Name of Notary _____ Signature of Notary _____ Date _____

Notary Public, State of Michigan, County of	▼	Acting in the County of	▼
My commission expires			

Print Name and Phone Number of Secretary _____ Signature of Secretary _____ Date _____

Print Name of Notary _____ Signature of Notary _____ Date _____

Notary Public, State of Michigan, County of	▼	Acting in the County of	▼
My commission expires			

Part 5 - Local Law Enforcement Approval*

The local law enforcement agency with primary jurisdiction over the event location must complete this section.

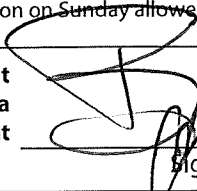
Name of law enforcement agency: Oakland County Sheriff Office	
Name & title of reviewing officer: <u>Bart Wilson</u> <u>CAPTAIN</u>	
Phone number of officer: <u>248-537-3501</u>	Email of officer: <u>WILSONRE@OakGov.com</u>
If event will be held on a Sunday, is the sale of alcohol from 7:00am to 12:00 Noon on Sunday allowed in this local governmental unit? <input type="radio"/> Yes <input checked="" type="radio"/> No	
If the event will be held on a Sunday, is the sale of alcohol after 12:00 Noon on Sunday allowed in this local governmental unit? <input type="radio"/> Yes <input checked="" type="radio"/> No	
I certify that I have reviewed the application of the applicant organization for a Special License and approve the issuance of a Special License by the Michigan Liquor Control Commission at the proposed event location.	
 Signature of Reviewing Officer <u>7-22-21</u> Date 	

Part 6 - Church/School Consent (If Applicable)*

If the event location is located within 500 feet of a church or school, the applicant organization must obtain the consent of the church or school. A church or school within 500 feet of the event location may object based on such the sale of alcohol at the location adversely affecting the church or school's operations. If a proper objection is filed, the Commission shall hold a hearing to determine whether the granting of the application will adversely affect the operation of the church or school.

Name of church or school:	
Address of church or school:	
City:	Zip Code:
Phone number:	Email:
Name of clergy member or superintendent:	
I, the authorized representative of the above named church or school, state that the church or school has no objection to the issuance of a Special License to the applicant organization at its proposed event location.	
 Signature of Clergy Member or Superintendent Date	

***Please note: the Commission has the sole and only right to approve or deny this request for a Special License.**

Part 7 - Existing On-Premises Licensee Escrow Request (If Applicable)

If the event location is currently licensed with an on-premises license, the licensee must request that its license be placed into escrow for the date(s) and time(s) of the Special Licenses issued for use at the event location requested on this application. If the existing license would prefer to temporarily drop space from its licensed premises, it must submit a letter to the Commission requesting to drop space temporarily from its licensed premises during the event date(s) and time(s), accompanied by a diagram showing the area where the license will temporarily drop space from its licensed premises to accommodate the applicant organization.

Name of licensee:	Business ID Number:
Type of license held at this location (e.g. Class C, Club, Tavern, etc.):	
Phone number:	Email:
Name of authorized signer for licensee:	
I, the authorized signer, for the above named on-premises licensee, request that the licensee's licenses at this location be placed into escrow during the date(s) and time(s) specified for the Special Licenses issued for use at this location.	
 Signature of Authorized Signer for Licensee Date	



Michigan Department of Licensing and Regulatory Affairs
 Liquor Control Commission (MLCC)
 Constitution Hall - 525 W. Allegan, Lansing, MI 48933
 Mailing Address: P.O. Box 30005, Lansing, MI 48909
 Toll-Free: 866-813-0011 - www.michigan.gov/lcc

Business ID: _____
 Request ID: _____
 (For MLCC Use Only)

Certified Resolution of the Membership or Board of Directors Authorizing the Application for Special License

(Required under Administrative Rule R 436.576 - Not Required for Candidate Committee)

At a Regular Special meeting of the Membership Board of Directors

called to order by _____ on _____ at _____
 (Date) (Time)

the following resolution was offered:

Moved by _____ and supported by _____

that the application from _____
 (Name of Organization)

for a Special License to serve alcohol on September 18, 2021
 (Event Date or Dates)

to be located at The Rochester Hills Museum at Van Hoosen Farm-1005 Van Hoosen Road Rochester Hills MI 48306
 (Physical Address - Include Location Name, Street Address, City, State, & Zip Code)

It is the consensus of this body that the application be _____ for issuance.
 (Recommended or Not Recommended)

Approval Vote Tally

Yeas: _____

Nays: _____

Absent: _____

Certification by Authorized Officer of Organization:

I hereby certify that the foregoing is true and is a complete copy of the resolution offered and adopted by the

Membership Board of Directors at a Regular Special meeting held on _____
 (Date)

 Print Name & Title of Authorized Officer

 Signature of Authorized Officer

 Date



Michigan Department of Licensing and Regulatory Affairs

Liquor Control Commission (MLCC)

Constitution Hall - 525 W. Allegan, Lansing, MI 48933

Mailing Address: P.O. Box 30005, Lansing, MI 48909

Toll-Free: 866-813-0011 - www.michigan.gov/lcc

Business ID: _____

Request ID: _____

(For MLCC Use Only)

Wine Auction Special License Wine Donation Record

List the name and address of each person that has donated wine to the applicant organization for the wine auction and list the brand(s) and quantity donated. The applicant organization shall not accept donations of wine from a business licensed by the Michigan Liquor Control Commission. An authorized officer of the applicant organization must sign this donation record form.

Applicant organization:			Wine auction date:
Donor Name	Donor Address	Wine Brand(s) Donated	Quantity Donated

Signature of Authorized Officer

I hereby certify that all persons listed above have donated wine to the applicant organization listed above for this wine auction, to be conducted pursuant to the Michigan Liquor Control Code, MCL 436.1527. The persons listed above have donated wine to the applicant organization as individuals and not for or on behalf of any retail or nonretail business licensed by the Michigan Liquor Control Commission.

_____ **Print Name of Authorized Officer** _____ **Signature of Authorized Officer** _____ **Date**



LARA Revenue Services is not a part of the Michigan Liquor Control Commission (see note below).

Credit Card Authorization Form

** FAX COMPLETED FORM TO SECURE FAX LINE: 517-284-8557 **

** DO NOT EMAIL OR MAIL THIS FORM **

Requests with credit card payments that are not faxed to the above secure fax line will be destroyed along with the credit card authorization in order to ensure the security of applicants' personal credit card numbers.

IF YOU ARE NOT SUBMITTING AN APPLICATION FORM WITH THIS CREDIT CARD AUTHORIZATION, YOU MUST PROVIDE AN ITEMIZATION OF THE FEES FOR WHICH YOU ARE SUBMITTING PAYMENT OR YOUR PAYMENT WILL NOT BE PROCESSED

Name on Card: Jenna Raschke

Payment Amount: \$50.00

Billing Address: 1000 Rochester Hills Drive

Card Number: 5569269001645509

City: Rochester Hills MI State: MI Zip Code: 48309

Check One:

Phone: 2488412674

MasterCard Visa Discover

Email: raschkej11@gmail.com

Security Code/CVV Code: 776

Applicant/Licensee Name: Request or Business ID #:

Expiration Date: 10/22

The Rochester Hills Musuem at Van Hoc

Payment is for:

Special license application

Signature

IF YOU ARE NOT SUBMITTING AN APPLICATION FORM WITH THIS CREDIT CARD AUTHORIZATION, YOU MUST PROVIDE AN ITEMIZATION OF THE FEES FOR WHICH YOU ARE SUBMITTING PAYMENT OR YOUR PAYMENT WILL NOT BE PROCESSED.

Credit Card Payment Itemization:

Table with 3 columns: Fee Type, Fee Amount, MLCC Fee Code. Rows include Inspection Fee(s), Special License Fee(s), Temporary Authorization Fee, License Renewal Fee(s), Manufacturer License(s), Wholesaler License(s), New Retailer License(s), Transfer Retailer License(s), Conditional License, New Add Bar / Transfer Add Bar, Sunday Sales Permit (AM/PM), and Catering Permit.

LARA Revenue Services is not a part of the Michigan Liquor Control Commission (MLCC). Receipt of payment and application forms by LARA Revenue Services does not constitute receipt of an application by the MLCC. Applications submitted through LARA Revenue Services may take up to two (2) additional business days to be received by the MLCC after receipt by LARA Revenue Services.

For requests that require a timely receipt of an application by the MLCC to be processed, such as Special Licenses and temporary requests, please ensure that your application will be received in adequate time to be processed by the MLCC after the payment is received and processed by LARA Revenue Services.

Outdoor Service Area

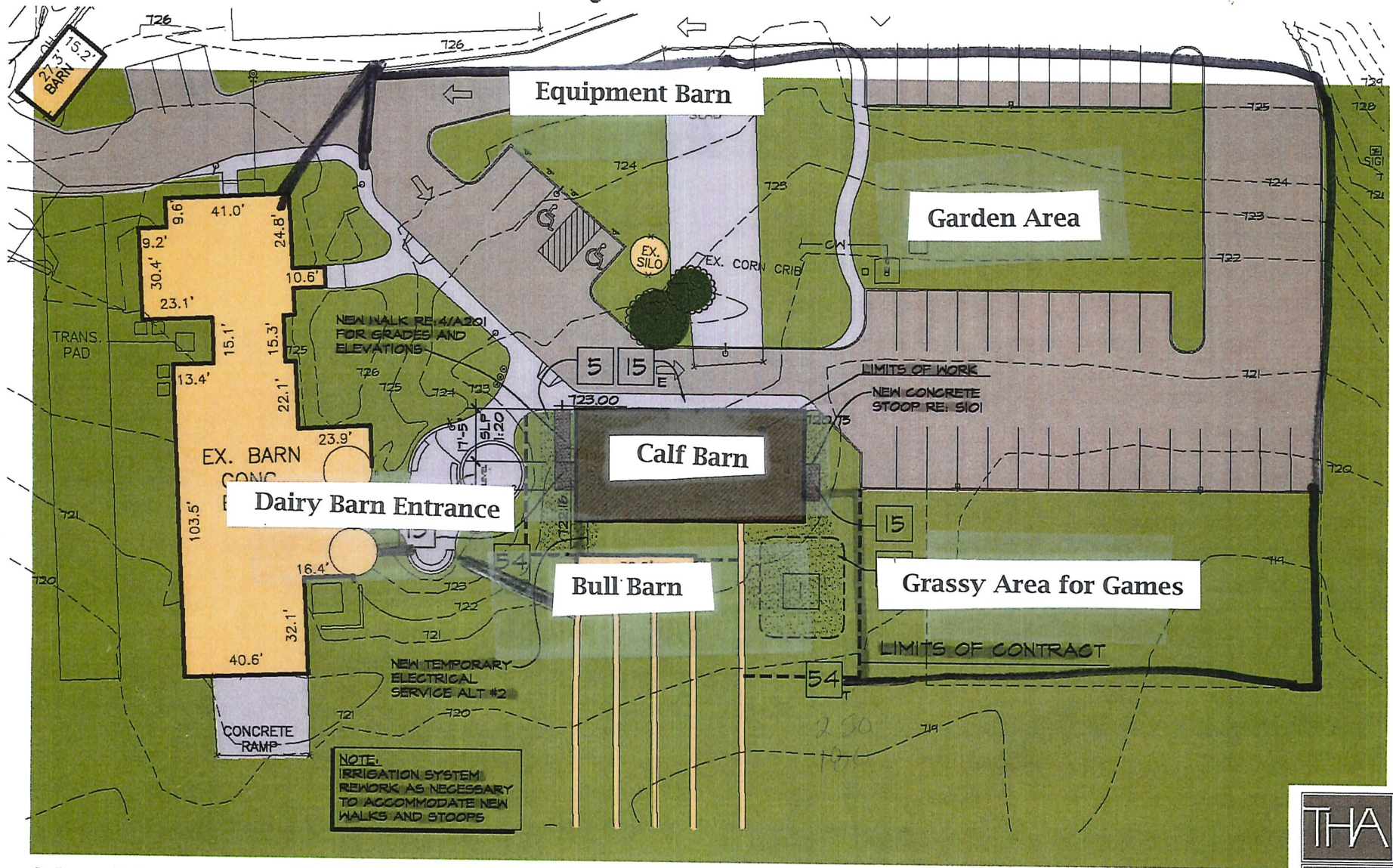

Van Hoosen Calf Barn

Rochester, Michigan



1"=30'-0"

Barricades -



* we will connect them for the event.

INTERNAL REVENUE SERVICE
P. O. BOX 2508
CINCINNATI, OH 45201

DEPARTMENT OF THE TREASURY

Date: **AUG 11 2014**

ROCHESTER HILLS MUSEUM FOUNDATION
C/O PATRICK MCKAY
1000 ROCHESTER HILLS DR
ROCHESTER HILLS, MI 48309

Employer Identification Number:
36-4754913
DIN:
17053310306003
Contact Person: CUSTOMER SERVICE ID# 31954
Contact Telephone Number:
(877) 829-5500
Accounting Period Ending:
December 31
Public Charity Status:
170(b)(1)(A)(vi)
Form 990 Required:
Yes
Effective Date of Exemption:
March 5, 2013
Contribution Deductibility:
Yes
Addendum Applies:
No

Dear Applicant:

We are pleased to inform you that upon review of your application for tax exempt status we have determined that you are exempt from Federal income tax under section 501(c)(3) of the Internal Revenue Code. Contributions to you are deductible under section 170 of the Code. You are also qualified to receive tax deductible bequests, devises, transfers or gifts under section 2055, 2106 or 2522 of the Code. Because this letter could help resolve any questions regarding your exempt status, you should keep it in your permanent records.

Organizations exempt under section 501(c)(3) of the Code are further classified as either public charities or private foundations. We determined that you are a public charity under the Code section(s) listed in the heading of this letter.

For important information about your responsibilities as a tax-exempt organization, go to www.irs.gov/charities. Enter "4221-PC" in the search bar to view Publication 4221-PC, Compliance Guide for 501(c)(3) Public Charities, which describes your recordkeeping, reporting, and disclosure requirements.

Sincerely,



Director, Exempt Organizations