

TSC ID AND SIGN DESCRIPTION	MOUNTING LOCATION	TYP. MOUNTING METHOD
G5 - POLE SIGN: ONLINE ORDER PICK UP (18" X 24")	RIGHT SIDE OF GARDEN CENTER MAN DOOR	ON 2.5" DIA. GALVANIZED METAL POLE USING U-BOLTS
G6 - POLE SIGN: FEED, FENCING & MORE (18" X 24")	RIGHT SIDE OF FEED ROOM OVERHEAD DOOR	ON 2.5" DIA. GALVANIZED METAL POLE USING U-BOLTS

*CONFIRM EXACT LOCATION WITH FINAL FIXTURE PLAN

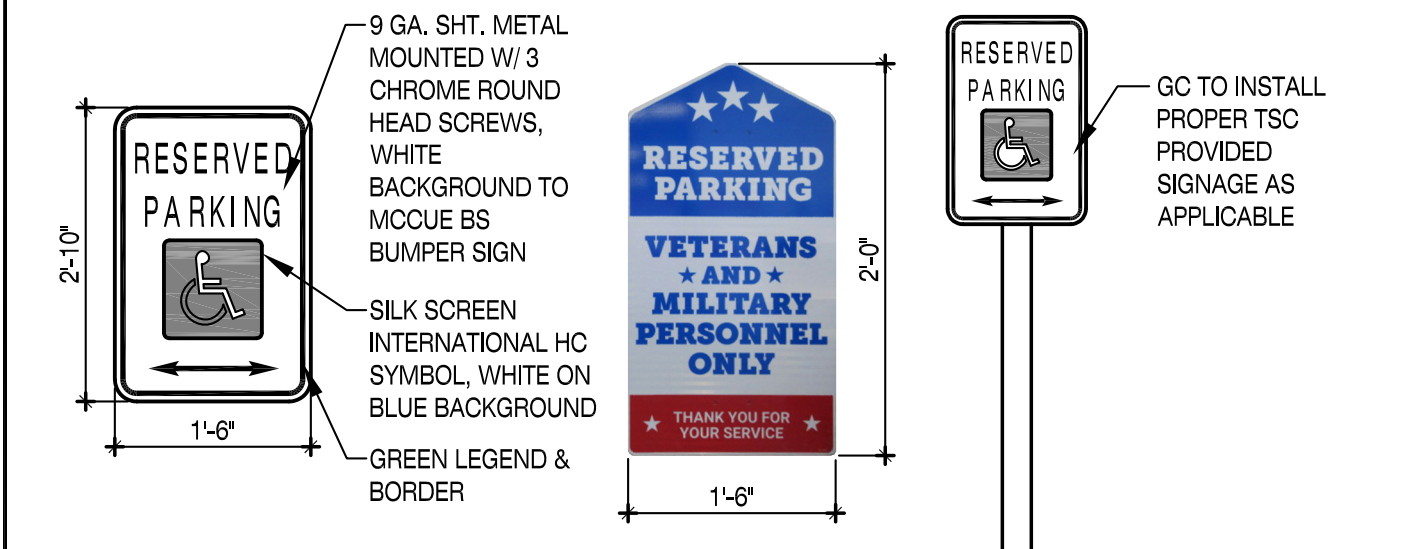

4 DETAIL HANDICAP & TSC VERTICAL SIGNAGE SCALE: NOT TO SCALE

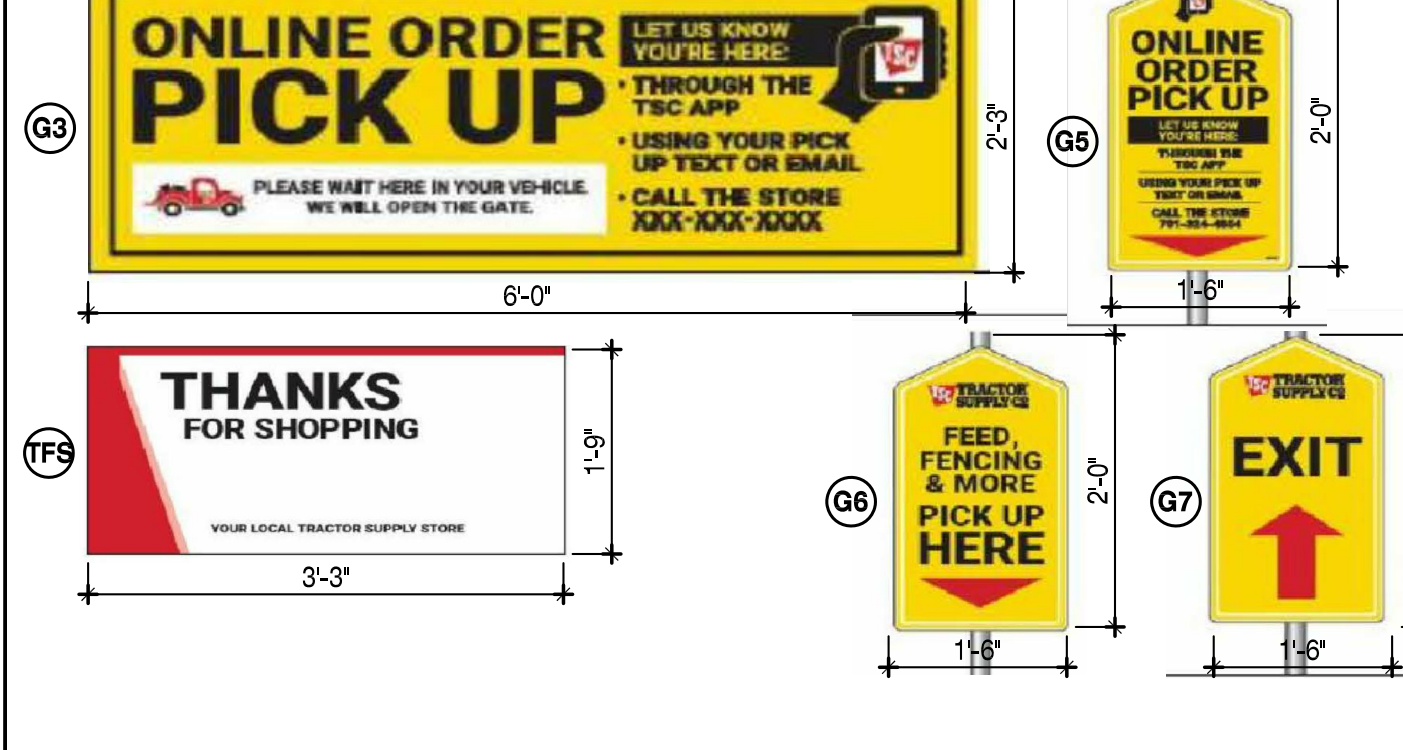
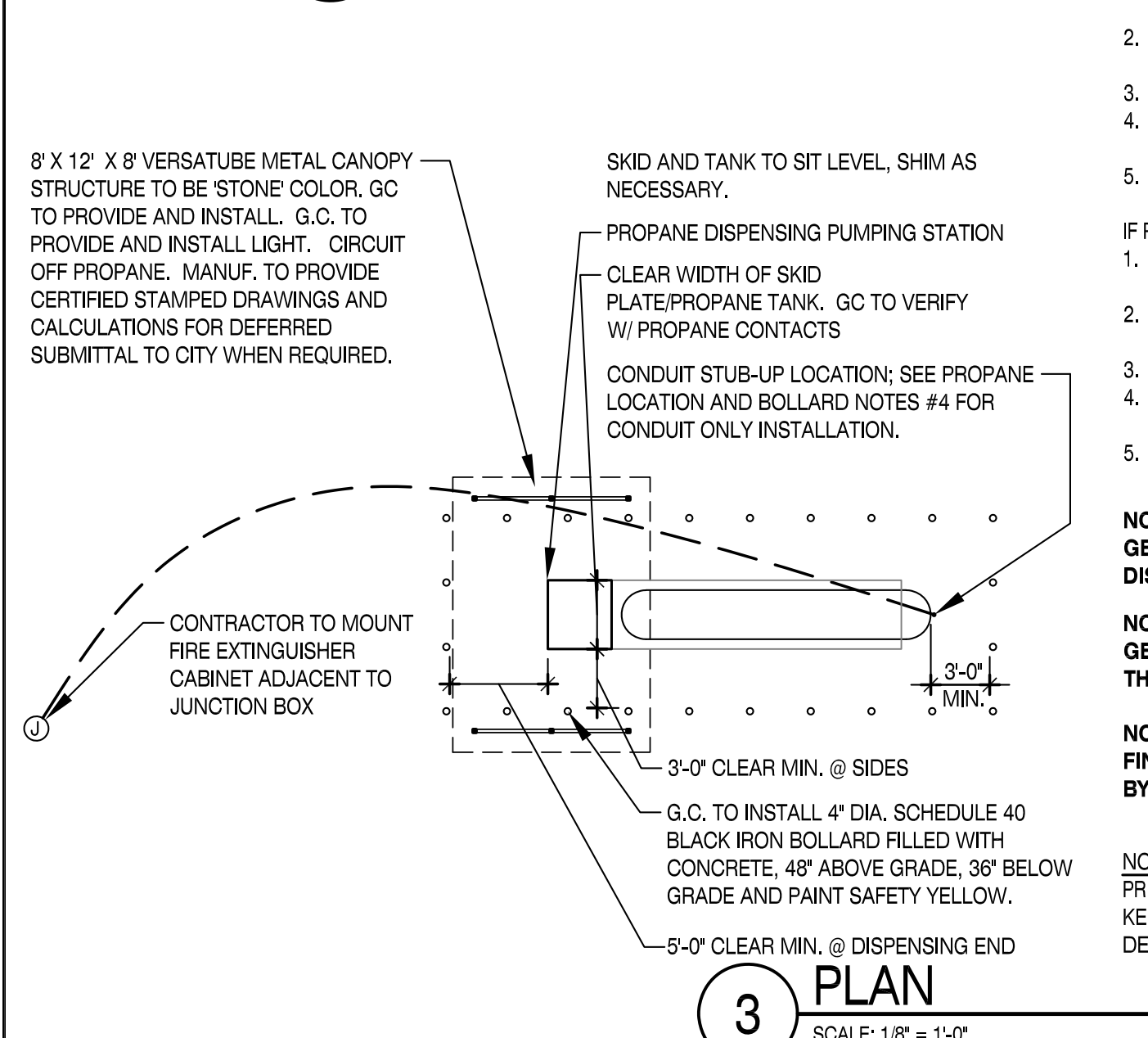

3 PLAN SCALE: 1/8" = 1'-0"



2 SITE PLAN SCALE: NO SCALE ROCHESTER HILLS, MI

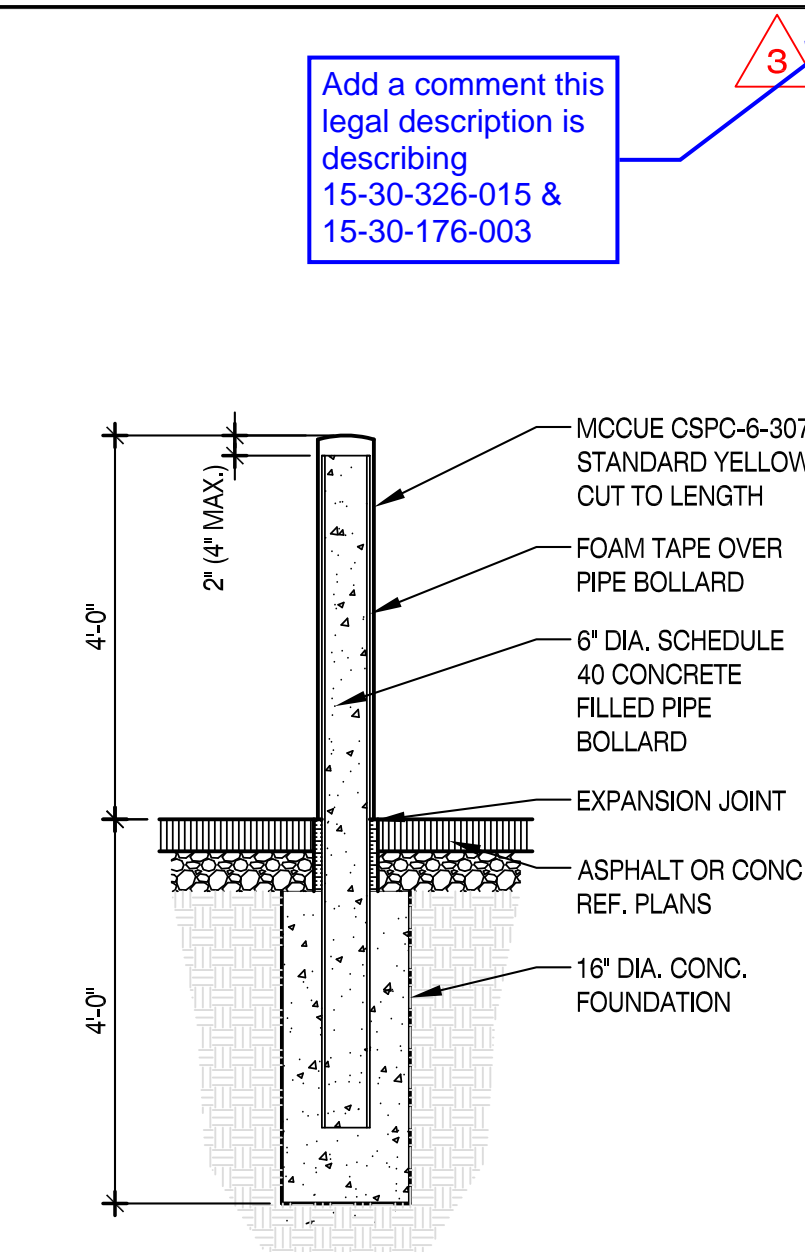

6 DETAIL TYPICAL BOLLARD SCALE: 1" = 1'-0"

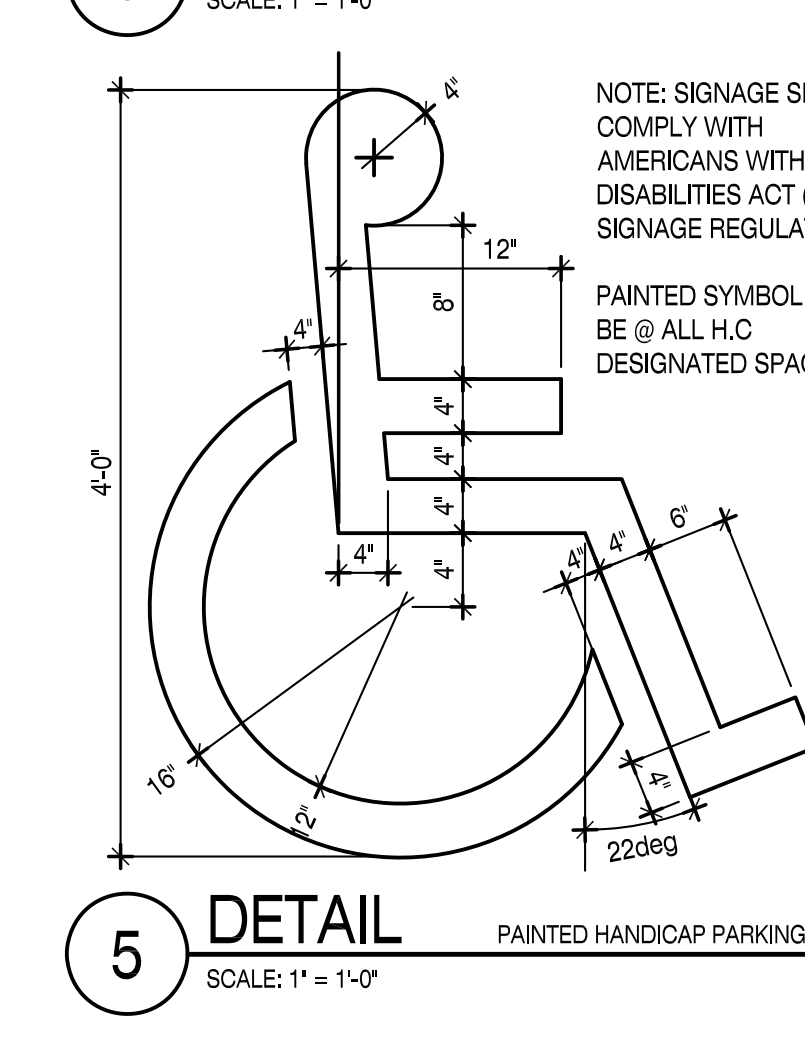

5 DETAIL PAINTED HANDICAP PARKING LOGO SCALE: 1" = 1'-0"

PROpane RESPONSIBILITY NOTES:

- IF PROPANE TANK IS DELIVERED **PRIOR TO FIXTURE DATE:**
 - GENERAL CONTRACTOR IS RESPONSIBLE FOR INFRASTRUCTURE RELATED TO PROPANE TANK INSTALLATION.
 - GENERAL CONTRACTOR IS RESPONSIBLE FOR ELECTRICAL PERMITTING AND FINAL CONNECTION TO PUMP DISPENSING CONTROL PANEL.
 - AMERIGAS OR OTHER SPECIFIED PROPANE PROVIDER IS RESPONSIBLE FOR GAS PERMITTING OF THE TANK.
 - AMERIGAS OR OTHER SPECIFIED PROPANE PROVIDER IS RESPONSIBLE FOR INSTALLATION AND FINAL GAS CONNECTION OF THE TANK.
 - SEE ELECTRICAL SHEET E1B.0 FOR ADDITIONAL NOTES AND DETAILS.
- IF PROPANE TANK IS DELIVERED **AFTER FIXTURE DATE:**
 - GENERAL CONTRACTOR IS RESPONSIBLE FOR INFRASTRUCTURE RELATED TO PROPANE TANK INSTALLATION.
 - AMERIGAS OR OTHER SPECIFIED PROPANE PROVIDER IS RESPONSIBLE FOR ELECTRICAL PERMITTING AND FINAL CONNECTION TO PUMP DISPENSING CONTROL PANEL.
 - AMERIGAS OR OTHER SPECIFIED PROPANE PROVIDER IS RESPONSIBLE FOR GAS PERMITTING OF THE TANK.
 - AMERIGAS OR OTHER SPECIFIED PROPANE PROVIDER IS RESPONSIBLE FOR INSTALLATION AND FINAL GAS CONNECTION OF THE TANK.
 - SEE ELECTRICAL SHEET E1B.0 FOR ADDITIONAL NOTES AND DETAILS.

NOTE: GENERAL CONTRACTOR TO CONTACT PLAN EXPRESS FOR PROPANE TANK POWER-OPERATED DISPENSING DEVICE FOR LPG-GAS CUT-SHEET PDF DOCUMENT.

NOTE: GENERAL CONTRACTOR TO VERIFY LOCATION OF PROPANE TANK AND CONDUIT STUB-UP WITH THE TSC PROJECT MANAGER PRIOR TO CONDUIT INSTALLATION.

NOTE: FINAL FIXTURE PLAN TO BE DEVELOPED BY TSC. FIXTURES ARE SUPPLIED BY TSC AND INSTALLED BY TSC VENDOR.

NOTE: PRIMARY ARCHITECT TO SUBMIT BASE SHEET, SITE PLAN AND CEILING HEIGHT TO: KEN MARSH - kmarsh@tractorsupply.com DEANA CALHOUN - decalhou@tractorsupply.com

LEGAL DESCRIPTION

PROPERTY SITUATED IN THE CITY OF ROCHESTER HILLS, COUNTY OF OAKLAND AND STATE OF MICHIGAN, DESCRIBED AS FOLLOWS:

A PARCEL OF LAND LOCATED IN SECTION 30, TOWN 3 NORTH, RANGE 11 EAST, CITY OF ROCHESTER HILLS OAKLAND COUNTY, MICHIGAN MORE PARTICULARLY DESCRIBED AS: COMMENCING AT THE EAST 1/4 CORNER OF SAID SECTION 30 AND PROCEEDING ALONG THE EAST AND WEST 1/4 LINE OF SAID SECTION 30 SOUTH 85 DEG 45' 09" WEST 942.80 FEET; THENCE THE FOLLOWING TWO (2) COURSES ALONG A MICHIGAN DEPARTMENT OF TRANSPORTATION (M.D.O.T.) RIGHT OF WAY: 1) SOUTH 32 DEG. 42' 01" EAST 26.68 FEET AND 2) SOUTH 65 DEG. 18' 11" WEST 288.97 FEET; THENCE SOUTH 24 DEG. 39' 28" EAST 35.10 FEET TO A POINT ON THE NORTHERLY RIGHT OF WAY LINE OF ADAMS ROAD (VARIABLE WIDTH) AND ALONG SAID RIGHT OF WAY LINE SOUTH 63 DEG. 06' 17" WEST 899.04 FEET TO THE POINT OF BEGINNING; THENCE FROM SAID POINT OF BEGINNING CONTINUING ALONG SAID RIGHT OF WAY LINE OF ADAMS ROAD THE FOLLOWING FOUR (4) COURSES: 1) SOUTH 63 DEG. 06' 17" WEST 660.67 FEET 2) 420.15 FEET ALONG THE ARC OF A CURVE TO THE RIGHT, RADIUS 1325.00 FEET CENTRAL ANGLE 18 DEG. 10' 09" AND A CHORD THAT BEARS SOUTH 72 DEG. 11' 19" WEST 418.38 FEET, 3) SOUTH 04 DEG. 43' 39" EAST 15.00 FEET 4) 19.46 FEET ALONG THE ARC OF A CURVE TO THE RIGHT, RADIUS 1340.00 FEET, CENTRAL ANGLE 00 DEG. 49' 55" AND A CHORD THAT BEARS SOUTH 81 DEG. 41' 19" WEST 19.46 FEET; THENCE NORTH 07 DEG. 47' 53" EAST 124.46 FEET; THENCE NORTH 82 DEG. 12' 07" WEST 354.24 FEET; THENCE NORTH 08 DEG. 30' 03" EAST 157.80 FEET; THENCE 31.64 FEET ALONG THE ARC OF A CURVE TO THE RIGHT, RADIUS 450.00 FEET, CENTRAL ANGLE 04 DEG. 01' 44" AND A CHORD THAT BEARS NORTH 10 DEG. 30' 55" EAST 31.64 FEET; THENCE 43.77 FEET ALONG A REVERSE CURVE TO THE LEFT, RADIUS 530.00 FEET, CENTRAL ANGLE 04 DEG. 43' 54" AND A CHORD THAT BEARS NORTH 10 DEG. 09' 50" EAST 43.76 FEET; THENCE NORTH 07 DEG. 47' 53" EAST 121.81 FEET; THENCE 182.21 FEET ALONG THE ARC OF A CURVE TO THE LEFT, RADIUS 530.00 FEET, CENTRAL ANGLE 19 DEG. 41' 51" AND A CHORD THAT BEARS NORTH 02 DEG. 03' 02" WEST 181.31 FEET; THENCE NORTH 11 DEG. 53' 58" WEST

81.82 FEET; THENCE 416.85 FEET ALONG THE ARC OF A CURVE TO THE RIGHT, RADIUS 288.00 FEET, CENTRAL ANGLE 82 DEG. 55' 49" AND A CHORD THAT BEARS NORTH 29 DEG. 39' 56" EAST 381.41 FEET; THENCE NORTH 71 DEG. 01' 50" EAST 401.11 FEET; THENCE 228.25 FEET ALONG THE ARC OF A CURVE TO THE RIGHT, RADIUS 238.00 FEET, CENTRAL ANGLE 54 DEG. 56' 55" AND A CHORD THAT BEARS SOUTH 81 DEG. 29' 43" EAST 219.60 FEET; THENCE SOUTH 54 DEG. 01' 19" EAST 214.73 FEET; THENCE 237.85 FEET ALONG THE ARC OF A CURVE TO THE RIGHT, RADIUS 480.00 FEET, CENTRAL ANGLE 28 DEG. 23' 37" AND A CHORD THAT BEARS SOUTH 39 DEG. 49' 30" EAST 325.43 FEET; THENCE SOUTH 25 DEG. 37' 49" EAST 482.12 FEET; THENCE SOUTH 18 DEG. 44' 16" WEST 28.60 FEET TO THE POINT OF BEGINNING.

TOGETHER WITH RIGHTS RECITED IN THE RECIPROCAL EASEMENT AND OPERATION AGREEMENT RECORDED IN LIBER 38003, PAGE 527, AS MODIFIED BY FIRST AMENDMENT THERETO RECORDED IN LIBER 39684, PAGE 62 AND ALSO RECIPROCAL EASEMENT AGREEMENT BETWEEN THE MARKET PLACE OF ROCHESTER HILLS, PARCEL B, L.L.C. AND FLAGSTAR BANK, DATED AUGUST 28, 2007 AND RECORDED IN LIBER 39618, PAGE 400, OAKLAND COUNTY RECORDS.

AND A PARCEL OF LAND LOCATED IN THE SOUTHWEST 1/4 OF SECTION 30, TOWN 3 NORTH, RANGE 11 EAST, CITY OF ROCHESTER HILLS, OAKLAND COUNTY, MICHIGAN, MORE PARTICULARLY DESCRIBED AS: COMMENCING AT THE WEST 1/4 CORNER OF SAID SECTION 30 (AS REMONUMENTED); THENCE SOUTH 85 DEG. 49' 02" WEST 1.93 FEET ALONG THE WESTERLY

EXTENSION OF THE EAST AND WEST 1/4 LINE OF SECTION 30 TO A PROPERTY CONTROLLING CORNER (FORMERLY DESCRIBED AS THE WEST 1/4 CORNER OF SECTION 30); THENCE PROCEEDING ALONG THE WEST PROPERTY CONTROLLING LINE OF SAID SECTION 30 (AS MONUMENTED) FORMERLY DESCRIBED AS THE WEST LINE OF SAID SECTION 30 ALSO BEING THE CENTERLINE OF ADAMS ROAD (VARIABLE WIDTH) THE FOLLOWING TWO (2) COURSES: 1) SOUTH 01 DEG. 30' 03" EAST 385.17 FEET AND 2) SOUTH 02 DEG. 09' 12" EAST 532.96 FEET; THENCE NORTH 85 DEG. 38' 28" EAST 271.46 FEET TO A POINT ON THE SOUTHERLY RIGHT OF WAY OF ADAMS ROAD (VARIABLE WIDTH) SAID POINT ALSO BEING THE POINT OF BEGINNING; THENCE FROM SAID POINT OF BEGINNING THE FOLLOWING TWO (2) COURSES ALONG SAID SOUTHERLY RIGHT OF WAY: 1) 753.14 FEET ALONG THE ARC OF A CURVE TO THE RIGHT, RADIUS 760.00 FEET, CENTRAL ANGLE 56 DEG. 46' 43" AND A CHORD THAT BEARS NORTH 70 DEG. 08' 42" EAST 722.70 FEET AND 2) SOUTH 81 DEG. 28' 57" EAST 337.76 FEET; THENCE SOUTH 03 DEG. 10' 24" EAST 118.34 FEET; THENCE SOUTH 85 DEG. 38' 28" WEST 1023.15 FEET TO THE POINT OF BEGINNING.

TOGETHER WITH RIGHTS RECITED IN THE RECIPROCAL EASEMENT AND OPERATION AGREEMENT RECORDED IN LIBER 38003, PAGE 527, AS MODIFIED BY FIRST AMENDMENT THERETO RECORDED IN LIBER 39684, PAGE 62.

THIS SURVEY DESCRIBES AND DEPCTS THE SAME LAND AS DESCRIBED IN THE TITLE COMMITMENT AS REFERENCED ABOVE.

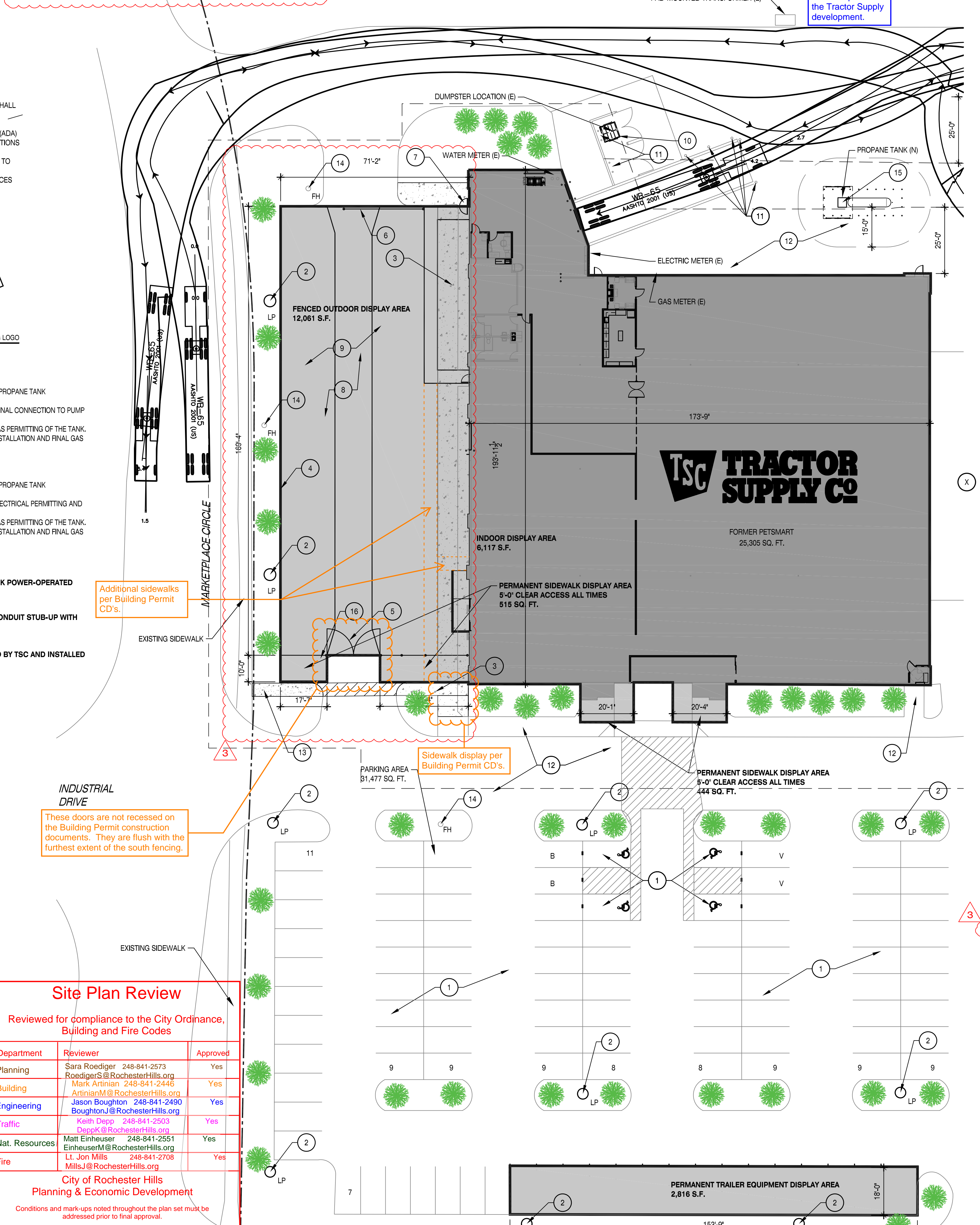

GUIDELINES TSC'S CONTRACTOR CONSTRUCTION NOTES (FOR DETACHED FENCED OUTDOOR DISPLAY AREA)

PERIMETER OF NEW FOOT LOCATION TO BE MARKED WITH ORANGE BARRICADE FENCING AND/OR CAUTION TAPE OR SIMILAR CLOSE-OFF MATERIALS TO PREVENT THE PARKING OF VEHICLES WITHIN THE WORK ZONE FOR FENCE CONSTRUCTION. SHOULD CARS BE PRESENT WITHIN THE CONSTRUCTION ZONE, A NOTE IS TO BE PLACED ON THE VEHICLE INDICATING THE INTENT TO CONSTRUCT WITH A DATE OF COMMENCEMENT FOR SAID CONSTRUCTION AND THE TSC PM SHALL BE CONTACTED IMMEDIATELY TO DETERMINE A PLAN OF ACTION TO RESOLVE.

GUIDELINES TSC'S CONTRACTOR CONSTRUCTION NOTES (FOR FENCED OUTDOOR DISPLAY AREA FIXTURE INSTALLATION)

- CONTRACTOR TO VERIFY WITH THE STORE MANAGER THAT ALL RACKS ARE PROPERLY BUILT AND POSITIONED.
- DRILL HOLES FOR ANCHORING RACK. GENERALLY THE HOLE IN THE FOOT OF THE RACK IS 1/2" IN DIAMETER, HOWEVER, THIS MAY VARY. GENERAL CONTRACTOR IS TO DETERMINE IN THE FIELD THE MOST APPROPRIATE SIZE REQUIRED TO ANCHOR RACKS.
- RACKS ARE TO BE SECURELY ANCHORED WITH ANCHOR BOLTS IN EVERY AVAILABLE HOLE.
- FOLLOWING INSTALLATION, REMOVE ANY RESIDUAL DEBRIS AND CLEAN AREA.

SPECIFICATIONS TSC'S CONTRACTOR CONSTRUCTION NOTES (FOR NEW 8 FOOT GALVANIZED CHAIN-LINK FENCE):

- FABRIC: 192' / 9' 9" GA. GALVANIZED (2" MESH) CHAIN LINK FABRIC.
- TOP, INTERMEDIATE, & BOTTOM RAIL: 1 5/8" O.D. FULL WEIGHT PIPE, 2.27 LBS. PER FOOT (MIN). TOP RAIL TO BE JOINED WITH 1 5/8" SLEEVE. BOTTOM RAIL @ 18" ABV. GRADE.
- LINE POST: 2 1/2" O.D. FULL WEIGHT PIPE, 3.65 LBS. PER FOOT (MIN). LINE POST TO BE SET 10" ON CENTER MAX. SPACING. CONCRETE FOOTING TO BE 8" DIA. BY 30" DEEP CONC.
- TERMINAL POST: 3" O.D. FULL WEIGHT PIPE, 5.79 LBS. PER FOOT (MIN). SET IN 8" DIA. BY 36" DEEP CONC. FOOTING.
- GATE POST: 4" O.D. FULL WEIGHT PIPE, 9.10 LBS. PER FOOT (MIN), 8" DIA. 36" DEEP CONC. FOOTING.
- GATES: (2) 10 FOOT SWINGING CHAIN LINK GATES, (1) 20 FOOT SLIDING CHAIN LINK GATE AND (1) 4 FOOT SWING GATE, WITH FRAMEWORK OF 1 5/8" FULL WEIGHT PIPE, 2.27 LBS. PER FOOT (MIN), GATES BRACED AND TRUSSED AS NECESSARY, SAME FABRIC AS FENCE. SEE PLAN FOR WIDTH.
- SWING GATES: DESIGN AS PER THE MANUFACTURERS DESIGN STANDARDS. GATES SHALL BE MANUALLY OPERATED.
- TENSION WIRE: 7 GA. COIL SPRING GALVANIZED TENSION WIRE ATTACHED TO BOTTOM OF FENCE FABRIC WITH 9 GA. ALUM. HOG RING SPACED 24" ON CENTER.
- FITTINGS: HEAVY BRACED BAND AND CARRIAGE BOLT, PRESSED STEEL RAIL-END, PRESSED STEEL BUSH, PRESSED STEEL CAP, 1/4" X 3/4" TENSION BAR, HEAVY TENSION BAND AND CARRIAGE BOLT.
- THE WIRE: 8 1/4" 12 GA. STEEL THE WIRE AND 6 1/2" 12 GA. STEEL WIRE SPACED 15" ON CENTER FOR LINE POST AND 24" ON CENTER FOR RAILS.
- POST FOOTING: TRUCK POURED CONCRETE.
- SWING GATE LATCH TO BE CHAIN LINK FENCE-LOC TM BY HOOVER FENCE CO. OR EQUAL AND SHALL ACCEPT PAD LOCKS.

SPECIFICATIONS TSC'S CONTRACTOR CONSTRUCTION NOTES (PARKING LOT PAINT SPECIFICATIONS - 15 MIL. APPLICATION (0.015 INCH THICKNESS)):

- NEW PAVEMENT SURFACE TO CURE FOR A PERIOD OF NOT LESS THAN 14 DAYS BEFORE APPLICATION OF MARKING MATERIALS.
- REMOVE ALL DIRT, GRAVEL, DEBRIS, VEGETATION, OR OTHER MISCELLANEOUS OBJECTS FROM THE SURFACE WITH A BROOM TRUCK OR EQUIVALENT RIGOROUS METHOD. PROVIDE A CLEAN, DUST-FREE AND COMPLETELY DRY SURFACE FOR PAINT APPLICATION. DO NOT APPLY PAINT OVER EXISTING TAPE MARKINGS.
- CONFIRM & RECORD PROPER AIR AND SURFACE TEMPERATURES OF 55° AND RISING AND LESS THAN 95°. IF THE SURFACE TEMPERATURE IS NOT WITHIN THE TEMPERATURE RANGE OR IF THE PAINT APPLICATION IS DONE UNDER ADVERSE CONDITIONS (AS DETERMINED BY THE CONSTRUCTION PROJECT MANAGER) SUCH AS ABOVE 75% HUMIDITY, NIGHT STRIPING, ETC. IN ORDER TO MEET TSC OPENING SCHEDULE, CONTRACTOR TO RE-SCHEDULE AND COMPLETE SURFACE STRIPING UNDER PROPER CONDITIONS A MINIMUM OF 30 DAYS PRIOR TO THE EXPIRATION OF THE (1) ONE YEAR CONSTRUCTION WARRANTY.
- PROVIDE A 15 MIL THICK 4" WIDE CONTINUOUS STRIPE WHERE INDICATED. MINIMUM OF (2) TWO COATS.
- PROVIDE PRIMER AND SEALER TO BE APPLIED PER THE MANUFACTURER'S RECOMMENDATIONS ON ALL CONCRETE SURFACES AND ON ASPHALT SURFACES THAT ARE MORE THAN TWO YEARS OLD, OXIDIZED AND/OR HAVE AGGREGATE EXPOSED.

KEYNOTES TSC'S CONTRACTOR CONSTRUCTION NOTES (REFER ONLY TO NOTES THAT ARE INDICATED BY NUMERICAL KEY ON PLAN):

- CONTRACTOR TO REPAIR AND RESTRIPE TSC PARKING AREA, DRIVE LANES, AND RECEIVING AREAS AS NECESSARY. BLACK OUT EXISTING LINES WHERE REQUIRED. VERIFY CONDITIONS ON SITE. RESTRIPE EXISTING OR ADD ADDITIONAL HANDICAP PARKING SPACES WHERE REQUIRED. SEE ACCESSIBILITY DETAILS THIS SHEET. PARKING SPACES AND ACCESSIBLE ROUTE TO MEET A117.1, SECTION 502.5.
- CONTRACTOR TO PLACE ALL EXISTING POLE LIGHTING IN PARKING LOT IN PROPER WORKING ORDER.
- CONTRACTOR TO INSTALL NEW CONCRETE WITH BROOM FINISH. SEE A1.0 FOR EXTENTS AND MORE INFORMATION.
- INSTALL NEW 8" FENCE AND GATES ACCORDING TO FENCE SPECIFICATIONS THIS SHEET. POSTS TO BE SET IN EXISTING CONCRETE SKIRT AND NOT EXTEND INTO EXISTING LANDSCAPING.
- 10'-0" X 8'-0" SWINGING CHAIN-LINK GATES EACH SIDE OF EACH OPENING. SEE DETAIL 11/A4.0 FOR MORE INFORMATION.
- 20' X 8'-0" SLIDING GATE AT REAR OF FENCED AREA. SEE DETAIL A4.0 FOR MORE INFORMATION.
- 4" SWING GATE WITH ALARMED DETEX PANIC HARDWARE BY DH PACE. SEE A2.0 FOR DETAIL.
- 4" PAINTED STRIPE INDICATING EXTENT OF DRIVE AISLE AND DISPLAY AREAS. YELLOW ON CONCRETE AND WHITE ON ASPHALT OR AS DETERMINED BY TSC PROJECT MANAGER. SEE PARKING LOT PAINT SPECIFICATION THIS SHEET.
- INSTALL FIXTURES IN FENCED AREA PER GUIDELINES THIS SHEET. SEE TSC FINAL FIXTURE PLAN FOR LOCATIONS.
- NEW DUMPSTER IN EXISTING DUMPSTER ENCLOSURE.
- EXISTING PIPE BOLLARD. COVER PER FINISH SCHEDULE ON A0.1.
- CONTRACTOR TO SPRAY SIDEWALK, PARKING LOT AND SCUPPER AND OVERFLOW AREAS FOR WEED REMOVAL ON PREMISES.
- CONTRACTOR TO INSTALL ACCESSIBLE RAMP AND SIDEWALK TO EXISTING SIDEWALK AT RIGHT OF WAY TO COMPLY WITH A117.1.
- EXISTING FIRE HYDRANT TO REMAIN, NO NEW HYDRANTS.
- CONTRACTOR TO INSTALL 1000 GALLON PROPANE RETAIL FILLING DISTRIBUTION TANK PER DETAIL THIS SHEET.
- CONTRACTOR TO LOCATE FENCE WITH EXISTING GATE VALVE OUTSIDE OF FENCED AREA.

Site Plan Review

Reviewed for compliance to the City Ordinance, Building and Fire Codes

Department	Reviewer	Approved
Planning	Sara Roediger 248-841-2573 RoedigerS@RochesterHills.org	Yes
Building	Mark Artiman 248-841-2446 ArtimanM@RochesterHills.org	Yes
Engineering	Jason Boughton 248-841-2490 BoughtonJ@RochesterHills.org	Yes
Traffic	Keith Depp 248-841-2503 DeppK@RochesterHills.org	Yes
Nat. Resources	Matt Einheuser 248-841-2551 EinheuserM@RochesterHills.org	Yes
Fire	Lt. Jon Mills 248-841-2708 MillsJ@RochesterHills.org	Yes

City of Rochester Hills
Planning & Economic Development
Conditions and mark-ups noted throughout the plan set must be addressed prior to final approval.



2934 Sidco Drive
Suite 139
Nashville, TN 37204

Architecture
Planning
Interior Architecture

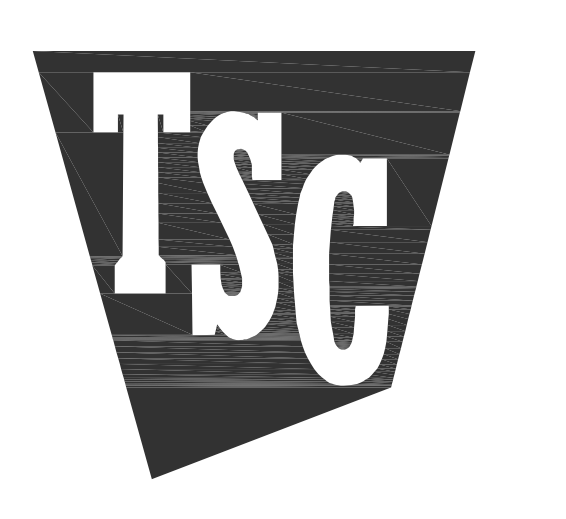

TRACTOR SUPPLY COMPANY
ROCHESTER HILLS,
MICHIGAN

2724 S. ADAMS RD

Tractor Supply Company shall not be responsible for the payment of any work performed or material supplied by the Contractor or any of its sub-contractors, sub-subcontractors and anyone claiming by through or under any of them which is not identified in writing and signed by one of the following Tractor Supply Company personnel: Vice President Real Estate, Director of Construction, or a Construction Project Manager. No action, conduct, omission, prior failure, or course of dealing by Tractor Supply Company shall act to waive, modify, change or alter the requirement that all work, whether by contract, change order or change directive, must be in writing and signed by the personnel identified in this provision. Any work performed or material provided by the Contractor, any of its sub-contractors, sub-subcontractors contrary to this provision shall be at its own risk and own expense and Tractor Supply Company shall not be obligated to reimburse or pay the Contractor or any of its sub-contractors, sub-subcontractors for same.

All measurements and items portrayed on this sheet are deemed to be accurate by architect, however all bidding General Contractors should field verify the actual conditions. Any changes to the scope of work, and thus potential change orders, should be identified and communicated in your bid submittal to TSC.

This drawing and the design shown is the property of the architect. The reproduction, copying or use of this drawing without their written consent is prohibited and any infringement will be subject to legal action.

Job Number: 2195
Date: 06.10.2022
Revisions: 3 07.18.2022
Revisions:
Revisions:
Sheet Number: AS1.0
CITY FILE #22-013 SECTION #30

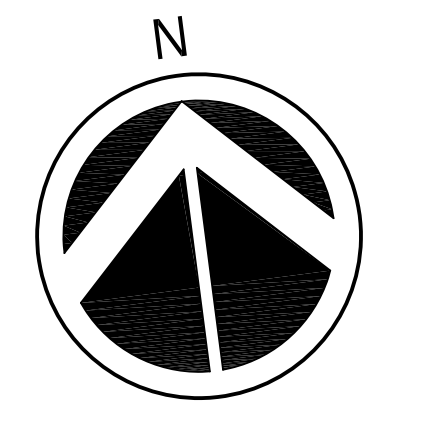



OXFORD ARCHITECTURE

2934 Sidco Drive Suite 120 Nashville, TN 37204

Architecture Planning Interior Architecture

FIRE DEPARTMENT NOTES

- 1. FIRE LANES SHALL BE DESIGNATED BY THE FIRE CODE OFFICIAL... 2. CONSTRUCTION SITES SHALL BE SAFEGUARDED... 3. OPEN BURNING IS NOT PERMITTED... 4. EXIT DOORS SHALL REMAIN FREE OF OBSTRUCTIONS...



TRACTOR SUPPLY COMPANY ROCHESTER HILLS, MICHIGAN

2724 S. ADAMS RD

Tractor Supply Company shall not be responsible for the payment of any work performed or material supplied by the Contractor or any of its sub-contractors...

All measurements and items portrayed on this sheet are deemed to be accurate by architect, however all bidding General Contractors should field verify the actual conditions...

This drawing and the design shown is the property of the architect. The reproduction, copying or use of this drawing without their written consent is prohibited...

Job Number: 2195

Date: 0610.2022

Revisions: 3 07.18.2022

Revisions:

Revisions: FIRE PROTECTION SITE PLAN

Sheet Number: FP1.0

CITY FILE #22-013 SECTION #30

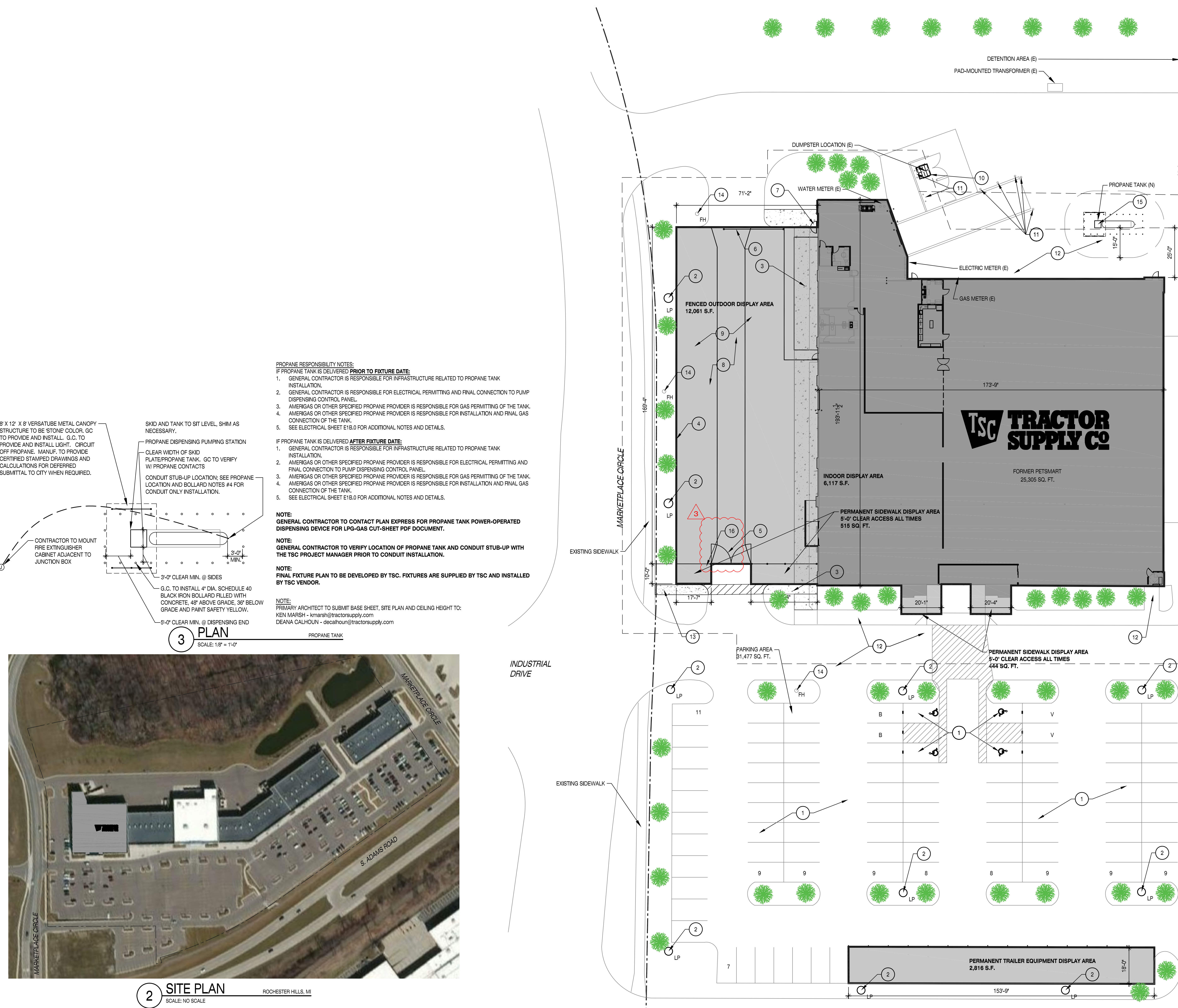

PROPANE RESPONSIBILITY NOTES:

- IF PROPANE TANK IS DELIVERED PRIOR TO FIXTURE DATE: 1. GENERAL CONTRACTOR IS RESPONSIBLE FOR INFRASTRUCTURE RELATED TO PROPANE TANK INSTALLATION...

IF PROPANE TANK IS DELIVERED AFTER FIXTURE DATE:

- 1. GENERAL CONTRACTOR IS RESPONSIBLE FOR INFRASTRUCTURE RELATED TO PROPANE TANK INSTALLATION...

NOTE: GENERAL CONTRACTOR TO CONTACT PLAN EXPRESS FOR PROPANE TANK POWER-OPERATED DISPENSING DEVICE FOR LPG-GAS CUT-SHEET PDF DOCUMENT.

NOTE: GENERAL CONTRACTOR TO VERIFY LOCATION OF PROPANE TANK AND CONDUIT STUB-UP WITH THE TSC PROJECT MANAGER PRIOR TO CONDUIT INSTALLATION.

NOTE: FINAL FIXTURE PLAN TO BE DEVELOPED BY TSC. FIXTURES ARE SUPPLIED BY TSC AND INSTALLED BY TSC VENDOR.

NOTE: PRIMARY ARCHITECT TO SUBMIT BASE SHEET, SITE PLAN AND CEILING HEIGHT TO: KEN MARSH - kmarsh@tractorsupply.com DEANA CALHOUN - decalhoun@tractorsupply.com

PROPANE TANK

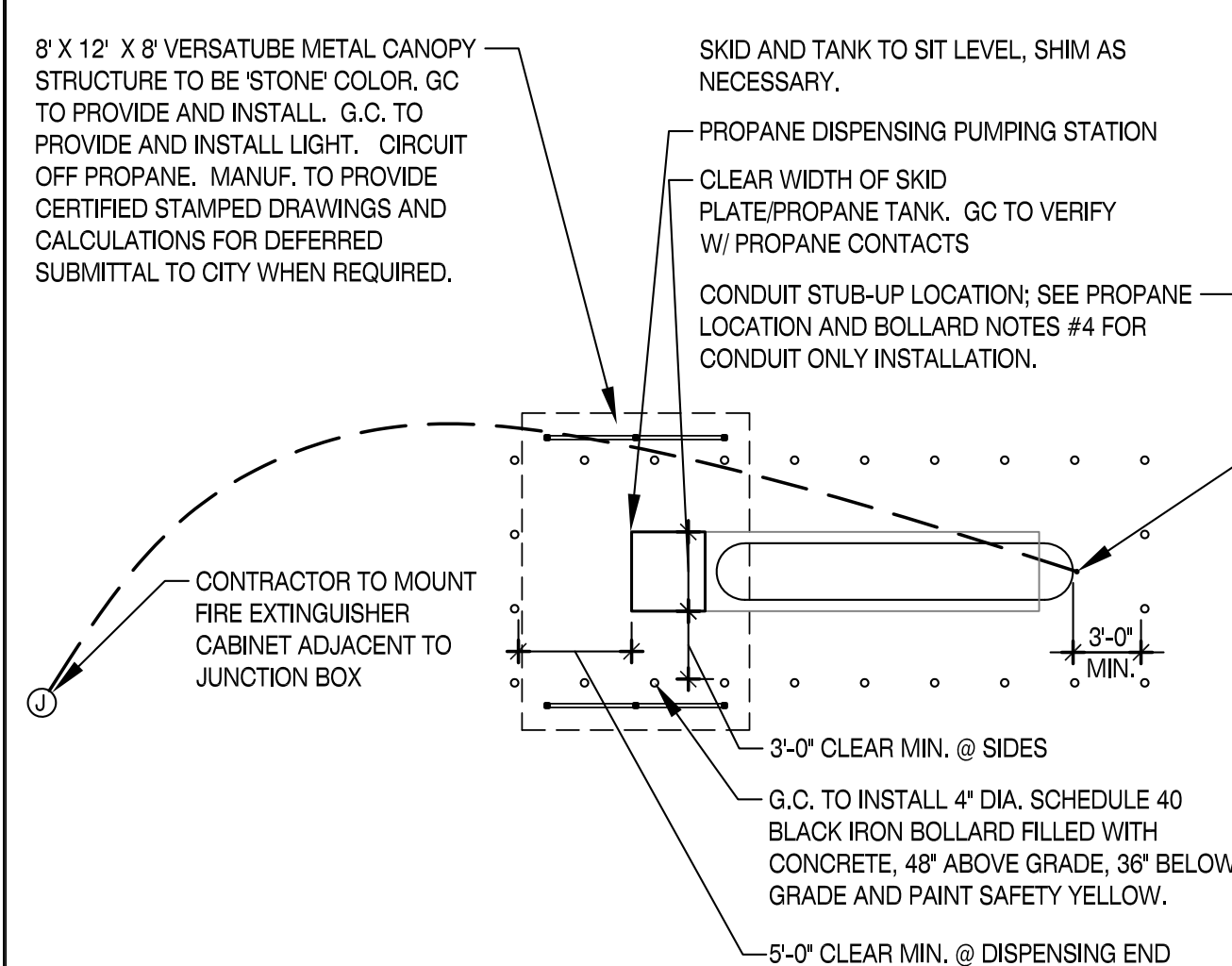

3 PLAN SCALE: 1/8" = 1'-0"



2 SITE PLAN SCALE: NO SCALE ROCHESTER HILLS, MI

KEYNOTES

(REFER ONLY TO NOTES THAT ARE INDICATED BY NUMERICAL KEY ON PLAN):

- 1. CONTRACTOR TO REPAIR AND RESTRIPE TSC PARKING AREA, DRIVE LANES, AND RECEIVING AREAS AS NECESSARY... 2. CONTRACTOR TO PLACE ALL EXISTING POLE LIGHTING IN PARKING LOT IN PROPER WORKING ORDER...

TRACTOR SUPPLY DISPLAY AREAS

PROPERTY LINE

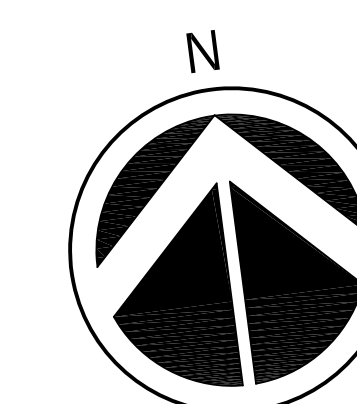

1 SITE PLAN SCALE: 1" = 20'-0"



**OXFORD
ARCHITECTURE**

2934 Sidco Drive
Suite 129
Nashville, TN 37204

Architecture
Planning
Interior Architecture

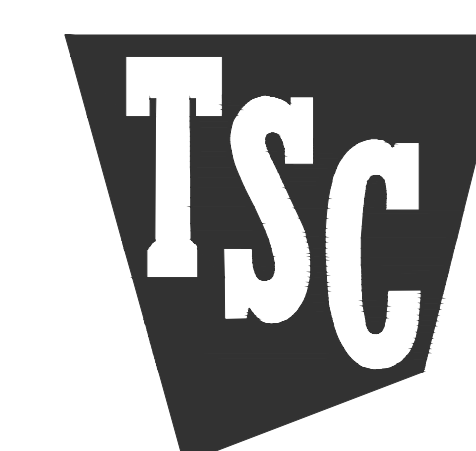

TRACTOR SUPPLY COMPANY

**ROCHESTER HILLS,
MICHIGAN**

2724 S. ADAMS RD

Tractor Supply Company shall not be responsible for the payment of any work performed or material supplied by the Contractor or any of its sub-contractors, sub-subcontractors and anyone claiming by through or under any of them which is not identified in writing and signed by one of the following Tractor Supply Company personnel: Vice President Real Estate, Director of Construction, or a Construction Project Manager. No action, conduct, omission, prior failure, or course of dealing by Tractor Supply Company shall act to waive, modify, change or alter the requirement that all work, whether by contract, change order or change directive, must be in writing and signed by the personnel identified in this provision. Any work performed or material provided by the Contractor, any of its sub-contractors, sub-subcontractors contrary to this provision shall be at its own risk and own expense and Tractor Supply Company shall not be obligated to reimburse or pay the Contractor or any of its sub-contractors, sub-subcontractors for same.

All measurements and items portrayed on this sheet are deemed to be accurate by architect, however all bidding General Contractors should field verify the actual conditions. Any changes to the scope of work, and thus potential change orders, should be identified and communicated in your bid submittal to TSC.

This drawing and the design shown is the property of the architect. The reproduction, copying or use of this drawing without their written consent is prohibited and any infringement will be subject to legal action.

Job Number: 2195

Date: 0610.2022

Revisions:

Revisions:

Revisions:

EASEMENT SITE PLAN

Sheet Number: **ES1.0**

CITY FILE #22-013 SECTION #30



2 SITE PLAN
SCALE: NO SCALE
ROCHESTER HILLS, MI

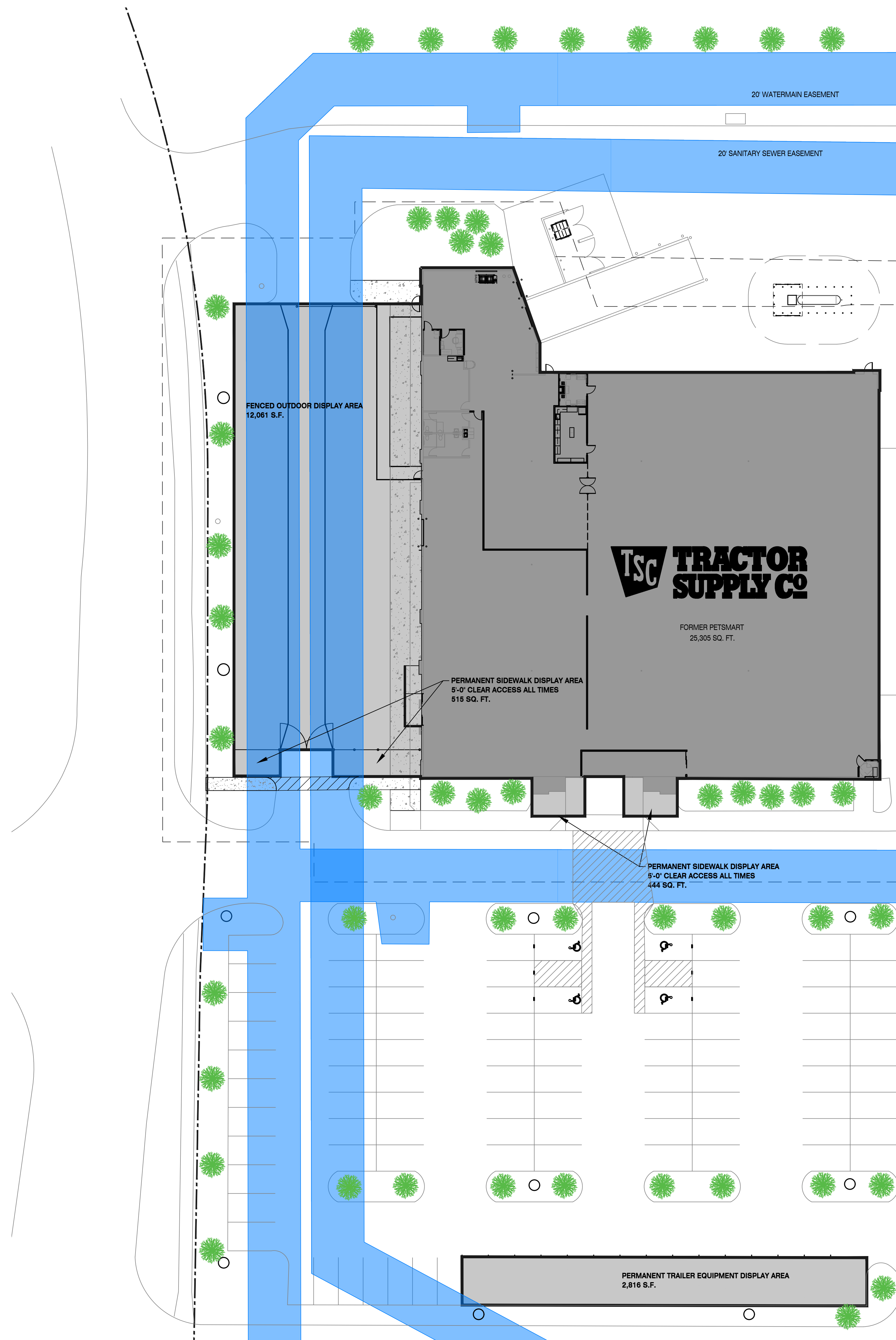

TRACTOR SUPPLY DISPLAY AREAS

TRACTOR SUPPLY PARKING AREA

EASEMENT/SHARED/OTHER PROTECTED AREA

PROPERTY LINE

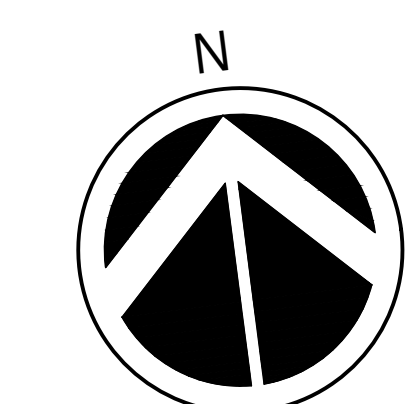

1 SITE PLAN
SCALE: 1" = 20'-0"
ROCHESTER HILLS, MI



OXFORD ARCHITECTURE

2934 Sidco Drive
Suite 139
Nashville, TN 37204

Architecture
Planning
Interior Architecture

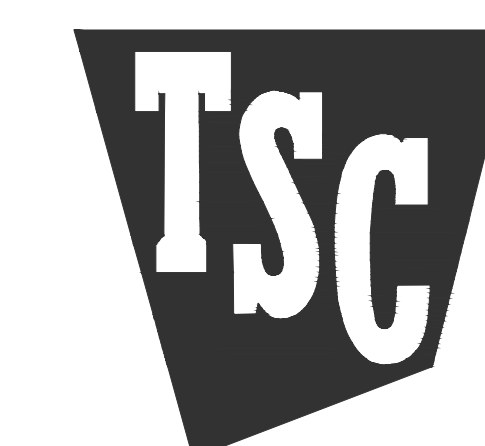

TRACTOR SUPPLY COMPANY
ROCHESTER HILLS,
MICHIGAN

2724 S. ADAMS RD

Tractor Supply Company shall not be responsible for the payment of any work performed or material supplied by the Contractor or any of its sub-contractors, sub-subcontractors and anyone claiming by through or under any of them which is not identified in writing and signed by one of the following Tractor Supply Company personnel: Vice President, Real Estate, Director of Construction, or a Construction Project Manager. No action, conduct, omission, prior failure, or course of dealing by Tractor Supply Company shall act to waive, modify, change or alter the requirement that all work, whether by contract, change order or change directive, must be in writing and signed by the personnel identified in this provision. Any work performed or material provided by the Contractor, any of its sub-contractors, sub-subcontractors contrary to this provision shall be at its own risk and own expense and Tractor Supply Company shall not be obligated to reimburse or pay the Contractor or any of its sub-contractors, sub-subcontractors for same.

All measurements and items portrayed on this sheet are deemed to be accurate by architect, however all bidding General Contractors should field verify the actual conditions. Any changes to the scope of work, and thus potential change orders, should be identified and communicated in your bid submittal to TSC.

This drawing and the design shown is the property of the architect. The reproduction, copying or use of this drawing without their written consent is prohibited and any infringement will be subject to legal action.

Job Number: 2195

Date: 0610.2022

Revisions:

Revisions:

Revisions: PARKING SITE PLAN

Sheet Number: PS1.0

CITY FILE #22-013 SECTION #30

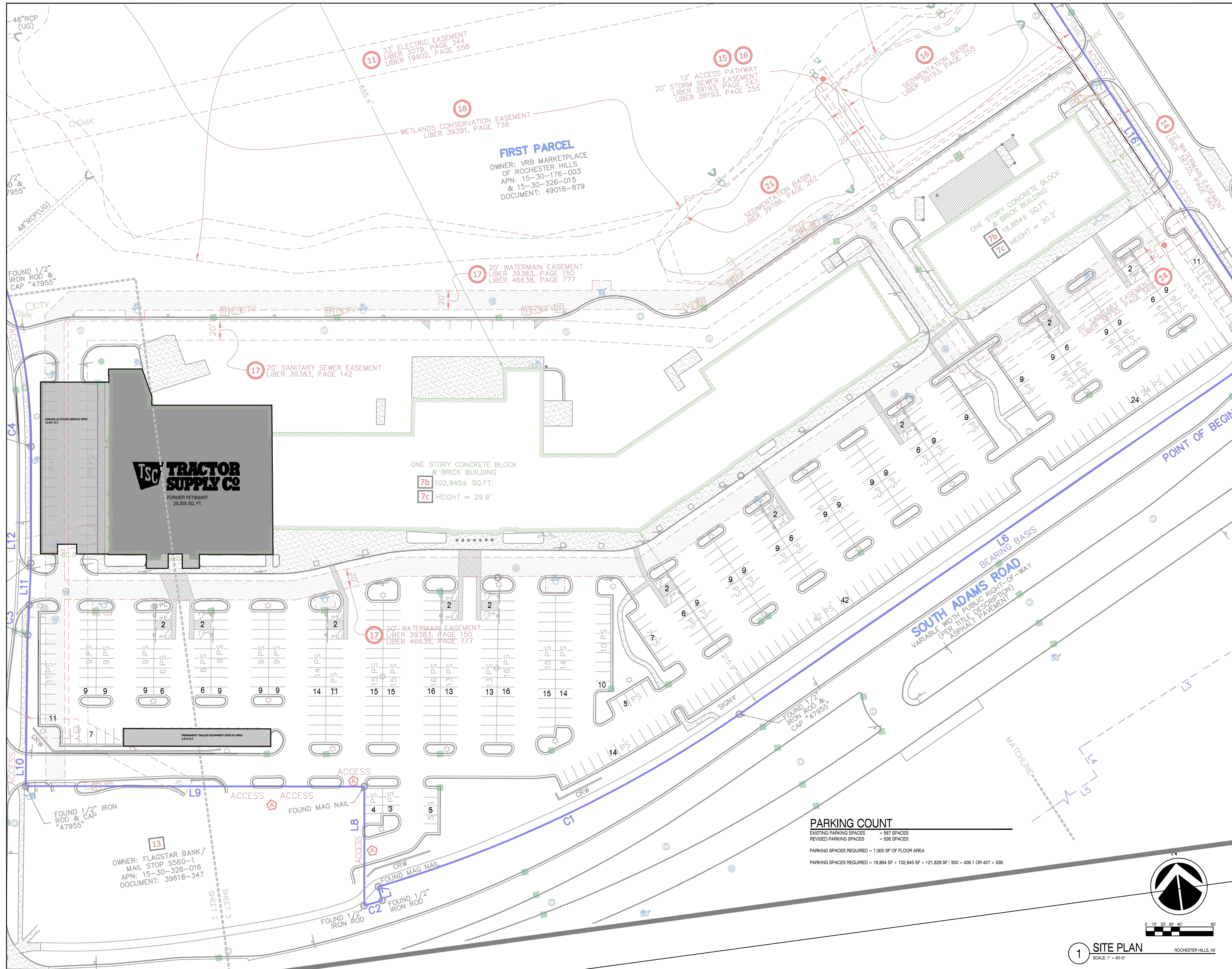

PARKING COUNT

EXISTING PARKING SPACES	= 587 SPACES
REVISED PARKING SPACES	= 536 SPACES
PARKING SPACES REQUIRED = 1:300 SF OF FLOOR AREA	
PARKING SPACES REQUIRED = 18,884 SF + 102,945 SF = 121,829 SF / 300 = 406.1 OR 407 < 536	

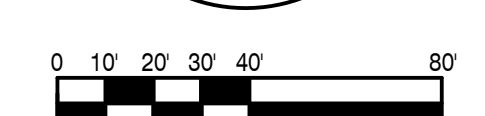
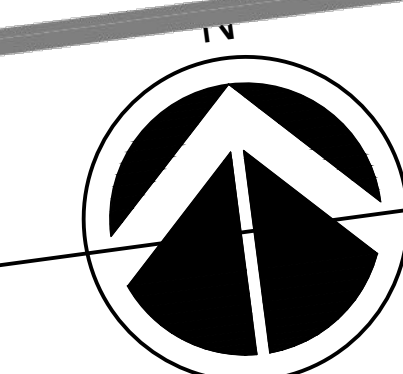

1 SITE PLAN
SCALE: 1" = 40'-0"
ROCHESTER HILLS, MI

OWNER: FLAGSTAR BANK/
MAIL STOP S560-1
APN: 15-30-326-016
DOCUMENT: 39618-347

FIRST PARCEL
OWNER: VRB MARKETPLACE
OF ROCHESTER HILLS
APN: 15-30-176-003
& 15-30-326-015
DOCUMENT: 49016-879

ONE STORY CONCRETE BLOCK
& BRICK BUILDING
7b 102,945± SQ.FT.
7c HEIGHT = 29.9'

ONE STORY CONCRETE BLOCK
& BRICK BUILDING
7b 18,884± SQ.FT.
7c HEIGHT = 30.2'

SHEET 3
SHEET 2



OXFORD ARCHITECTURE

2934 Sidco Drive Suite 120 Nashville, TN 37204 Architecture Planning Interior Architecture



TRACTOR SUPPLY COMPANY ROCHESTER HILLS, MICHIGAN

2724 S. ADAMS RD

Tractor Supply Company shall not be responsible for the payment of any work performed or material supplied by the Contractor or any of its sub-contractors, sub-subcontractors and anyone claiming by through or under any of them which is not identified in writing and signed by one of the following Tractor Supply Company personnel: Vice President Real Estate, Director of Construction, or a Construction Project Manager. No action, conduct, omission, prior failure, or course of dealing by Tractor Supply Company shall act to waive, modify, change or alter the requirement that in writing and signed by the personnel identified in this provision. Any work performed or material provided by the Contractor, any of its sub-contractors, sub-subcontractors contrary to this provision shall be at its own risk and own expense and Tractor Supply Company shall not be obligated to reimburse or pay the Contractor or any of its sub-contractors, sub-subcontractors for some.

All measurements and items portrayed on this sheet are deemed to be accurate by architect, however all bidding General Contractors should field verify the actual conditions. Any changes to the scope of work, and thus potential change orders, should be identified and communicated in your bid submittal to TSC. This drawing and the design shown is the property of the architect. The reproduction, copying or use of this drawing without their written consent is prohibited and any infringement will be subject to legal action.

Job Number: 2195

Date: 0610.2022

Revisions:

Revisions:

Revisions: SITE DETAILS

Sheet Number: SD1.1

CITY FILE #22-013 SECTION #30

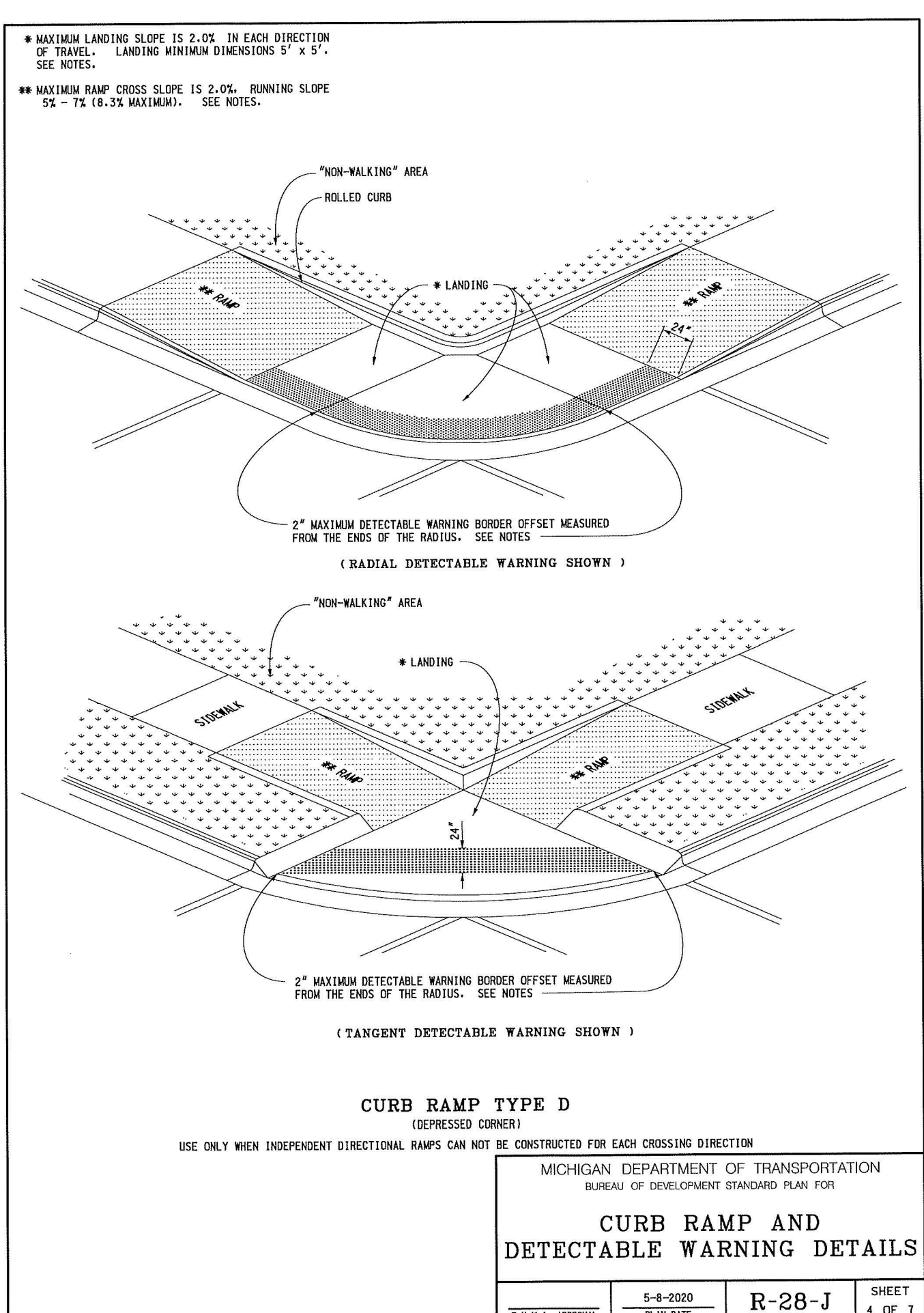
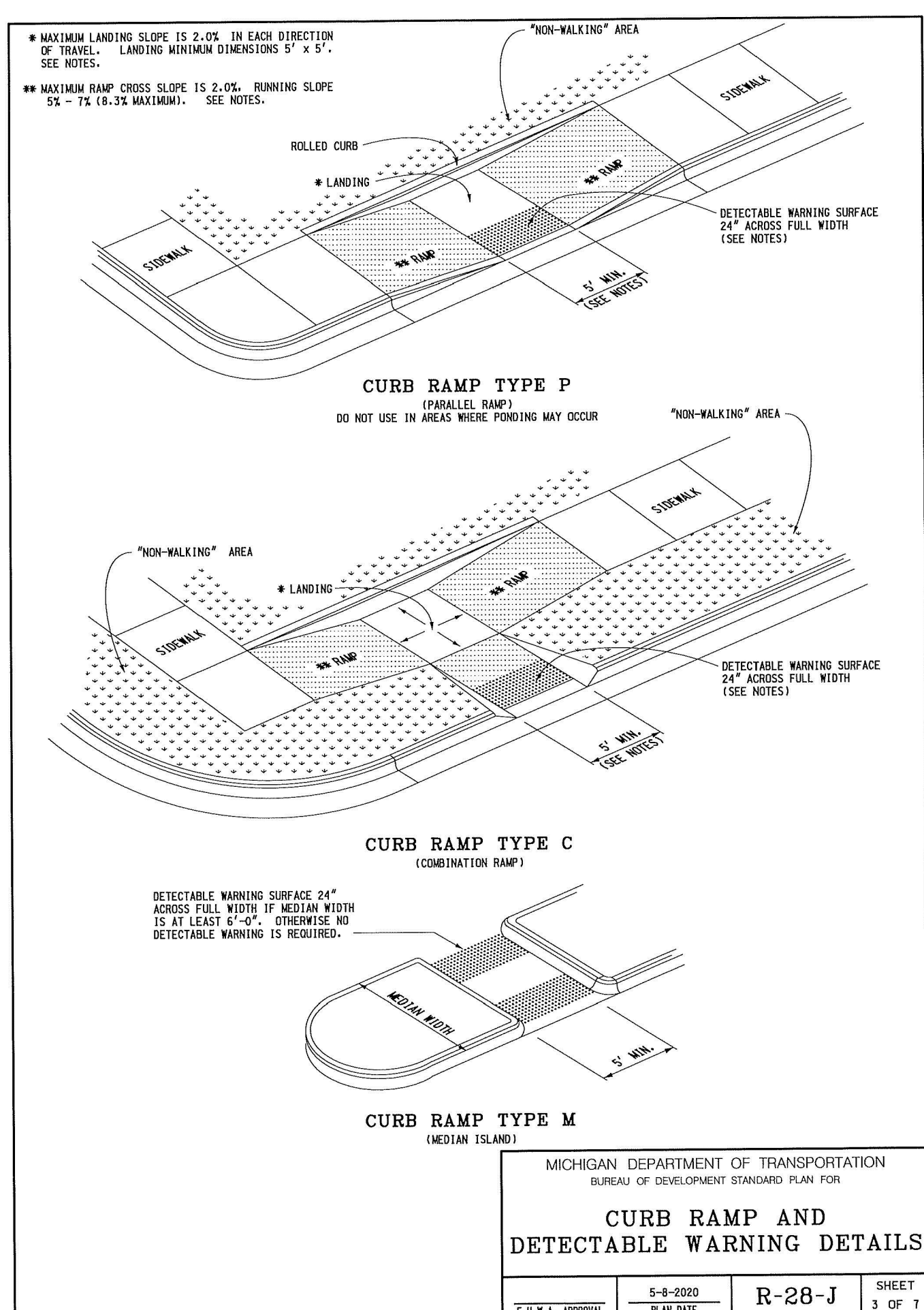
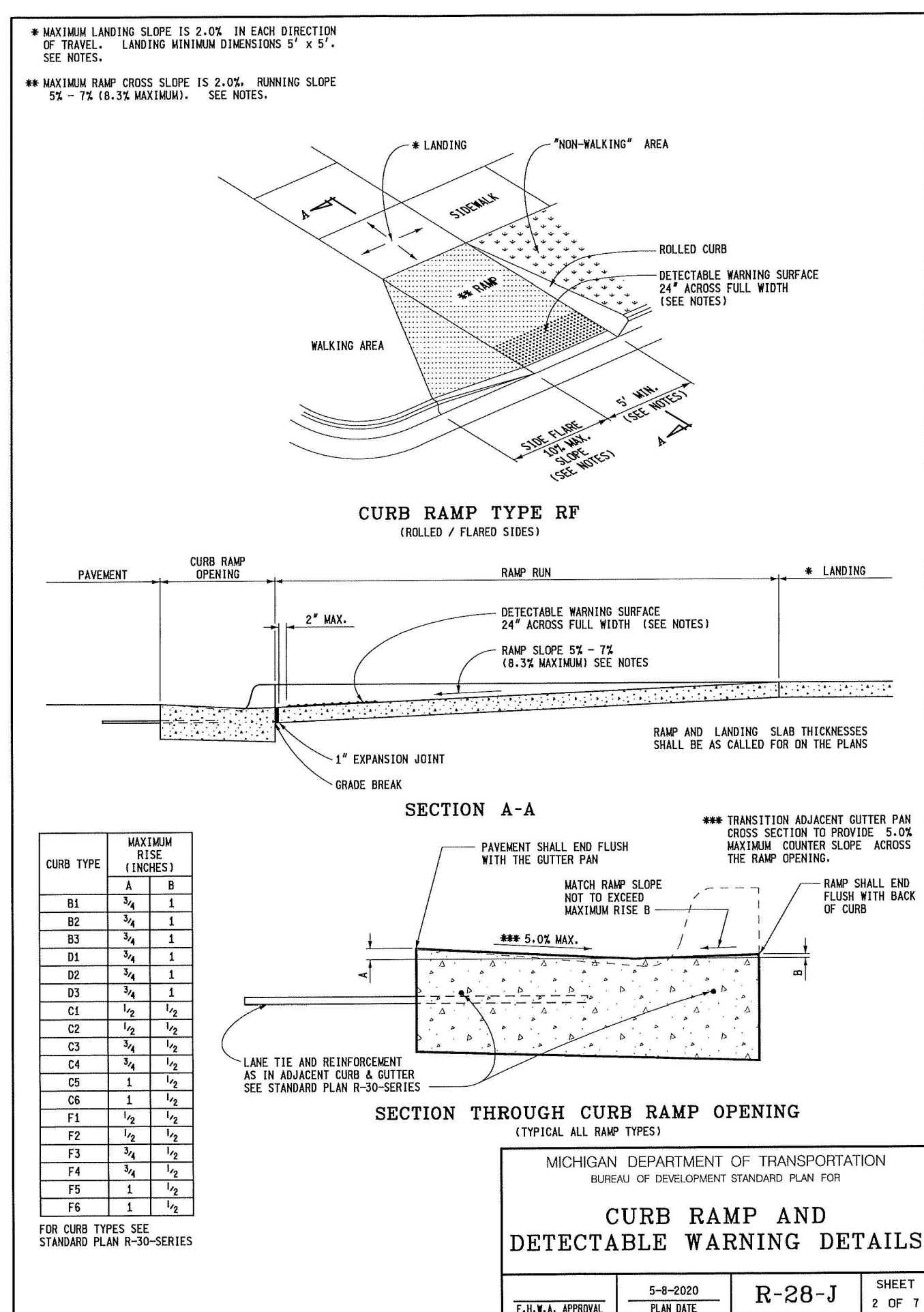
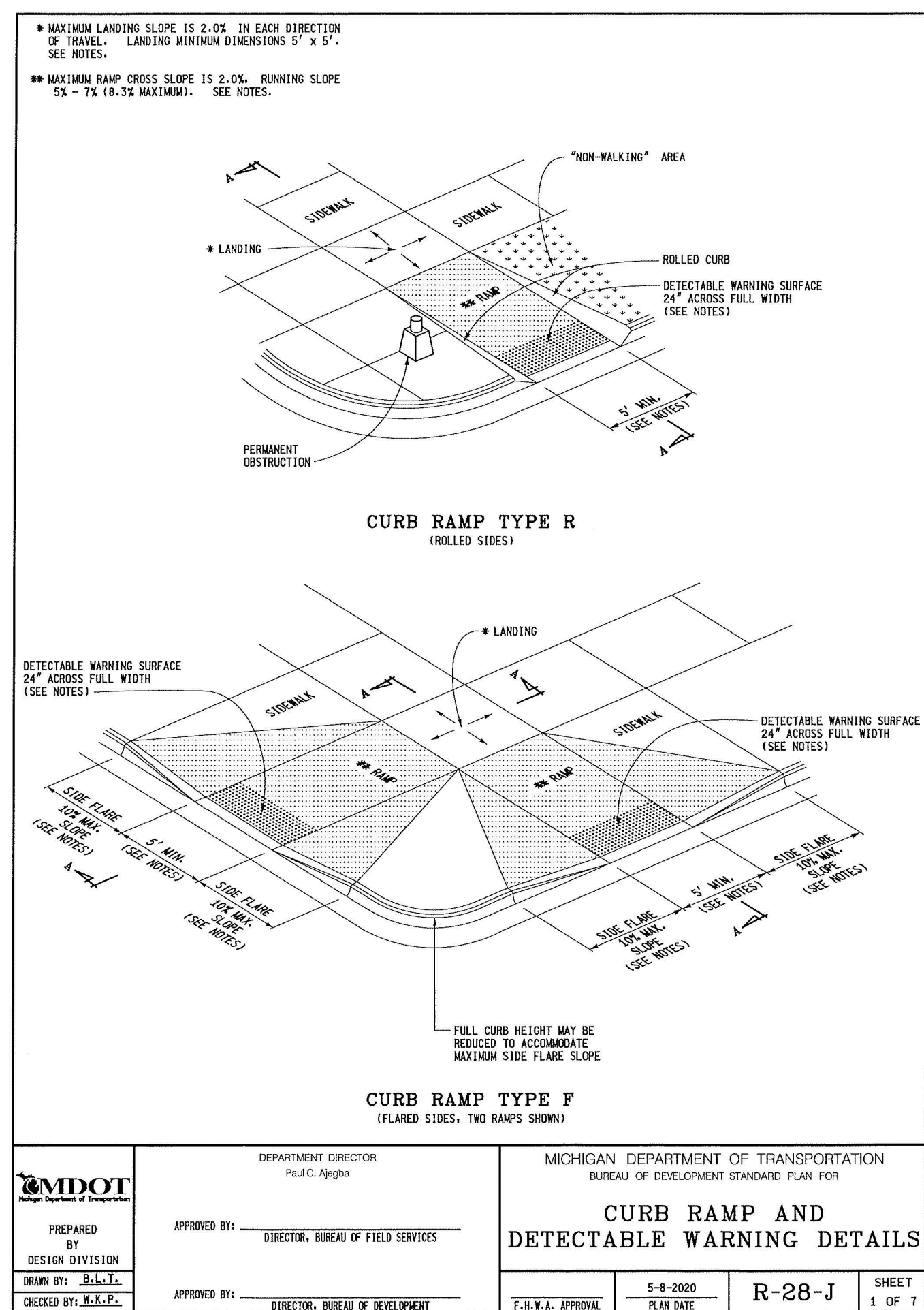
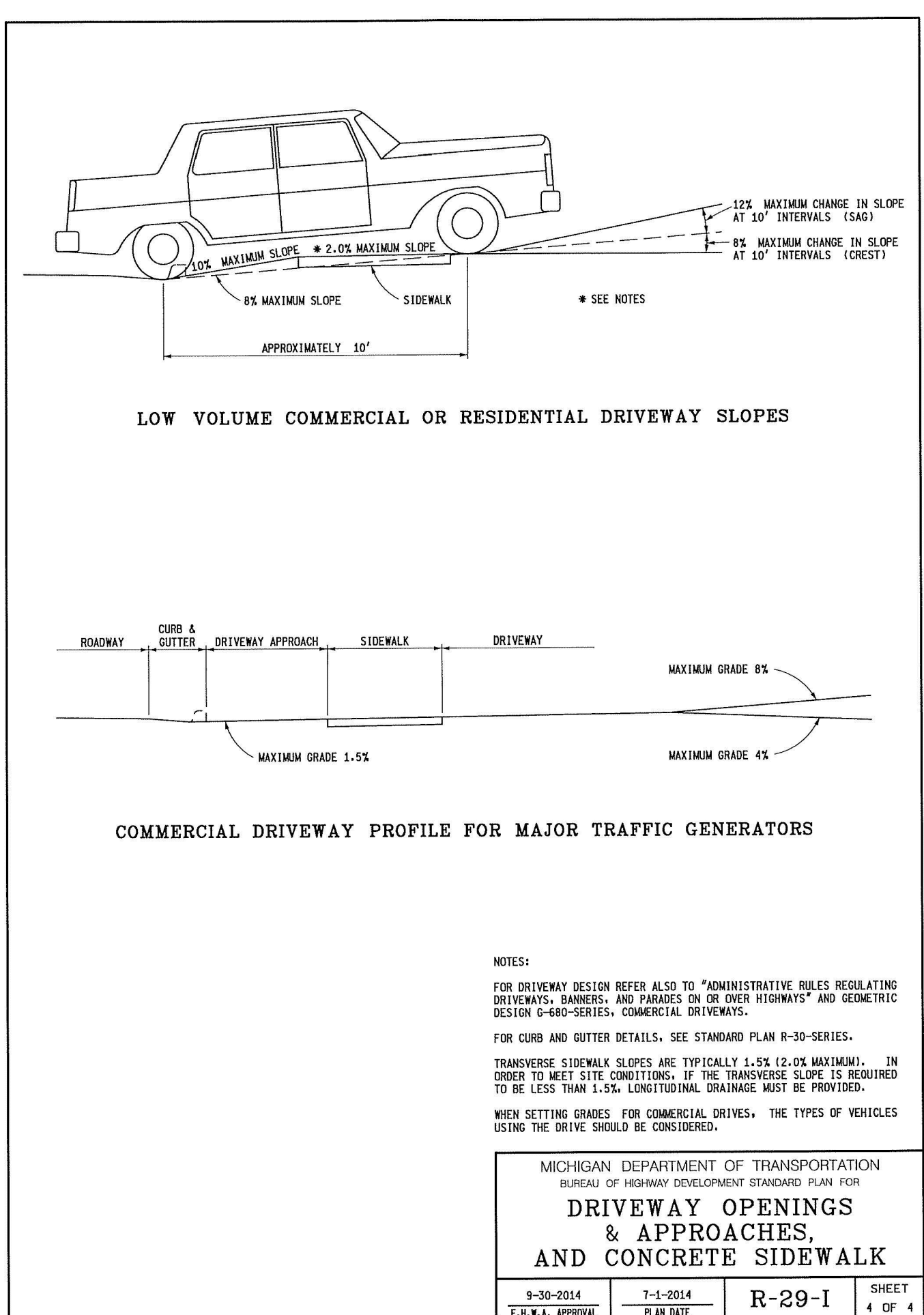
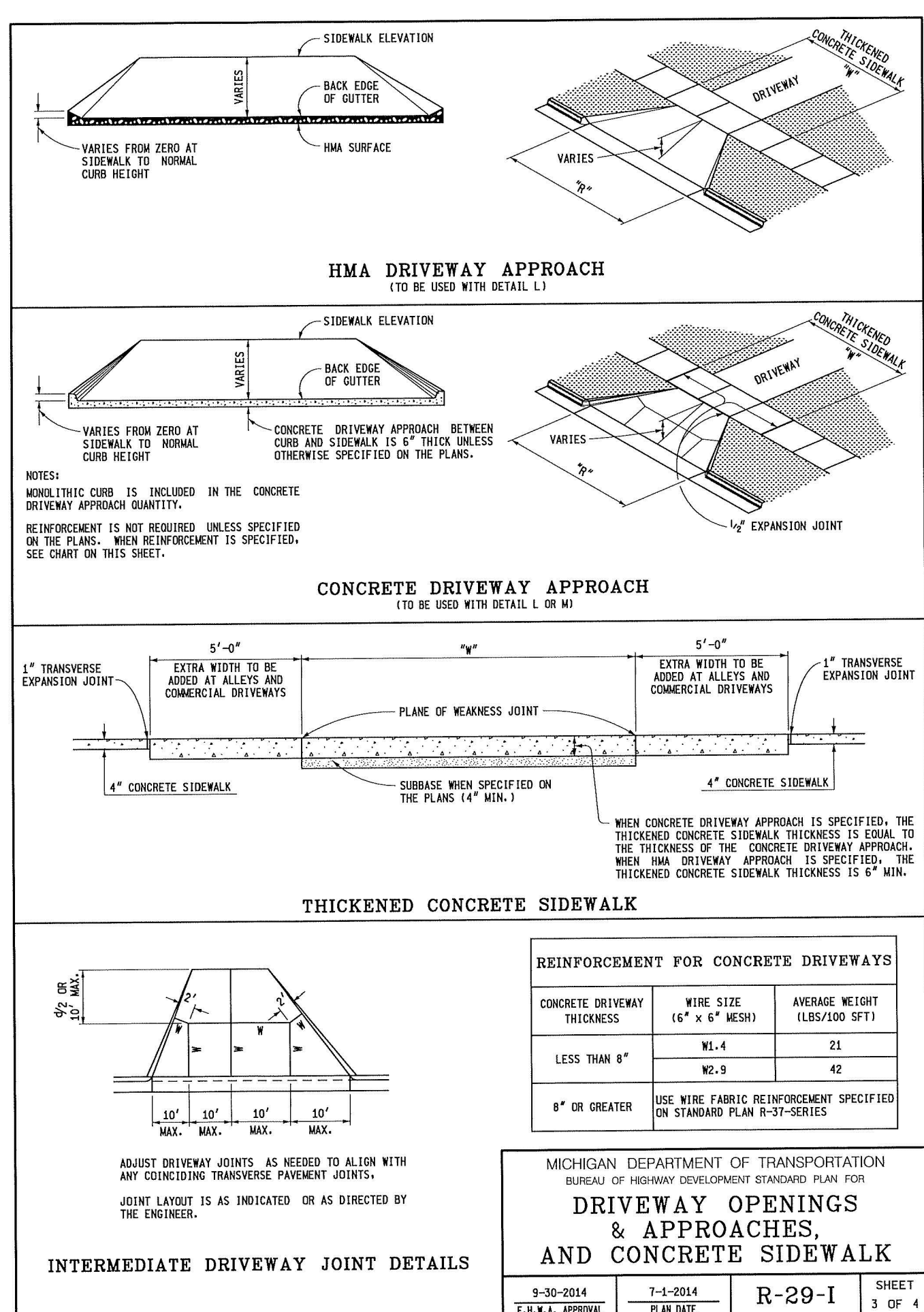
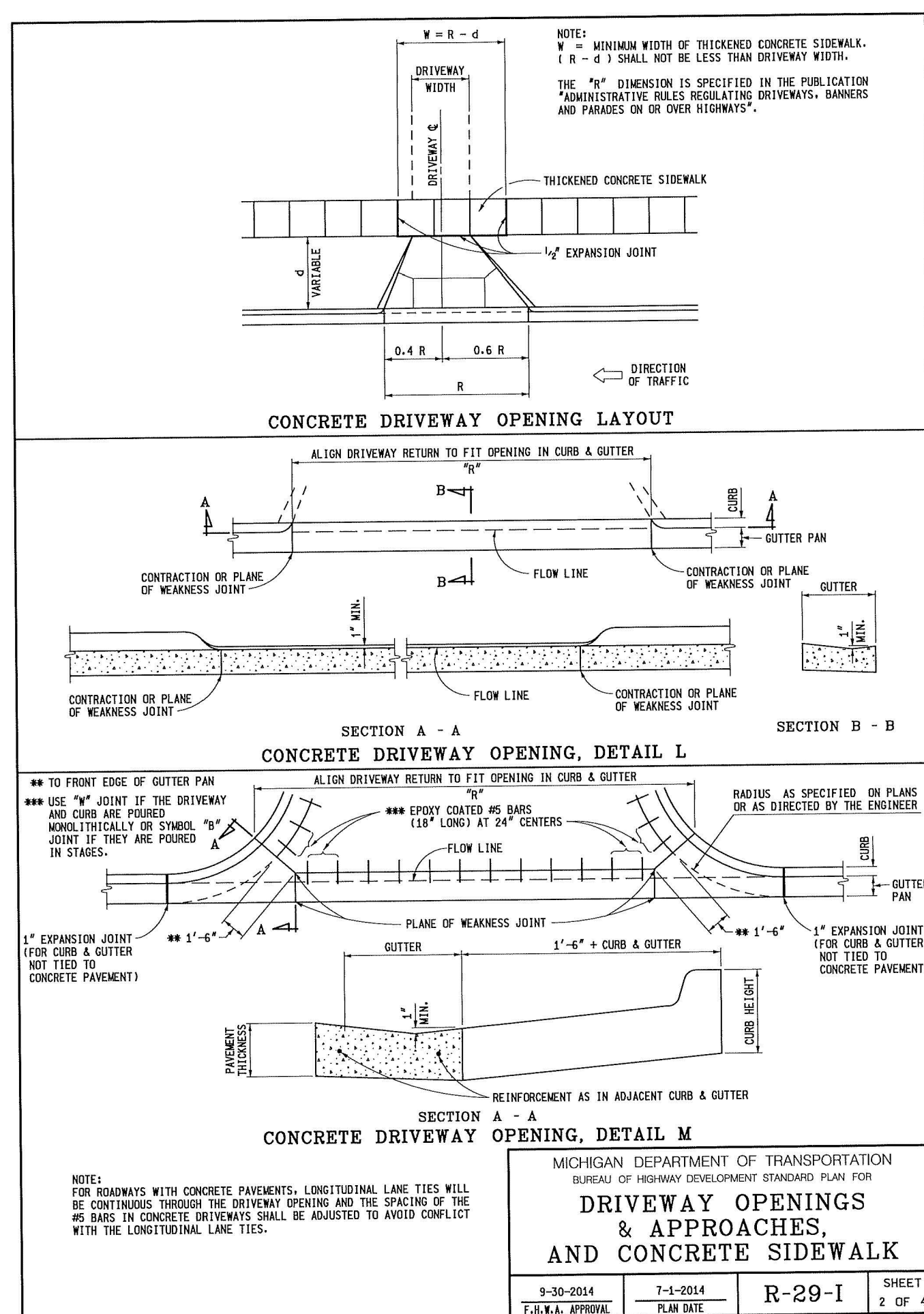
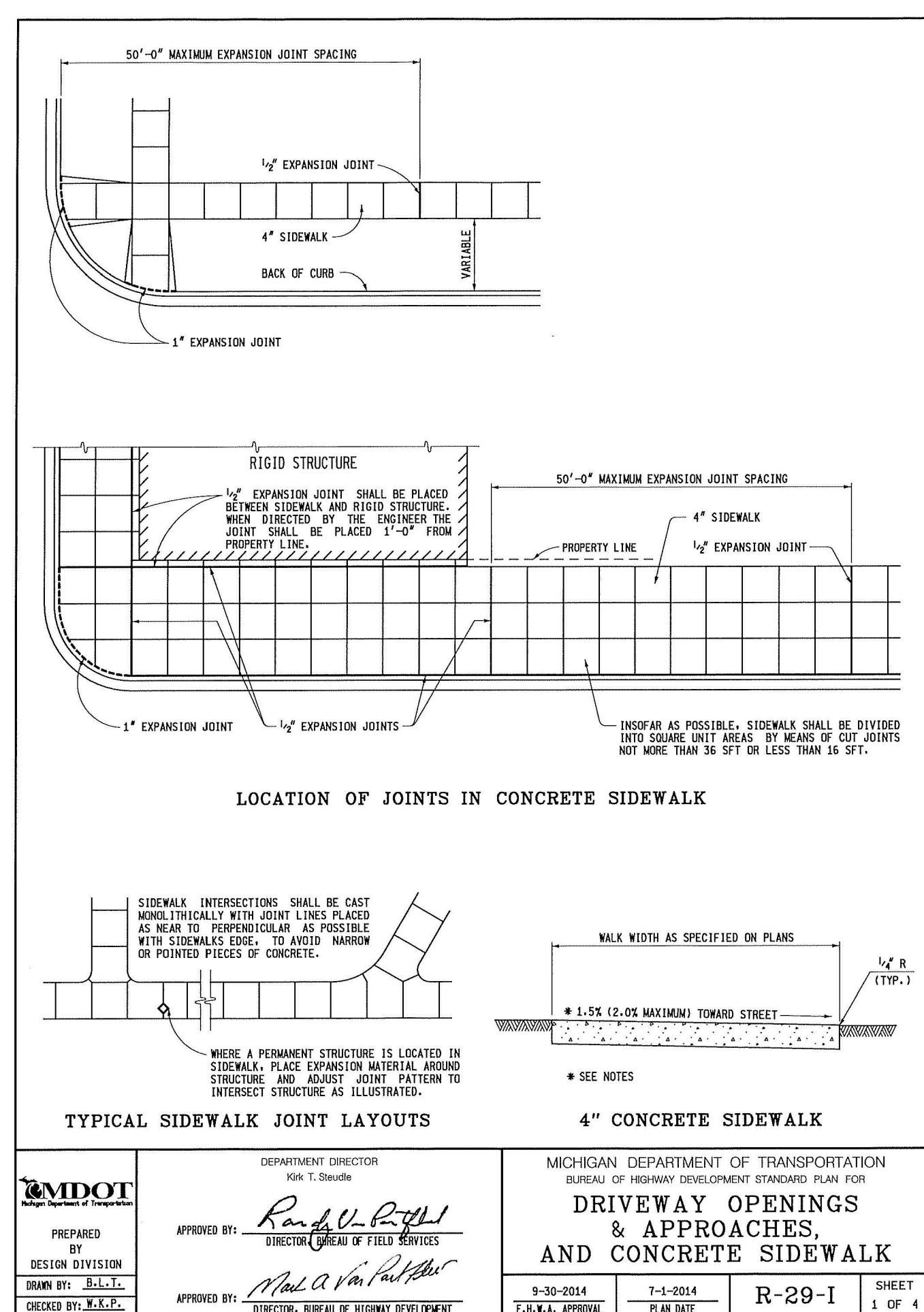

Job Number: 2195

Date: 0610.2022

Revisions:

Revisions:

Revisions: SITE DETAILS

Sheet Number: SD1.1

CITY FILE #22-013 SECTION #30



OXFORD ARCHITECTURE

2934 Sidco Drive Suite 120 Nashville, TN 37204

Architecture Planning Interior Architecture

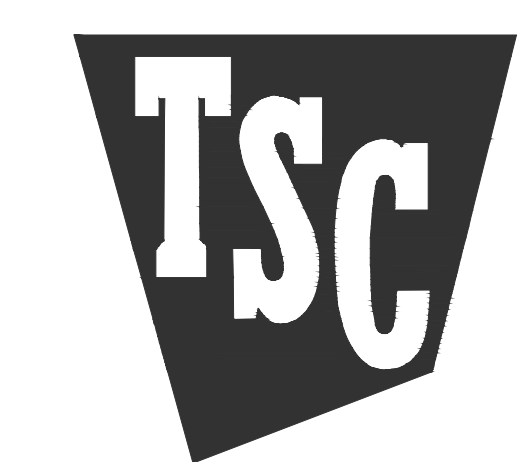
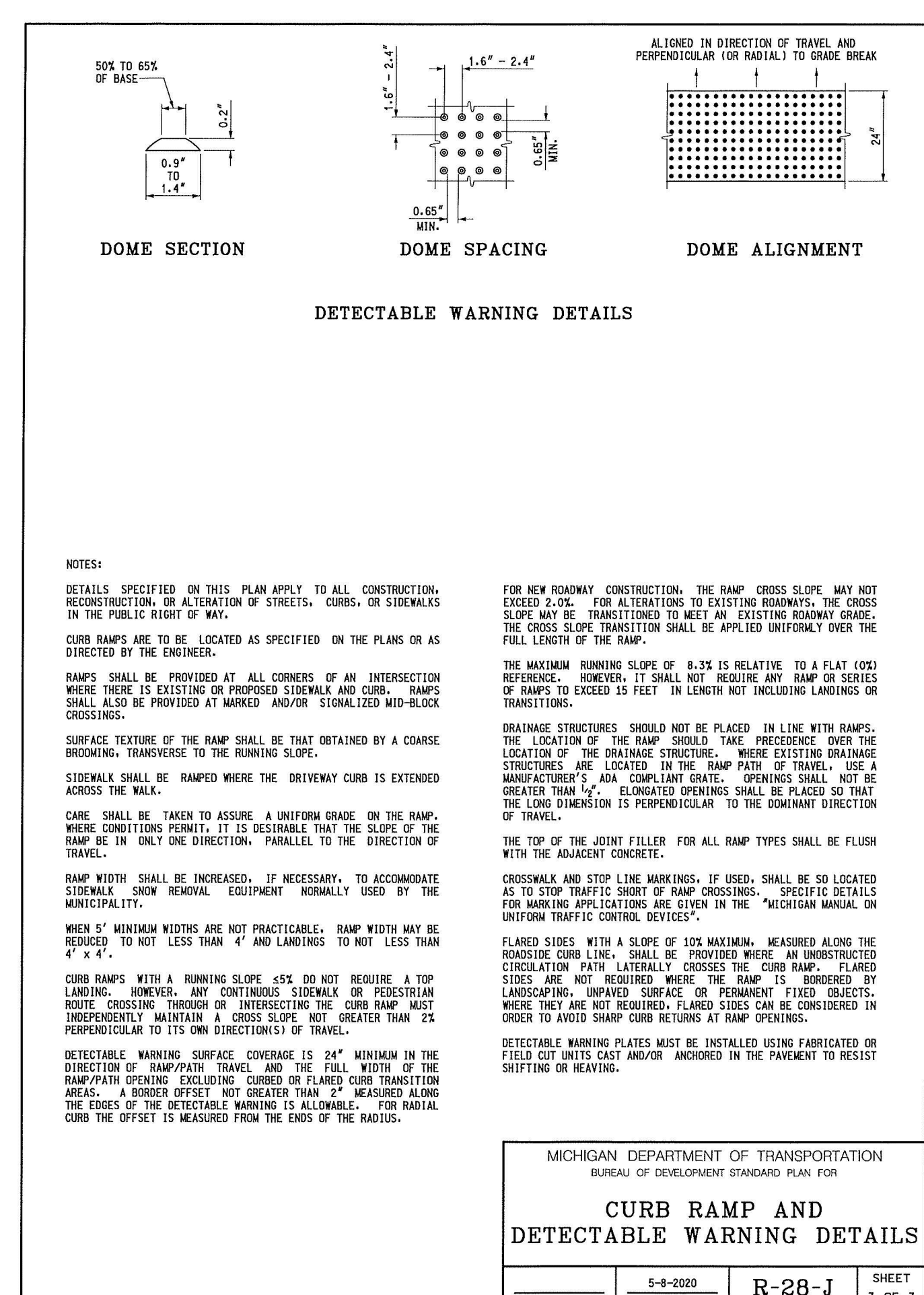
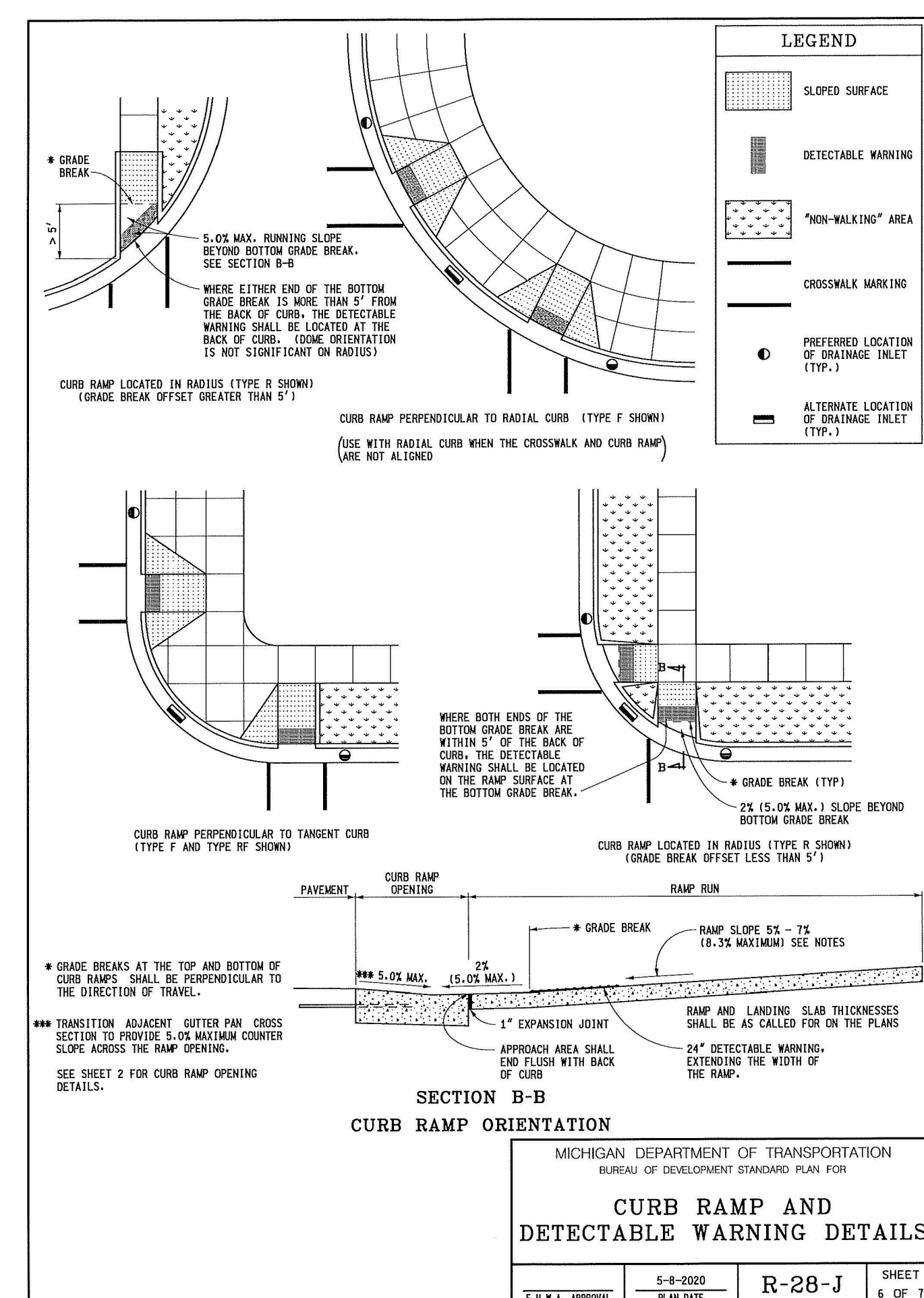
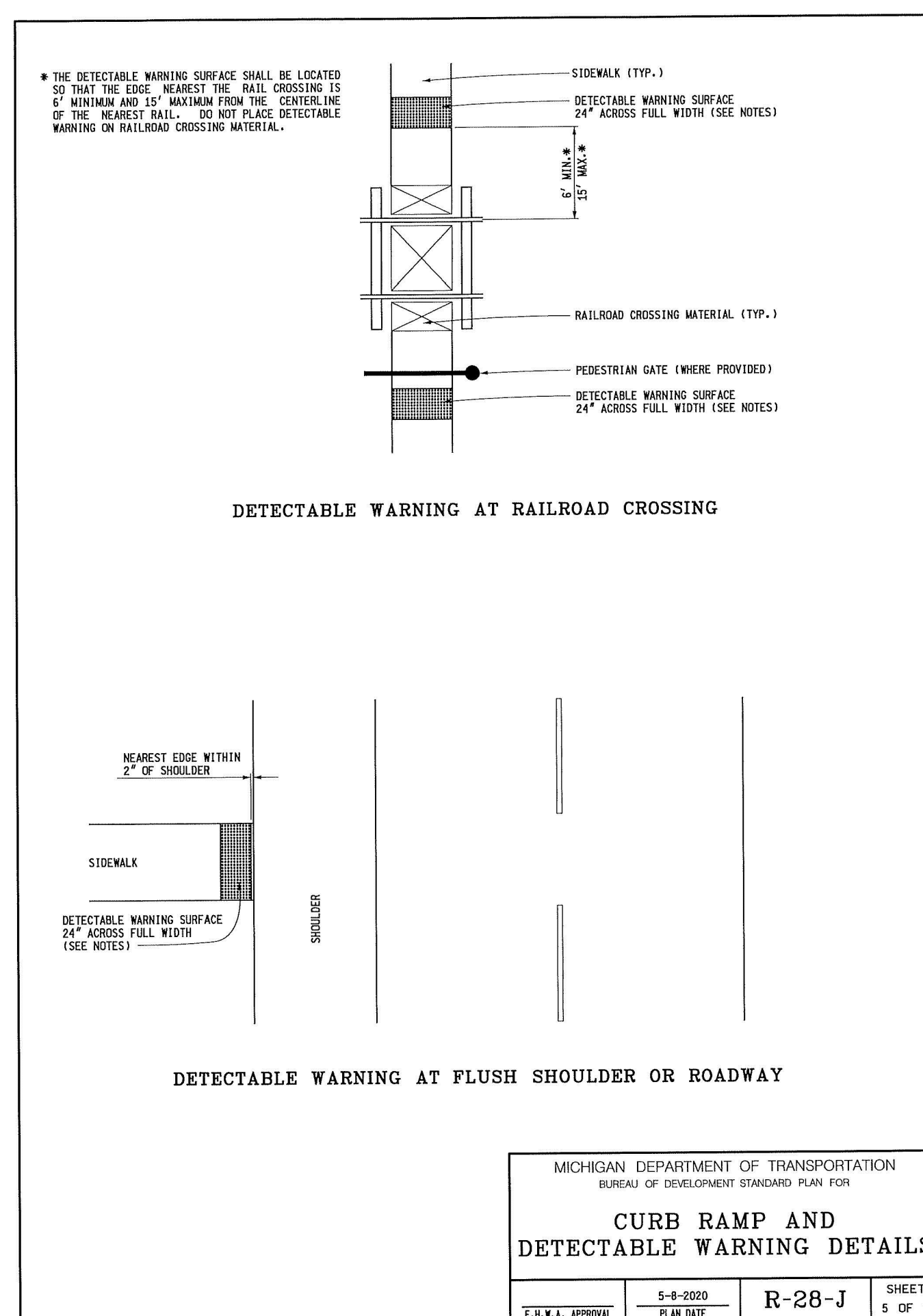

TRACTOR SUPPLY COMPANY ROCHESTER HILLS, MICHIGAN

2724 S. ADAMS RD

Tractor Supply Company shall not be responsible for the payment of any work performed or material supplied by the Contractor or any of its sub-contractors, sub-subcontractors and anyone claiming by through or under any of them which is not identified in writing and signed by one of the following Tractor Supply Company personnel: Vice President Real Estate, Director of Construction, or a Construction Project Manager. No action, conduct, omission, prior failure, or course of dealing by Tractor Supply Company shall act to waive, modify, change or alter the requirement that all work, whether by contract, change order or change directive, must be in writing and signed by the personnel identified in this provision. Any work performed or material provided by the Contractor, any of its sub-contractors, sub-subcontractors contrary to this provision shall be at its own risk and own expense and Tractor Supply Company shall not be obligated to reimburse or pay the Contractor or any of its sub-contractors, sub-subcontractors for same.

All measurements and items portrayed on this sheet are deemed to be accurate by architect, however all bidding General Contractors should field verify the actual conditions. Any changes to the scope of work, and thus potential change orders, should be identified and communicated in your bid submittal to TSC.

This drawing and the design shown is the property of the architect. The reproduction, copying or use of this drawing without their written consent is prohibited and any infringement will be subject to legal action.

Job Number:	2195
Date:	0610.2022
Revisions:	
Revisions:	
Revisions:	SITE DETAILS

Sheet Number: SD1.2 CITY FILE #22-013 SECTION #30



OXFORD ARCHITECTURE

2934 Sidco Drive
Suite 120
Nashville, TN 37204

Architecture
Planning
Interior Architecture

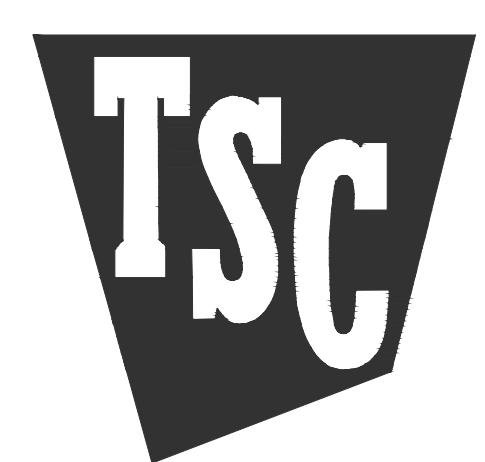

TRACTOR SUPPLY COMPANY
ROCHESTER HILLS,
MICHIGAN

2724 S. ADAMS RD

Tractor Supply Company shall not be responsible for the payment of any work performed or material supplied by the Contractor or any of its sub-contractors, sub-subcontractors and anyone claiming by through or under any of them which is not identified in writing and signed by one of the following Tractor Supply Company personnel: Vice President Real Estate, Director of Construction, or a Construction Project Manager. No action, conduct, omission, prior failure, or course of dealing by Tractor Supply Company shall act to waive, modify, change or alter the requirement that all work, whether by contract, change order or change directive, must be in writing and signed by the personnel identified in this provision. Any work performed or material provided by the Contractor, any of its sub-contractors, sub-subcontractors contrary to this provision shall be at its own risk and own expense and Tractor Supply Company shall not be obligated to reimburse or pay the Contractor or any of its sub-contractors, sub-subcontractors for same.

All measurements and items portrayed on this sheet are deemed to be accurate by architect, however all bidding General Contractors should field verify the actual conditions. Any changes to the scope of work, and thus potential change orders, should be identified and communicated in your bid submittal to TSC.

This drawing and the design shown is the property of the architect. The reproduction, copying or use of this drawing without their written consent is prohibited and any infringement will be subject to legal action.

Job Number: **2195**

Date: **0610.2022**

Revisions:

Revisions:

Revisions: SIGHT LINES SITE PLAN

Sheet Number: **SL1.0**

CITY FILE #22-013 SECTION #30



3 EXIT VIEW RIGHT
SCALE: NO SCALE



4 EXIT VIEW LEFT
SCALE: NO SCALE

Different sight distances are required for yield or signal controlled intersections. Contact road agency's (City, R.C.O.C., or M.D.O.T.) design division for determining corner sight distance at yield or signalized approaches.

POINT OF OBSERVATION:
(A) Eighteen (18) feet from edge of pavement of sidewalk/pathway.

FOR OFFSET SEE NOTE

OBSERVATION POINT (DRIVER'S EYE)

DESIGN VEHICLE "P"

The point of vision shall be from the height of eye, 3.5 feet above the proposed intersecting elevation to a height of object 3.5 feet above the existing or proposed road centerline and shall be continuously visible within the specified limits.

MINIMUM CORNER SIGHT DISTANCE FOR STREETS AT INTERSECTIONS		
ROADWAY APPROACHING INTERSECTION	MINIMUM SIGHT DISTANCE IN FEET, BOTH DIRECTIONS	
0	135	
-1	140	
-2	145	
-3	150	
-4	160	
-5	165	
-6	175	
-7	180	
-8	205	

NOTES

- Any deviation from given data requires an engineering study approved by the road agency (City, R.C.O.C., or M.D.O.T.) in accordance with the latest edition AASHTO Guide for the Development of Bicycle Facilities.
- This design guide also applies to new Permit and Plat construction projects.
- The bicycle design speed used in the chart is 18 MPH.
- Approach roadway slope greater than 8% is not allowed due to ADA compliance.
- Existing site conditions may require an engineering study to determine sight distance.

CITY OF ROCHESTER HILLS
STANDARD DETAIL FOR:
Sight Distance Pathways

DRAWN BY: B. Smith	FILE NAME: Circ Dwg	PLAN DATE: 8/28/1996	REV. 4/12/2012	REV. 3/15/2014	REV.
APPROVED BY: PAUL SHAWLACK, P.E., PTOE	CITY TRANSPORTATION ENGINEER		NOT TO SCALE	SHEET 2 OF 2	

Different sight distances are required for yield or signal controlled intersections. Contact road agency's (City, R.C.O.C., or M.D.O.T.) design division for determining corner sight distance at yield or signalized approaches.

POINT OF OBSERVATION:
Paved Surface:
(A) Eighteen (18) feet from edge of pavement of through lane.
Gravel Surface:
(A) Eighteen (18) feet from edge of gravel road.
* For residential driveways approaching gravel or paved roads (A) is 10' from the edge of gravel/pavement.

FOR OFFSET SEE NOTE

OBSERVATION POINT (DRIVER'S EYE)

DESIGN VEHICLE "P"

The point of vision shall be from the height of eye, 3.5 feet above the proposed intersecting elevation to a height of object 3.5 feet above the existing or proposed road centerline and shall be continuously visible within the specified limits.

MINIMUM CORNER SIGHT DISTANCE FOR DRIVEWAYS AND STREETS AT MAJOR ROAD INTERSECTIONS FOR PASSENGER VEHICLES		
MAJOR ROAD POSTED OR SIG. SPEED IN MPH	MINIMUM SIGHT DISTANCE IN FEET, BOTH DIRECTIONS	
25	280	285
30	325	335
35	360	415
40	445	470
45	500	500
50	555	580
55	610	650

The basic prima facie speed shall be used for gravel roads, unless otherwise approved by the Engineer.

NOTES

- Any deviation from given data requires an engineering study approved by the road agency (City, R.C.O.C., or M.D.O.T.) in accordance with the latest edition AASHTO policy on geometric design.
- This design guide also applies to new Permit and Plat construction projects.
- The above data is based on a left turn maneuver into the intersecting roadway as described in AASHTO. Due to the higher potential accident severity, the left turning sight distance was used to determine the corner sight distance required. Right turn onto major roads shall have the same sight distances.
- Existing site conditions may require an engineering study to determine sight distance.

CITY OF ROCHESTER HILLS
STANDARD DETAIL FOR:
Sight Distance Roadways

DRAWN BY: B. Smith	FILE NAME: Circ Dwg	PLAN DATE: 8/28/1996	REV. 4/12/2012	REV. 3/15/2014	REV.
APPROVED BY: PAUL SHAWLACK, P.E., PTOE	CITY TRANSPORTATION ENGINEER		NOT TO SCALE	SHEET 1 OF 2	

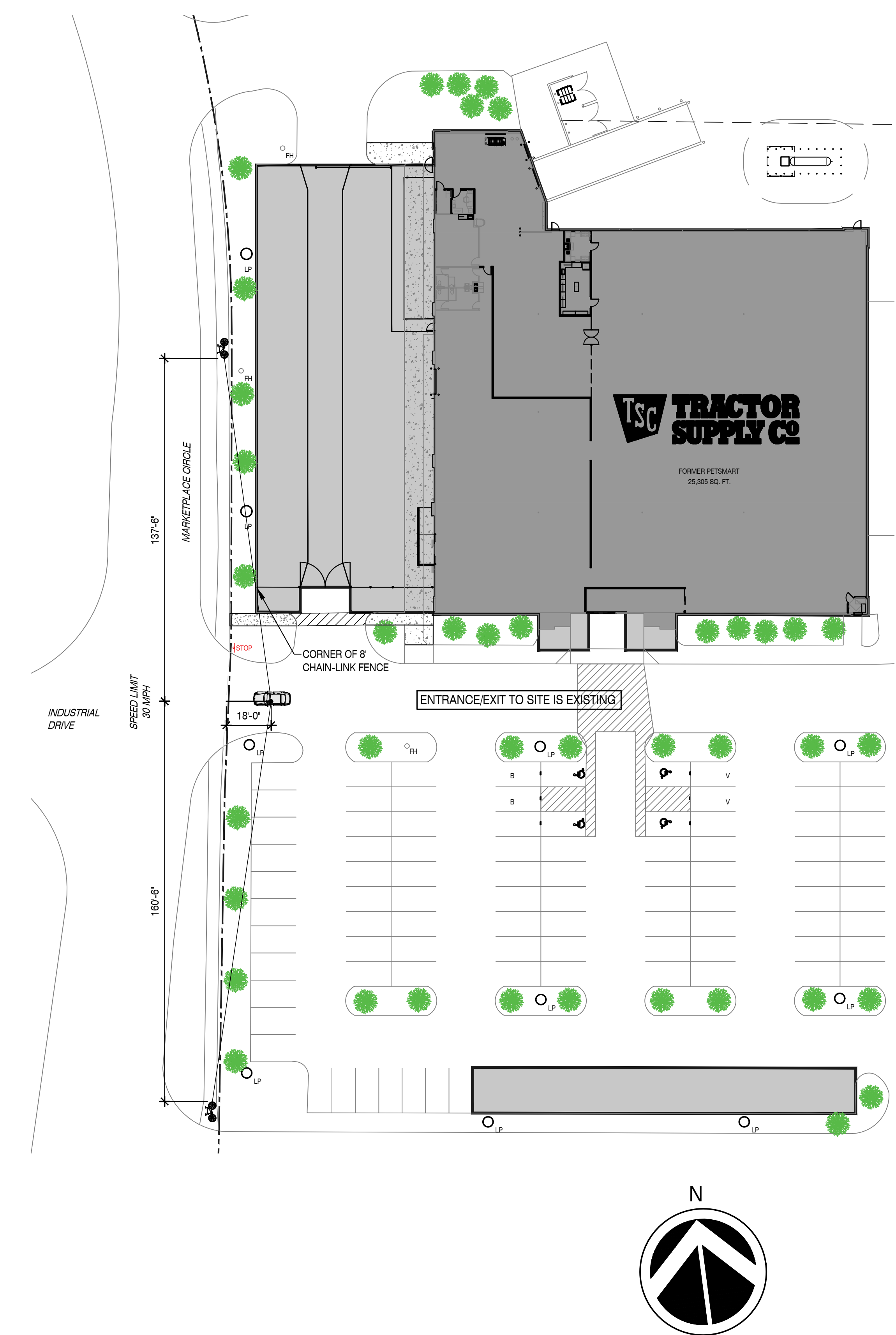

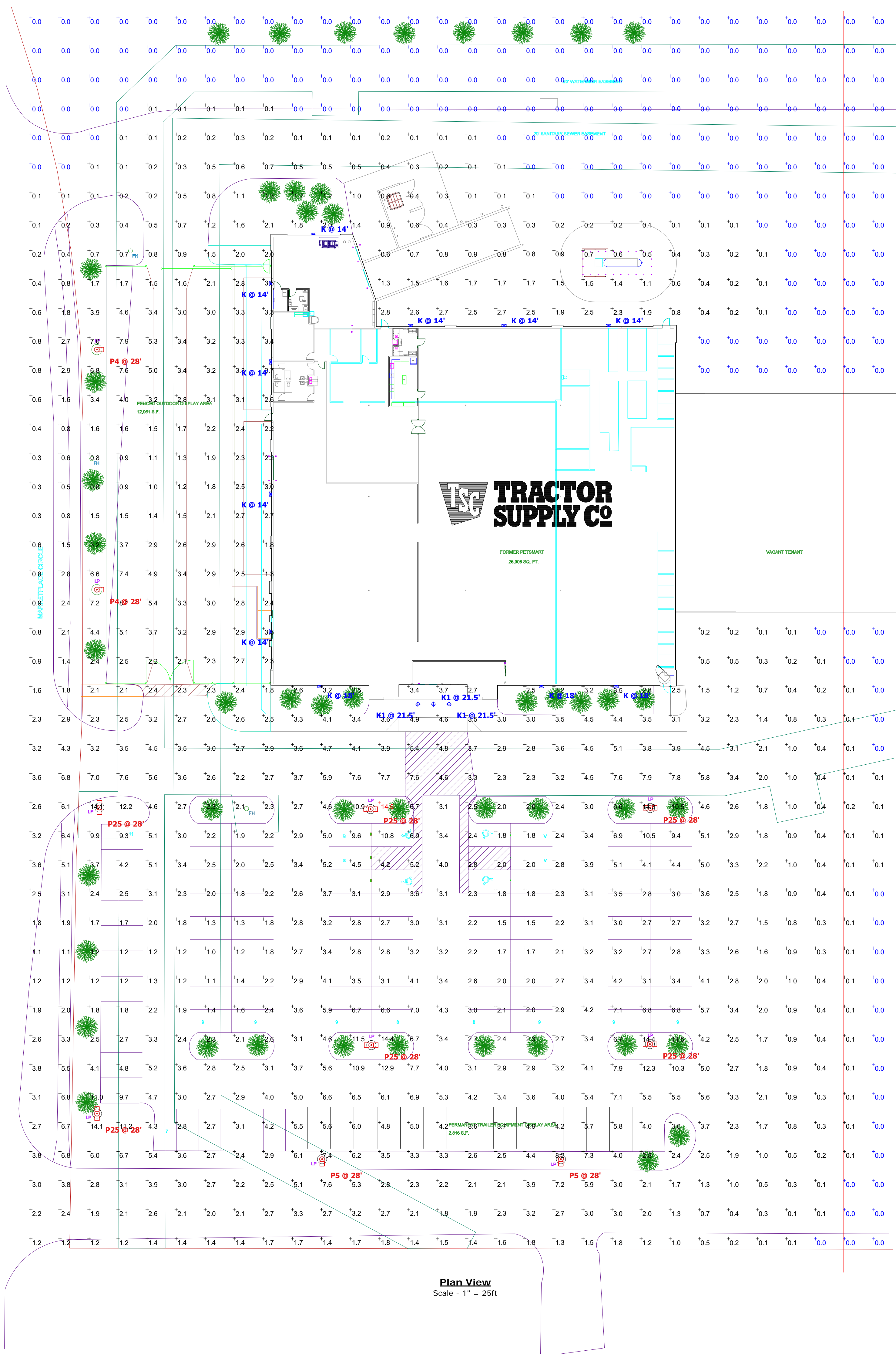

TSC TRACTOR SUPPLY CO

FORMER TENANT
26,808 SQ. FT.

VACANT TENANT

INDUSTRIAL DRIVE

Plan View
Scale - 1" = 25ft

Statistics							
Description	Symbol	Avg	Max	Min	Max/Avg	Max/Min	Avg/Min
Site Light Levels	+	2.2 fc	14.6 fc	0.0 fc	6.64	N/A	N/A

Schedule								
Symbol	Label	Quantity	Catalog Number	Description	Lamp	Light Loss Factor	Wattage	
	K	11	DSXW1-LED-10C-1000-50K-T3M-MVOLT-DDBXD	Lithonia DSXW1 Series Wall Mount LED Unit w/Type T3M Distribution (18ft. and 14ft. Fixture Mounting Heights) FULL CUTOFF DESIGN	LED/5000K (FULL CUTOFF DESIGN)	0.95	38.8	
	K1	3	H-15118-97/HL-AHD-27*97/21/LED2/40/D/BCM-M	Hi-Lite H15118 Series LED Goosneck Unit (21.5ft. Mounting Height) Red Finish (FULL CUTOFF DESIGN)	LED/4000K (FULL CUTOFF DESIGN)	0.95	21	
	P4	2		ESTIMATED EXISTING Single Head 400w Metal Halide Area Unit w/Type T4 Distribution (ESTIMATED 25ft. Pole Height w/3ft. Concrete Base)	400W MH ED37	0.75	460	
	P5	2		ESTIMATED EXISTING Single Head 400w Metal Halide Area Unit w/Type T5 Distribution (ESTIMATED 25ft. Pole Height w/3ft. Concrete Base)	400W MH ED37	0.75	460	
	P25	6		ESTIMATED EXISTING Double Head 180 400w Metal Halide Area Unit w/Type T5 Distribution (ESTIMATED 25ft. Pole Height w/3ft. Concrete Base)	400W MH ED37	0.75	920	

Designer
Adam Carrier
Date
06/14/2022
Scale
Not to Scale
Drawing No.
Summary