

SEAL



PROJECT
Cedar Valley Luxury
Apartments

CLIENT

Bret Russell, Inc.
31000 Telegraph Road
Suite 145
Bingham Farms, MI 48025
Contact:
Bret Russell/Matt Johnson
Phone: (248) 792-5164
Fax: (248) 792-5165
Email: mjohnson@russellbuild.com

PROJECT LOCATION

Part of the Northwest 1/4 of
Section 23, Town 3 North,
Range 11 East,
City of Rochester Hills,
Oakland County, Michigan

SHEET
Irrigation Plan



Know what's below
Call before you dig.

REVISIONS

12-14-18	Site Plan Approved
01-20-17	SPA Revision #1
08-23-17	Amendment to Approved Site Plan
03-27-18	Amendment to Approved Site Plan
04-23-18	Revisions to Amended SPA
05-25-18	Revisions to Amended SPA
06-20-18	SPA Approved w/ Conditions
12-04-18	Planning Commission Submission

DRAWN BY:

DESIGNED BY:

APPROVED BY:

DATE:

12-14-16

SCALE: 1" = 30'

30 15 0 15 30 45

NFE JOB NO.

J401

SHEET NO.

IR1

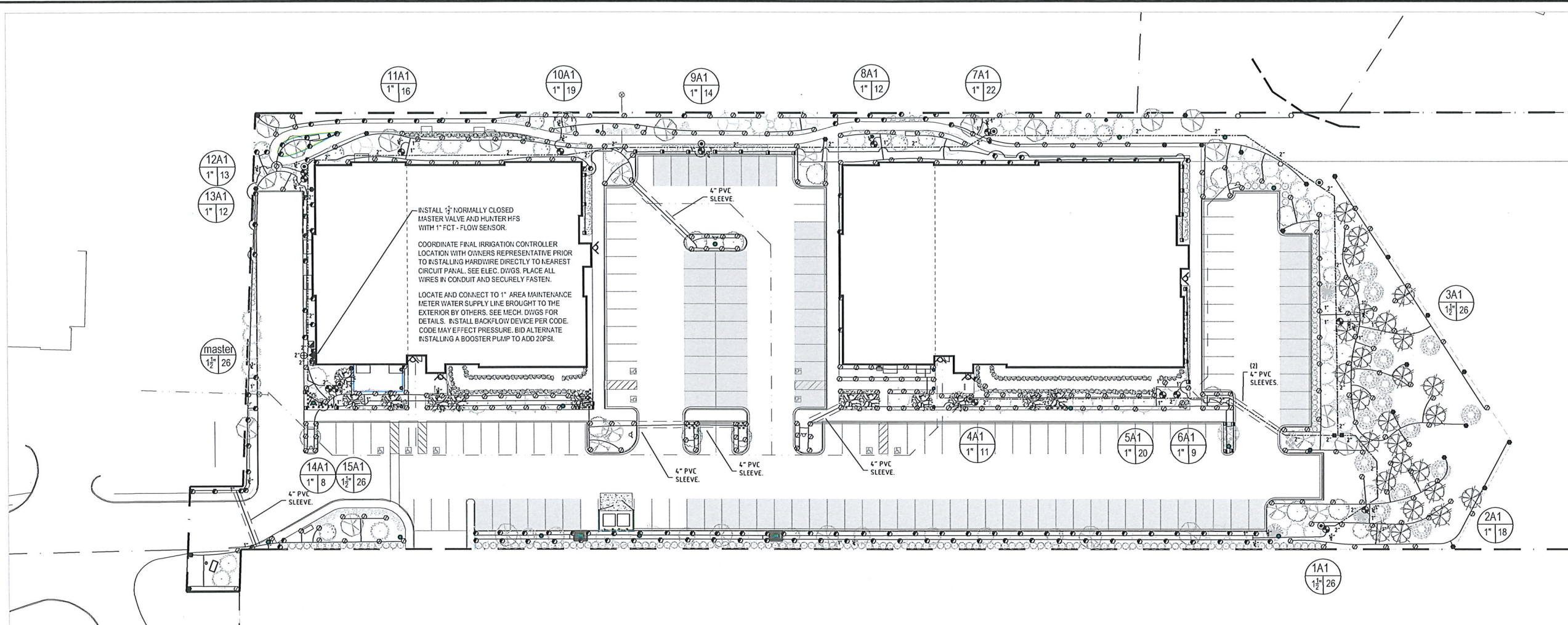

ROCHESTER HILLS NOTES:

- IRRIGATION NOTES:
A. ALL LANDSCAPE AREAS TO BE IRRIGATED
B. IRRIGATION WATERING SHALL ONLY OCCUR BETWEEN THE HOURS OF 12:00 AM AND 5:00 AM

PIPE SIZE CHART

0-12 GPM	= 1" DIAMETER POLYETHYLENE PIPE
12-24 GPM	= 1 1/4" DIAMETER POLYETHYLENE PIPE
24-30 GPM	= 1 1/2" DIAMETER POLYETHYLENE PIPE
30-60 GPM	= 2" DIAMETER POLYETHYLENE PIPE

IRRIGATION LEGEND:

FIXED SPRAY POP-UP (2")	10 Series 12 Series 15 Series Strip Series	Hunter PRO5-12-CV
FIXED SPRAY POP-UP (4") w/ 2" radius nozzle		PRO5-24-CV
FIXED SPRAY POP-UP (4") w/ HFR nozzle		PRO504-PR504-CV
		MP5530/MPLC/RCA5

ELECTRIC VALVE w/ DECODER ICV-Series
 QUICK COUPLER VALVE HQ44RC
 ELECTRIC CONTROLLER ICORE-n-DUAL
 PRESSURE VACUUM BREAKER FBCC 165P150
 ISOLATION GATE VALVE (LINE SIZE)
 RAIN SENSOR DEVICE SOLAR SYNC (wireless)
 POINT OF CONNECTION TO WATER SOURCE See note this sheet
 POLYETHYLENE PIPE, 100% NSF APPROVED, Size as shown
 PVC BREEZES - 50R 26 - Size as shown

VALVE DESIGNATION:
 Controller and Station Number
 Valve Size - Gallons Per Minute

WATER REQUIREMENTS: 21 GPM • 55 PSI
 CONTRACTOR TO VERIFY FEASIBILITY PRIOR TO SYSTEM INSTALLATION

- NOTES:
- Refer to the specifications for installation details and descriptions, as well as, construction methods which will be accepted.
 - All work shall be in compliance with all local, state, and federal codes and ordinances.
 - All electrical connections shall be made using 3m DBY-6 splice kits.
 - All control wiring downstream of the controller shall be HUNTER ID-WIRE paired communication cable - red approved for direct bury.
 - All clamps shall be stainless steel worm gear type clamps. Pipes 1-1/2" or larger shall be double clamped.
 - Pipe routing is schematic. All heads are to be field adjusted to within 2' to take into consideration any obstruction. Final head placements are subject to the landscape architects approval.
 - All sprinkler heads shall be mounted on a 2 elbow poly swing joints as specified.
 - Contractor to verify final controller location with owner's authorized representative prior to installation.
 - All pipe not sized downstream of control valve is 1".
 - All sleeves shall be PVC 150# (see specifications).
 - Irrigation contractor's point of connection to water source shall be as noted on this sheet.
 - Locate and connect to indicated water source. All pipe installed above grade shall be copper type "M".
 - 120v power to the controller locations should be provided others. Coordinate with owner's representative. Hardwire controller directly to nearest circuit panel. Place all wires in conduit per code.
 - Design pressure does not take into account seasonal supply fluctuations. Periods of drought may cause temporary pressure losses to the city water supply resulting in inadequate irrigation system performance. Irrigation design is based on normal weather conditions and typical municipal water supply abilities.
 - Irrigation contractor shall be responsible for determining and maintaining the irrigation schedule during the project construction and throughout the length of the warranty period.
 - The irrigation schedule shall deliver 1" of precipitation per week +/- natural rainfall quantities for turf grass.
 - Landscape material shall receive adjusted amounts of precipitation to maintain proper plant health.
 - Landscape and turf grass shall be irrigated separately.
 - Rotors and spray zones may not be combined to operate at the same time.
 - When specified, follow manufacturer's product recommendations concerning proper installation of water flow sensors. Allow proper straight pipe distances before and after flow sensors.

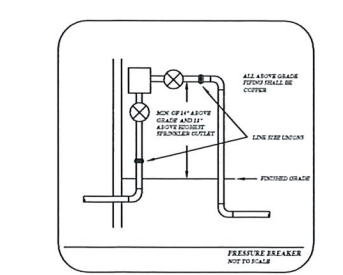
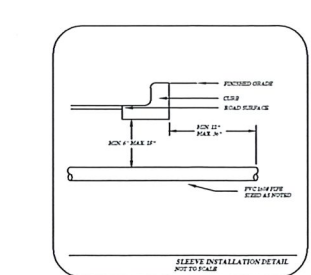
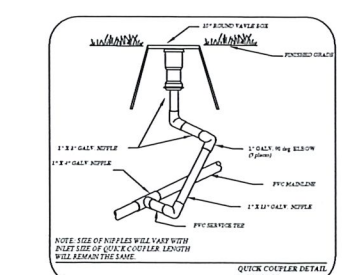
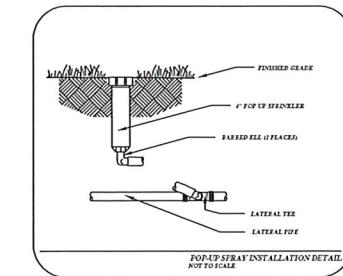
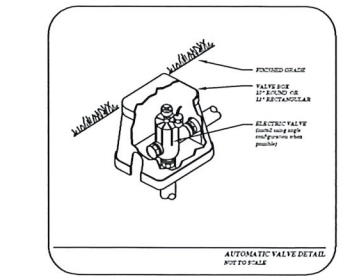
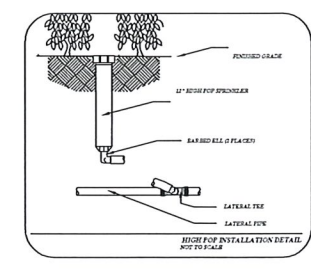
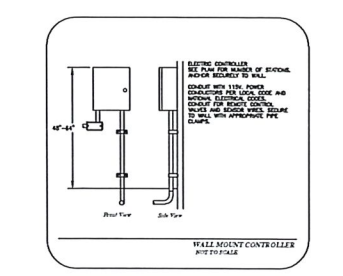
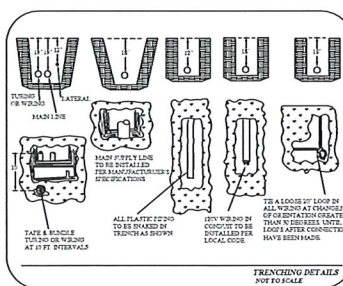
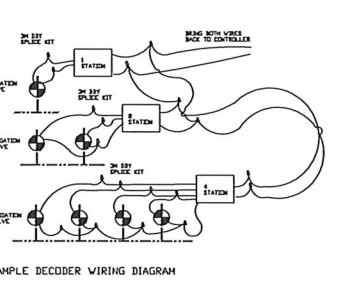
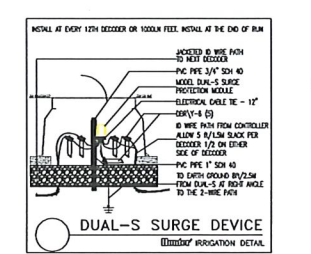
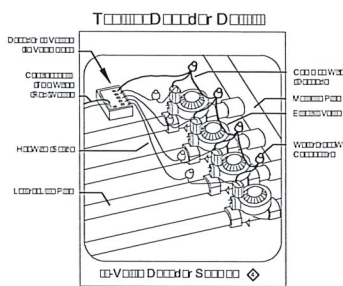
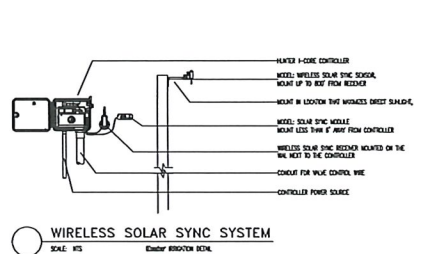

4843 Kittery NW
Comstock Park, Michigan 49321
Tel. (248) 789-0330
email: obornes@lqdsossets.org
www.lqdsossets.org

