

YR. OF INV. 1938	SCHOOL DISTRICT	SEC.	T.	R.	VILLAGE	TOWNSHIP Aven	COUNTY Oakland	CODE NO. 4			
CLASS USE <u>Single-A</u> BUILT <u>1863</u> REMODELED _____ SQ. FT. _____ CU. FT. _____ FOUNDATION <u>Stone</u> ROOFING <u>Gable - wd-shg</u> WALLS <u>Brick</u> CONSTR. <u>Brick</u> BASEMENT <u>Part</u> HEATING <u>steam</u> PLUMBING <u>Fall</u> NO. STORIES <u>2</u> NO. RMS. <u>9</u> FLOORS <u>Pins</u> INT. FINISH <u>Plas - Pine trim</u> LIGHTS <u>Elec</u> MISC. <u>Elec Pump - Septic tank</u> PORCHES <u>2 cov - 1 gb - Enc</u> CONDITION <u>Fair</u> REMARKS _____ OTHER BLDGS. _____											
ASSESSED TO W. W. JERSEY, MRS. ROCHESTER, MICH			RURAL PROPERTY GRAVEL RD.: IMPROVED RD. _____ MI. TRADING CENTER <u>Rochester</u> _____ MI. (Name) R. F. D. _____ MI.; SCHOOL <u>X</u> MI. ELEC. LINE _____ MI. TELEPHONE _____ MI. GAS-LINE _____ MI. WATER SUPPLY <u>Well</u> ADEQUATE <input checked="" type="checkbox"/> YES <input type="checkbox"/> NO PLATTED & VILL. PROP. _____ FRONT. _____ x _____ DEEP _____ K. FACTOR _____ ST. _____ CURB _____ SIDEWALK _____ RUN'G WATER _____ SEWER _____ ELECTRICITY _____ GAS _____ FIRE PROTECTION _____ LAND _____						SUPERVISOR 19 19 19 19 19 19 19 19 19 LAND BLDGS. TOTAL BD. REVIEW LAND BLDGS. TOTAL		
B235 SD 5 T3N, R1E, SEC 15 PART OF NE 1/4 OF SW 1/4 BEG AT A FT IN CEN LINE OF PUBLIC HWY N 83°00'E 244 FT FROM SE COR OF "GOLDEN HILLS SUB.", TH S 9°45'E B235 CONTINUED 117 FT, TH E 275 FT, TH N 9°45'W 221 FT, TH S 83°00'W 275 FT TO BEG PT OF NE 1/4 OF SW 1/4 BEG AT PT IN CEN OF HARDING AVE - DIST S 89°35'50" W 261.20' + S 52°13'45" W 249.57' + S 80°30'10" W 25.66' FROM CEN OF SEC TH S 80°30'10" W ALG SD CEN LINE 275' TH S 12°20'45" E 317' TH N 81°20'05" E 275.24' TH N 12°28'45" W 321' TO BEG.											

MAIN FARM BUILDINGS

BLDG. TYPE	Bak h
YR. BUILT	1965
YR. REMOD.	
DIMENS.	60X 24X 12
CU. FT.	
CONDITION	Fair
FOUND'N.	CONC
EXTERIOR	Flt-1-1-1
ROOF TYPE	Gable
ROOFING	Ykt-She.
FLOORS	Plank
UTILITIES	
BSMT. DIMS.	60X 24X 8
BSMT. WALLS	CONC
BSMT. FLOOR	CONC
REMARKS	

OTHER BLDGS.

FARM FENCES—KIND

POSTS

WOODLOT AND FOREST TIMBER TALLY

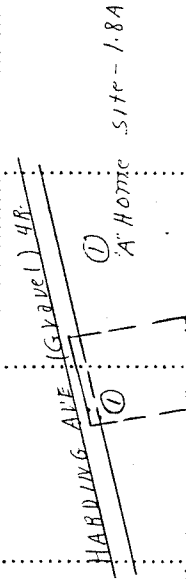

1" = 40 R.

LAND	TYPE	RATE	ACRES	LAND	TYPE	RATE	ACRES	LAND	TYPE	RATE	ACRES	TYPE	BD. FT.	CORDS	STEM CT.	DENSITY
CLASS "A" AGRI-CUL-TURAL	CROPLAND AND FARM-STEAD	1		CLASS "D"		1		CLASS "E"	FOREST AND TIMBER AREA	1						
		2				2										
		3				3										
		4				4										
CLASS "B" SPECL AGRY	WILD HAY	1		COMMERCIAL ORCHARD		1		NON-AGRI-CUL-TURAL	FARM WOOD-LOT	1						
		2				2				2						
		1				3				3						
		2				4				4						
CLASS "C" SWAMP	UNTIL'BLE PASTURE	1		VINE-YARDS		1			CUT-OVER	1						
		2				2				2						
		3				3				SUGAR BUSH						
	TOTAL			TOTAL				TOTAL								

WATER	SPECIAL LAND TYPE	PATING	ACRES
LAKE	Home Site		
WASTE			
TOTAL			

DESIGNATE	GOLF COURSE	RECREATIONAL	OR OTHER	TOTAL

*CLASS "B"—ONION, CELERY, MINT OR TRUCK. †CLASS "C"—HUCKLEBERRY, CRANBERRY, ETC.