

PROPERTY DESCRIPTION:  
 Part of the N.E. 1/4 of Sec. 1, T. 3 N., R. 11 E., City of Rochester Hills, Oakland County, Michigan described as:  
 Beginning at a point in the centerline of Washington Rd., said point located Due North along the East line of said Sec. 1, a distance of 1581.84 ft. and S. 59°33' W. along said centerline 352.35 ft. from the East 1/4 corner of said Sec. 1, thence S. 59°33' W. 120.00 ft.; thence N. 21°34'16" W. 126.52 ft.; thence N. 30°40' W. 677.44 ft.; thence N. 30°00' E. 65.82 ft.; thence N. 59°01'50" E. 42.62 ft.; thence S. 30°40' E. 835.29 ft. to the point of beginning.

GENERAL NOTES

- The type of silt fence specified should be considered when attempting to control sheet flow erosion and sedimentation. A low quality silt fence may require repeated installations or several rows to accomplish the task at hand. Special attention should be given in selecting the proper support system and the grade of geotextile filter fabric.
- The field location should be adjusted, as needed, to provide the most effective control of sheet flow erosion and sedimentation.
- Periodic inspection and required maintenance must be provided to insure that the silt fence continues to operate efficiently.
- The silt fence geotextile filter fabric shall be reinforced with construction hardware cloth, straw bales or approved equal, if the specified silt fence fails under moderate rain storms.
- Before using silt fence as a perimeter sedimentation control measure, consideration should be given to the use of existing vegetative buffer zones.

SEE SHT 2 FOR DETAIL OF E. 15' FROM POND TO TRENCH GRATE

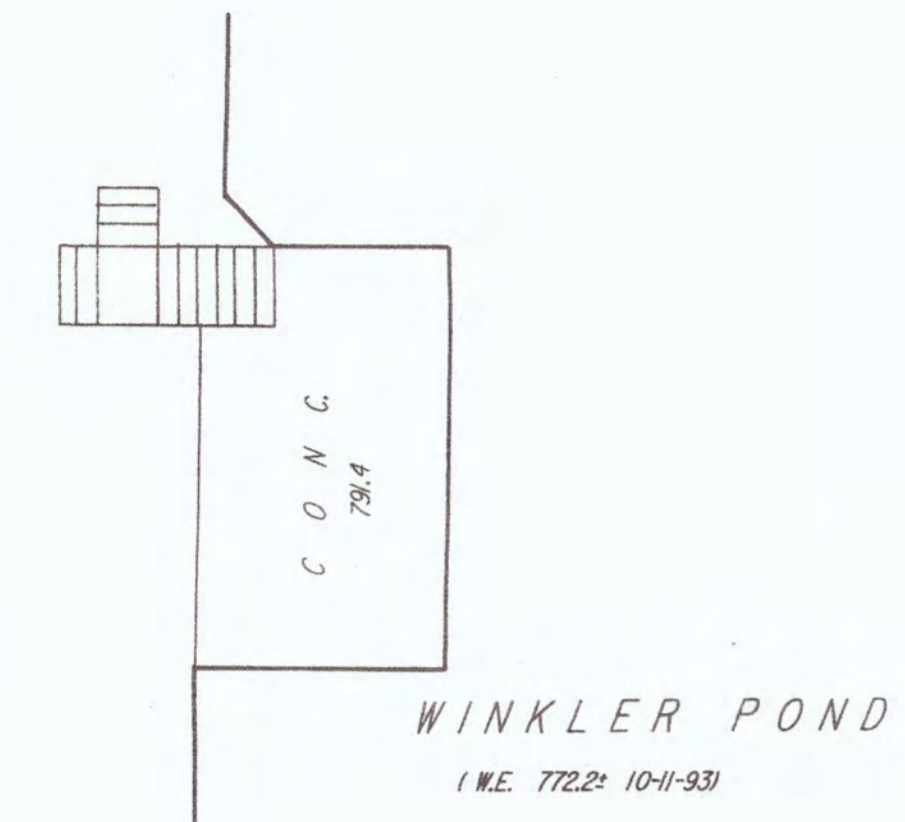

① HOUSE DETAIL SCALE: 1" = 10'  
 000.0 EXISTING ELEVATIONS  
 000.0 PROPOSED GRADE  
 T/W TOP OF WALL  
 000.0 AB = AS-BUILT  
 S = SWALE

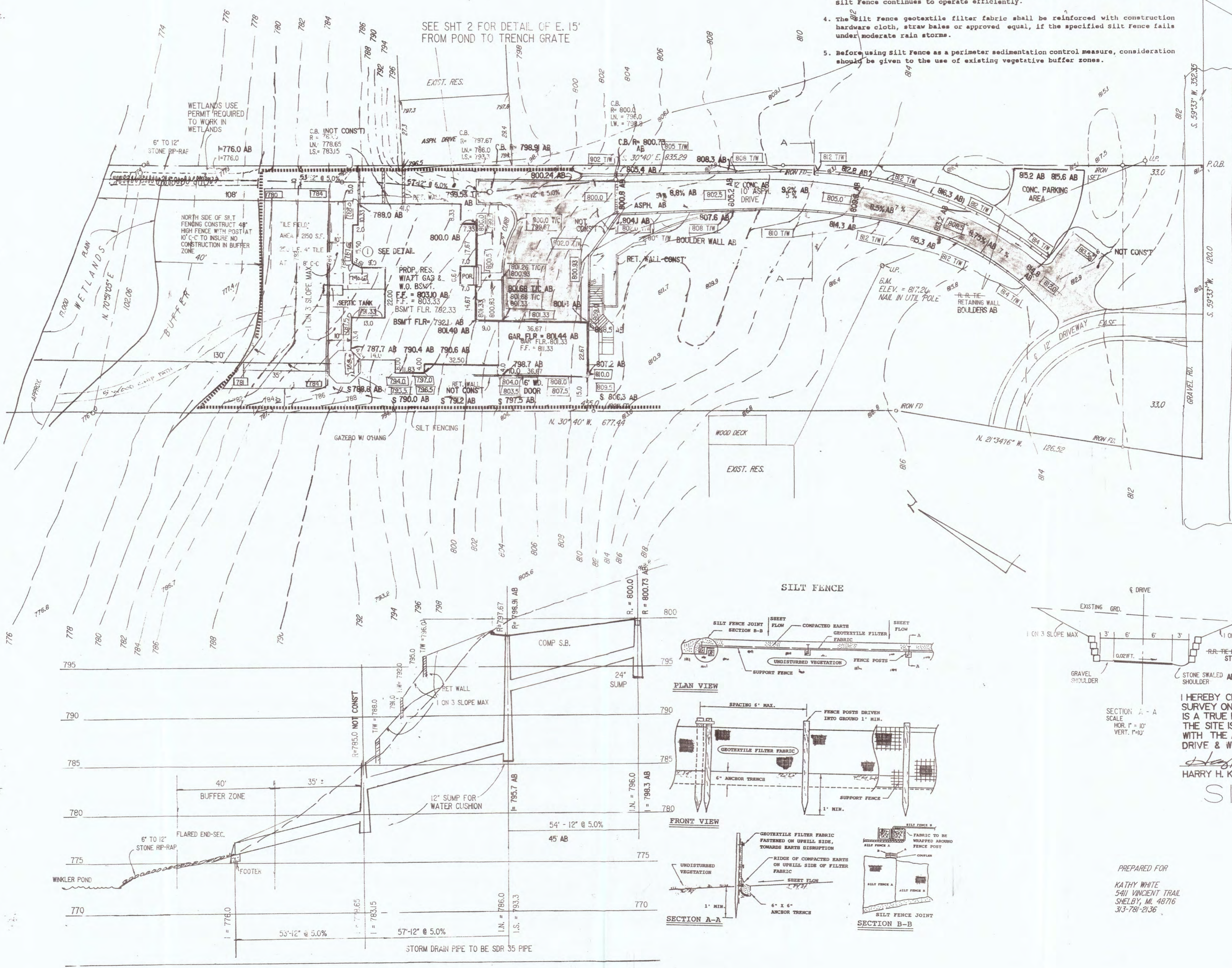

E. 1/4 COR. SEC. 1 T. 3 N., R. 11 E.  
 DUE NORTH 1581.84  
 S. 59°33' W. 352.35  
 S. 59°33' W. 120.00  
 WASHINGTON RD. 93' WD.

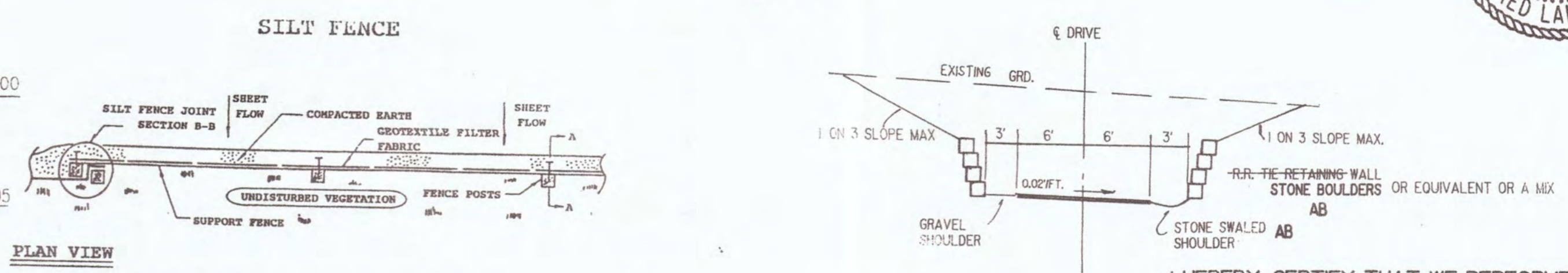

I HEREBY CERTIFY THAT WE PERFORMED AN AS-BUILT SURVEY ON 11-6-96. THIS AS-BUILT GRADING PLAN IS A TRUE REPRESENTATION OF SAID AS-BUILT SURVEY. THE SITE IS GRADED SUBSTANTIALLY IN ACCORDANCE WITH THE APPROVED GRADING PLAN, EXCEPT FOR DRIVE & W'LY SIDE OF RESIDENCE.

HARRY H. KEMNITZ P.S. NO. 16931

SITE PLAN

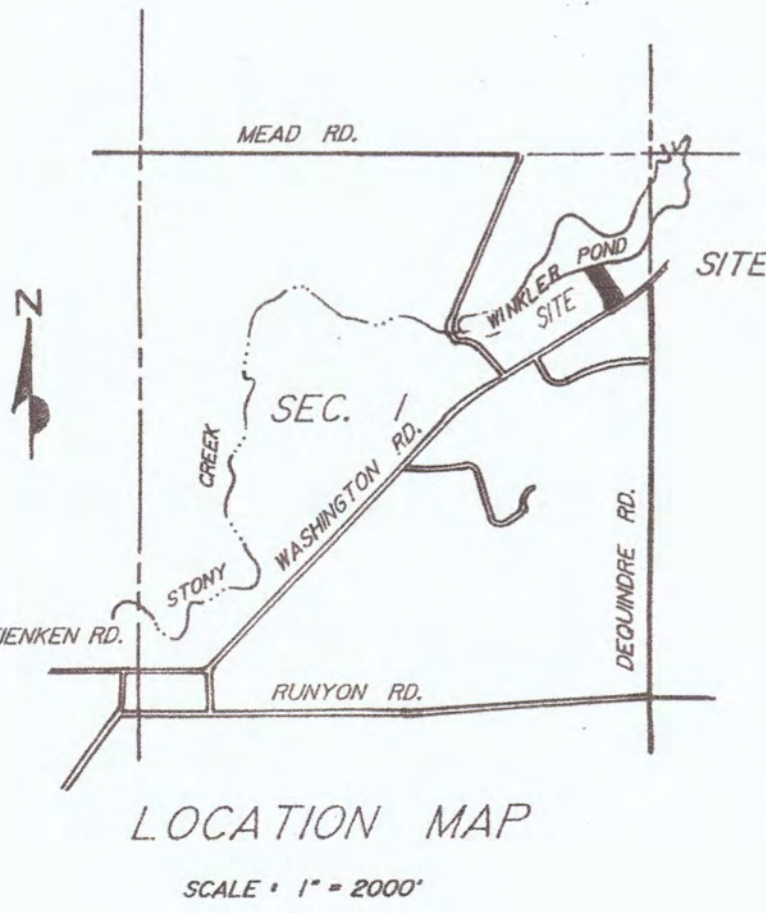

PREPARED FOR  
 KATHY WHITE  
 5411 VINCENT TRAIL  
 SHELBY, MI. 48716  
 313-781-2136

**DEL-TEC**  
 Surveying & Engineering  
 5800 Twelve Mile Rd.  
 Warren, MI 48092  
 (313) 573-8288

SCALE 1"=20'  
 NOV. 7, 1993  
 JOB NO. 4073  
 REVISED: FEB. 15, 1994 AS BUILT: 11-20-96  
 MARCH 18, 1994  
 4-13-a 4  
 6-10-94