

Adams Marketplace

PROPOSED

meijer

Rochester Hills, Michigan

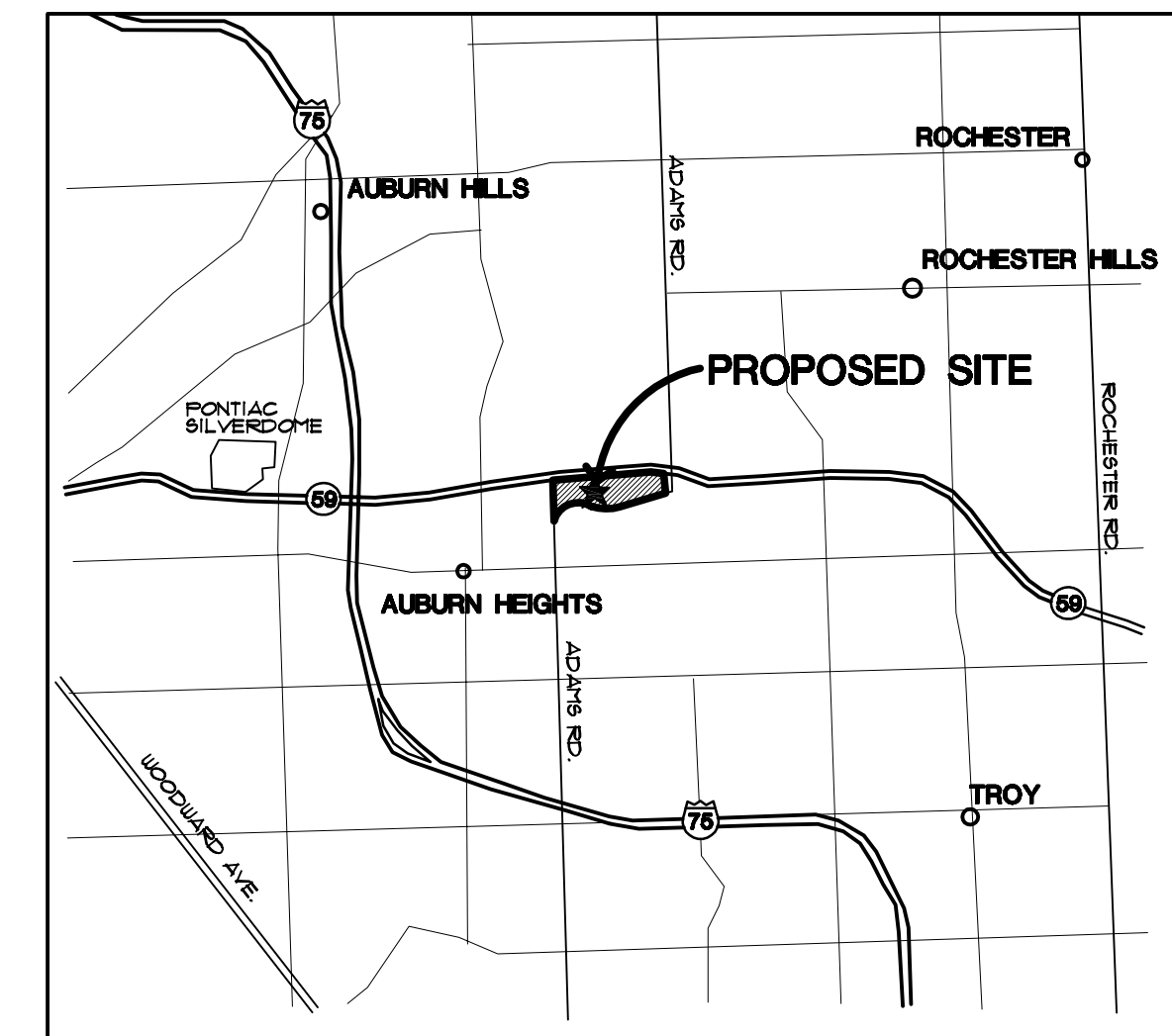

LOCATION MAP
NOT TO SCALE

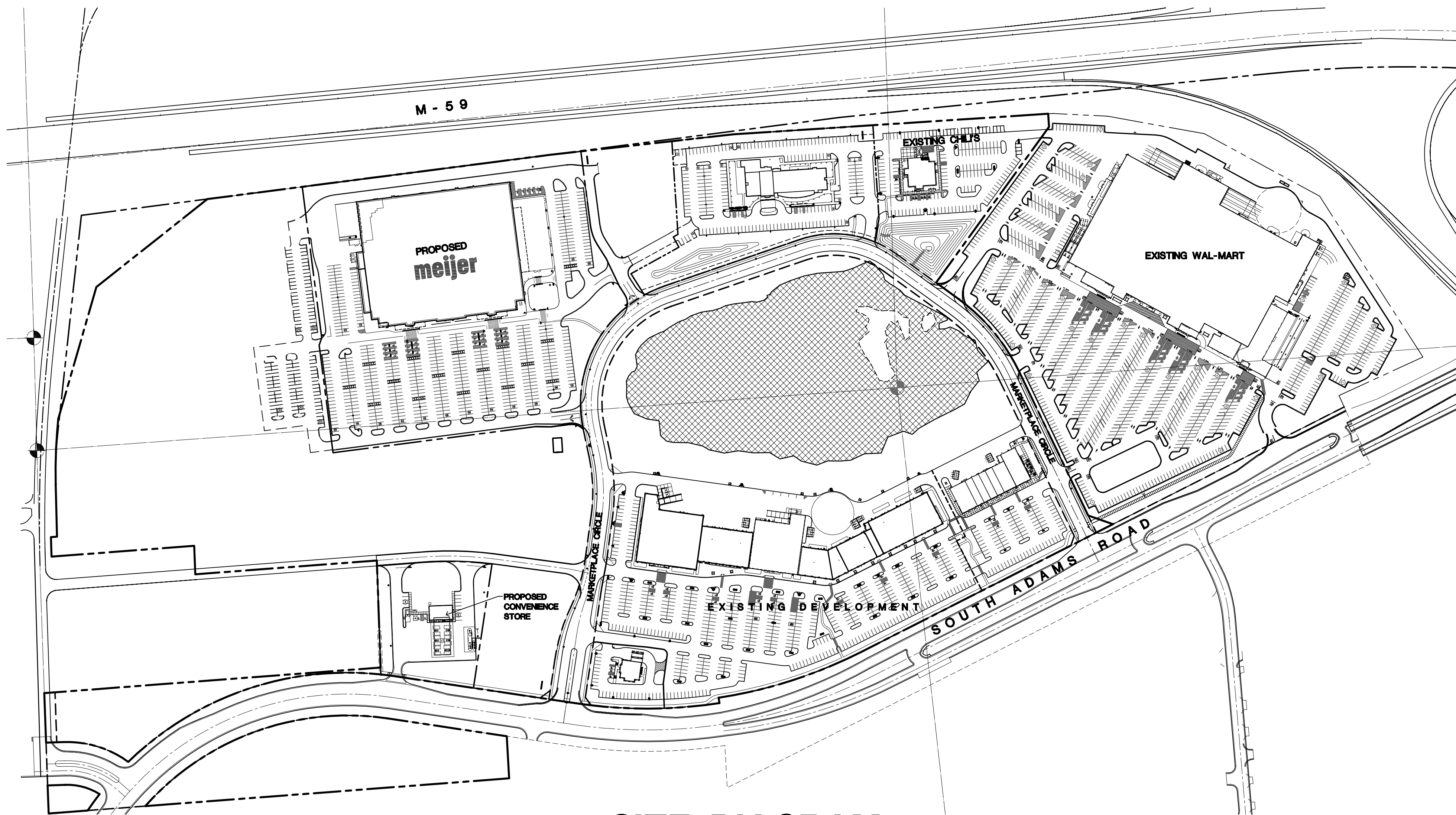

SITE DIAGRAM
SCALE: 1"=200'-0"

GENERAL NOTES:

- THE SITE IS GOVERNED BY CONSENT JUDGEMENT AS OF APRIL 3, 2003 AND AMENDED ON MAY 26, 2004.
- ALL EXTERIOR LIGHTING SHALL BE SHIELDED AND DIRECTED AWAY FROM ADJACENT PROPERTIES.
- ASPHALT SURFACING SHALL BE USED FOR ALL PARKING AREAS AND DRIVEWAYS, AND SHALL MEET ALL ORDINANCE REQUIREMENTS.
- ALL BUILDING AND SITE SIGNAGE SHALL BE SUBMITTED FOR REVIEW AT A LATER DATE AND WILL BE IN CONFORMANCE WITH THE CITY OF ROCHESTER HILLS AND THE CONSENT JUDGEMENT REQUIREMENTS. SEPARATE SIGN PERMIT WILL BE OBTAINED FROM THE BUILDING DEPT.
- BARRIER FREE RAMPS WILL BE PROVIDED AT ALL SIDEWALK APPROACHES.
- ALL ROOF TOP MECHANICAL EQUIPMENT WILL BE SCREENED BY BUILDING PARAPET WALLS AND/OR ROOF TOP UNIT SCREENING.
- TYPICAL BARRIER FREE PARKING SPACE DIMENSION IS 8'X16' WITH EITHER A 8'X16' ACCESS SPACE BETWEEN OR A 8'X16' VAN ACCESSIBLE SPACE BETWEEN PER THE MICHIGAN BARRIER FREE DESIGN MANUAL. ALL BF SPACES SHALL BE MARKED WITH AN ABOVE GRADE SIGN.
- DIMENSIONS FOR PARKING SPACES AND MANEUVERING LANES ARE MEASURED FROM FACE OF CURB.
- THE SITE PLAN SHALL BE SUBJECT TO WRITTEN APPROVAL BY THE CITY'S FIRE MARSHALL.
- THE SITE PLAN SHALL BE SUBJECT TO WRITTEN APPROVAL BY THE CITY'S ENGINEER.

- FIRE LANES SHALL BE DESIGNATED BY THE FIRE CODE OFFICIAL, AND SHALL BE CONSPICUOUSLY POSTED ON BOTH SIDES OF THE FIRE LANE WITH FIRE LANE SIGNS, SPACED NOT MORE THAN 100 FEET APART, (NO STOPPING, STANDING, PARKING, FIRE-LANE), AND IN CONFORMANCE WITH THE MICHIGAN MANUAL OF UNIFORM TRAFFIC CONTROL DEVICES, (FIRE PREVENTION ORDINANCE CHAPTER 98, SEC. 906).
- ALL PORTIONS OF A BUILDING SHALL BE WITHIN 150 FEET OF AN APPROVED FIRE DEPARTMENT ACCESS ROAD.
- FIRE DEPARTMENT ACCESS ROADS SHALL BE A MINIMUM 20' WIDE AND PAVED.
- FDC'S SHALL NOT BE OBSCURED OR OBSTRUCTED BY LANDSCAPING, PARKING OR BY ANY OTHER PERMANENT OR TEMPORARY MATERIALS OR DEVICE, SHALL BE LOCATED VISIBLY ON THE STREET FRONT OF THE BUILDING, AND WITHIN 100 FEET OF A FIRE HYDRANT, AND WITHIN 50 FEET OF AN APPROVED FIRE DEPARTMENT ACCESS ROAD. (FIRE PREVENTION ORDINANCE CHAPTER 98, SEC. 917.1 & SEC. 98-90).
- OPEN BURNING IS NOT PERMITTED INCLUDING THE BURNING OF TRASH, DEBRIS, OR LAND CLEARING MATERIALS. OPEN BURNING FOR WARMING OF SAND AND/OR WATER FOR THE PREPARATION OF MORTAR SHALL BE WITHIN THE CITY OF ROCHESTER HILLS BURN PERMIT GUIDELINES. (FIRE PREVENTION ORDINANCE CHAPTER 98, SE. 3016.2 & 3016.23).
- CONSTRUCTION SITE SHALL BE SAFEGUARDED IN ACCORDANCE WITH IFC 2006 CHAPTER 14, THIS INCLUDES MAINTAINING FIRE DEPARTMENT ACCESS ROADS AND FIRE HYDRANTS OPERATIONAL PRIOR TO BUILDING CONSTRUCTION. ALL FIRE HYDRANTS WILL BE OPERATIONAL PRIOR TO BUILDING CONSTRUCTION BASED ON THE IFC 2006.

- FIRE HYDRANT REQUIREMENTS WILL BE BASED ON CONSTRUCTION TYPE AND SQUARE FOOTAGE OF THE BUILDING.
- THERE WILL BE NO INDUSTRIAL WASTE OR PROPANE TANKS LOCATED ON-SITE.
- ALL CURBED PARKING LOT ISLANDS SHALL BE 2-3 FEET SHORTER THAN THE ADJACENT PARKING SPACES AND DRIVEWAYS.
- SEE PHOTOMETRIC PLAN FOR EXACT LOCATION OF PROPOSED LIGHT POLES.
- ACCESS TO PROPOSED CONSTRUCTION SITE SHALL BE PROVIDED AND MAINTAINED FROM BOTH NEW ADAMS ROAD AND MARKETPLACE CIRCLE.
- ALL HANDICAP SPACES ARE TO RECEIVE A HANDICAP SIGN AND HANDICAP SYMBOL PAINTED ON THE ASPHALT. THE STALL ADJACENT TO 8 FOOT STRIPED AISLE IS TO RECEIVE A "VAN ACCESSIBLE" SIGN.
- HANDICAP RAMPS TO HAVE MAXIMUM 1/2 SLOPE AND MUST BE CONSTRUCTED PER ADA AND MICHIGAN BARRIER FREE STANDARDS.
- A "KNOX" KEY SYSTEM SHALL BE INSTALLED, IN A LOCATION APPROVED BY THE FIRE CODE OFFICIAL. ORDERING INFORMATION IS AVAILABLE FROM THE FIRE DEPARTMENT. (IFC 2006 SEC. 906).
- DETECTABLE WARNING SURFACE SHALL COMPLY WITH THE REQUIREMENT PER THE AMERICAN NATIONAL STANDARD ACCESSIBLE AND USABLE BUILDINGS AND FACILITIES, (ICC/ANSI A117-1.2003).

| | |
|---|---|
| OWNER : ROCHESTER HILLS MARKETPLACE LLC 28470 THIRTEEN ROAD, SUITE 200 FARMINGTON HILLS, MICHIGAN 48334 (248) 855-5500 CONTACT: WILLIAM EISENBERG | LANDSCAPE ARCHITECT : ATWELL-HICKS 140 MONROE CENTER GRAND RAPIDS, MICHIGAN 49503 (616) 242-2000 CONTACT: JOHN ACKERMAN |
| CIVIL ENGINEER : ATWELL-HICKS 140 MONROE CENTER GRAND RAPIDS, MICHIGAN 49503 (616) 242-2000 CONTACT: STEVE ACHRAM | ARCHITECT : FISHBECK, THOMPSON, CARR & HUBER, INC. DESIGNER ARCHITECT 1515 ARBORETUM DR. GRAND RAPIDS, MI 49546 (616) 575-3824 CONTACT: GLENN SIGSBY |
| ZEMET / WOZNIAK AND ASSOC. 40024 Grand River Avenue, Suite 100 Novi, Michigan 48375 (248) 442-1101 CONTACT: RICK HOPSES | ROGVOY ARCHITECTS COORDINATING ARCHITECT 32500 TELEGRAPH ROAD SUITE 250 BINGHAM FARMS, MI 48025 (248) 540-1100 CONTACT: MARK DRANE, A.I.A. |

| | |
|------------------------------|--|
| SHEET INDEX : | |
| COVER | COVER |
| C200 | SITE LAYOUT PLAN |
| 9P-11 | GRADING PLAN (STORE) |
| 9P-12 | GRADING DETAILS |
| 9P-2 | GRADING PLAN (CONVENIENCE STORE) |
| 9P-3 | UTILITY PLAN (STORE) |
| 9P-4 | UTILITY PLAN (CONVENIENCE STORE) |
| 9P-5 | STORMWATER MANAGEMENT PLAN |
| 9P-6 | EROSION CONTROL PLAN |
| 9P-7 | ALTA / ACSM LAND TITLE SURVEY |
| C600 | LANDSCAPE PLAN |
| C601 | LANDSCAPE DETAILS |
| C602 | IRRIGATION PLAN |
| C603 | IRRIGATION PLAN |
| C100 | DETAILS |
| C801 | PHOTOMETRIC PLAN |
| B-L | OVERALL FLOOR PLAN (STORE) |
| B-L | BUILDING ELEVATIONS (STORE) |
| A-101 | FLOOR PLAN (CONVENIENCE STORE) |
| B | BUILDING ELEVATIONS (CONVENIENCE STORE) |
| EXHIBIT A | SIGHTLINE SECTION : VIEW POINT LOCATIONS |
| EXHIBIT B | SIGHTLINE SECTIONS |
| SUPPLEMENTAL DRAWINGS | |
| SHEET 26 OF 99 | ADAMS ROAD RELOCATION |
| SHEET 27 OF 99 | ADAMS ROAD RELOCATION |
| AUTOTURN | FIRE AND DELIVERY TRUCK ACCESS EXHIBIT |

issued for:

| | |
|---------|-------------|
| REVISED | 28 AUG. 08 |
| SPA | 2 SEPT. 08 |
| REVISED | 30 SEPT. 08 |
| SPA | 3 OCT. 08 |
| REVISED | 28 OCT. 08 |
| SPA | 14 NOV. 08 |

project:

Adams Marketplace
 PROPOSED MEIJER STORE
 Rochester Hills, Michigan

ROGVOY ARCHITECTS

32500 TELEGRAPH ROAD
SUITE 250
BINGHAM FARMS, MICHIGAN
48025-2404

PH 248.540.7700 FX 248.540.2710
ARCHITECTS@ROGVOY.COM



drawing: **COVER**

DO NOT SCALE DRAWING

issue date: 14 Nov. 08
drawn: S.V.
checked: M.D.
approved: M.D.

file number: **02053**

sheet: **COVER**
CITY FILE NO. 08-005 SEC. 30
02053 COVER 08-1028

G:\Drawings\02053\02 COVER 08-1028.dwg, 12/29/2008 1:43:11 PM, Svetlana



- BENCH MARKS**
- 1) BENCH MARK TIE W/ YELLOW FLAG WEST SIDE OF POWER POLE AT NORTHWEST CORNER OF WAL MART PARCEL. ELEV. 856.54
 - 2) ARROW ON HYDRANT, WEST SIDE OF ADAMS RD. AT INTERSECTION OF INDUSTRIAL DRIVE. ELEV. 867.28
 - 3) BENCH MARK TIE W/ YELLOW FLAG SOUTH SIDE OF POWER POLE AT NORTHEAST CORNER OF WAL MART PARCEL. ELEV. 842.28
 - 4) BENCH MARK TIE W/ YELLOW FLAG EAST SIDE OF POWER POLE NORTH SIDE OF INDUSTRIAL DRIVE AT EAST END OF ROAD. ELEV. 874.96

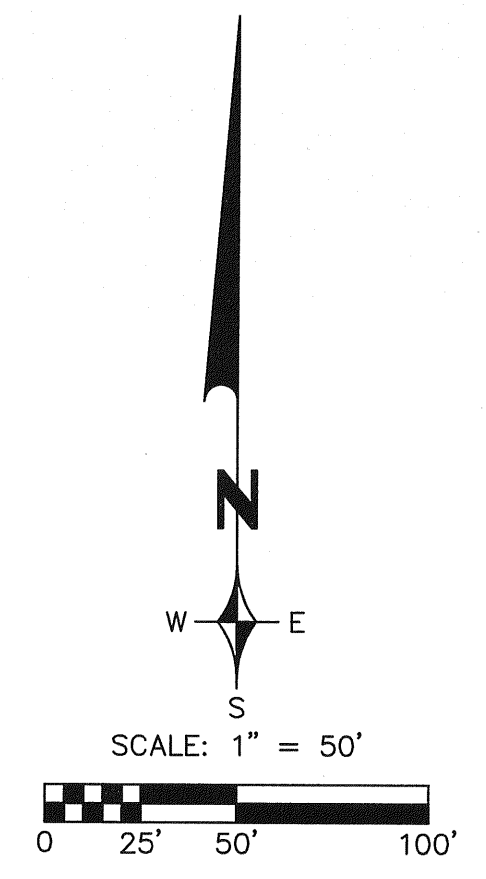

- LEGEND**
- | EXISTING | PROPOSED |
|------------------|------------------|
| ○ MANHOLE | ● MANHOLE |
| □ CATCH BASIN | ■ CATCH BASIN |
| ⊠ INLET | ⊠ INLET |
| ○ CLEANOUT | ○ CLEANOUT |
| ◊ END SECTION | ◊ END SECTION |
| ◊ ROOF DRAIN | ◊ ROOF DRAIN |
| ⊕ GATE VALVE | ⊕ GATE VALVE |
| ⊕ HYDRANT | ⊕ HYDRANT |
| ⊕ WATER SHUT-OFF | ⊕ WATER SHUT-OFF |
| ⊕ UTILITY POLE | ⊕ UTILITY POLE |
| ⊕ GUY ANCHOR | ⊕ GUY ANCHOR |
| ⊕ LIGHT POLE | ⊕ LIGHT POLE |
| ⊕ SIGN | ⊕ SIGN |
| ⊕ TREE | ⊕ TREE REMOVAL |
| — TREE LINE | — SANITARY SEWER |
| — SANITARY SEWER | — STORM SEWER |
| — STORM SEWER | — WATER MAIN |
| — WATER MAIN | — GAS MAIN |
| — GAS MAIN | — ELECTRIC CABLE |
| — ELECTRIC CABLE | — CONTOUR MAJOR |
| — CONTOUR MAJOR | — CONTOUR MINOR |
| — CONTOUR MINOR | — PROPOSED GRADE |
| — SPOT ELEVATION | — PROPOSED GRADE |
- T/C = TOP OF CURB
 T/W = TOP OF WALK
 T/P = TOP OF PAVEMENT
 GU = GUTTER
 FG = FINISH GRADE
 FF = FINISH FLOOR
 T/SLAB = TOP OF SLAB
 T/WALL = TOP OF WALL

- NOTES:**
1. EXISTING TOPOGRAPHY SHOWN AS PROVIDED BY AIR-LAND SURVEYS INC., JOB NO. 01408 AND AS SUPPLEMENTED BY ZWA.
 2. SEED & MULCH ALL DISTURBED AREAS DUE TO GRADING. PEAT, OR ANY OTHER UNSUITABLE MATERIALS ENCOUNTERED IN CONSTRUCTION AREAS SHALL BE REMOVED AND BACKFILLED WITH COMPACTED SUITABLE MATERIAL (95% DENSITY). ALL ON-SITE WORK SHALL CONFORM, AT A MINIMUM, TO THE CURRENT STANDARDS AND SPECIFICATIONS OF THE CITY OF ROCHESTER HILLS.
 3. ALL WORK SHALL CONFORM TO THE CURRENT STANDARDS AND SPECIFICATIONS OF THE CITY OF ROCHESTER HILLS.
 4. ADD 800.00 TO ALL PROPOSED GRADES TO OBTAIN SITE DATUM ELEVATION.
 5. PROVIDE DETECTABLE WARNING STRIP AT ALL BARRIER FREE RAMPS.

- PAVEMENT SPECIFICATIONS:**
- | | |
|--|---|
| <p>HEAVY DUTY ASPHALT: 2.0" M.D.O.T. 1100T, 20AA 2.5" M.D.O.T. 1100L, 20AA 10" 21AA AGGREGATE BASE (COMPACTED TO 95% MAX. UNIT DENSITY) BOND COAT SS-1H @ 0.1 GAL/SY</p> | <p>CONCRETE SLAB: (PHARMACY DRIVE) 6" REINFORCED MDOT P1 CONCRETE ON 4" 21AA AGGREGATE BASE (COMPACTED TO 95% MAX. UNIT DENSITY)</p> |
| <p>REGULAR DUTY ASPHALT: 1.5" M.D.O.T. 1100T, 20AA 2.0" M.D.O.T. 1100L, 20AA 8" 21AA AGGREGATE BASE (COMPACTED TO 95% MAX. UNIT DENSITY) BOND COAT SS-1H @ 0.1 GAL/SY</p> | <p>CONCRETE SIDEWALK: 4" UNIFORM CONCRETE ON 4" SAND BASE (COMPACTED TO 95% MAX. UNIT DENSITY)</p> |
| | <p>CONCRETE TRUCK WELL: 7.5" MDOT P1 CONCRETE ON 8" 21AA AGGREGATE BASE (COMPACTED TO 95% MAX. UNIT DENSITY)</p> |

(PAVEMENT SECTIONS SUBJECT TO RECOMMENDATION OF A QUALIFIED GEOTECHNICAL ENGINEER)

NOTE:
THE LOCATIONS OF EXISTING UNDERGROUND UTILITIES ARE SHOWN IN AN APPROXIMATE WAY ONLY AS DISCLOSED BY AVAILABLE UTILITY COMPANY RECORDS AND HAVE NOT BEEN INDEPENDENTLY VERIFIED BY THE COMPANY. NO GUARANTEE IS EITHER EXPRESSED OR IMPLIED AS TO THE COMPLETENESS OR ACCURACY THEREOF. THE CONTRACTOR SHALL DETERMINE THE EXACT LOCATION OF ALL EXISTING UTILITIES BEFORE COMMENCING WORK, AND AGREES TO BE FULLY RESPONSIBLE FOR ANY AND ALL DAMAGES WHICH MIGHT BE OCCASIONED BY THE CONTRACTOR'S FAILURE TO EXACTLY LOCATE AND PRESERVE ANY AND ALL UNDERGROUND UTILITIES. THE CONTRACTOR SHALL NOTIFY THE DESIGN ENGINEER IMMEDIATELY IF A CONFLICT IS APPARENT.

| REVISIONS | DATE | BY | REVISIONS | DATE | BY | REVISIONS | DATE | BY | REVISIONS | DATE | BY |
|-----------------|----------|-----|-----------|------|----|-----------|------|----|-----------|------|----|
| PER CITY REVIEW | 10/3/08 | SRB | | | | | | | | | |
| PER CITY REVIEW | 11/12/08 | SRB | | | | | | | | | |

ZEMET WOZNIAK & ASSOCIATES
Civil Engineers & Land Surveyors
40024 GRAND RIVER AVE. SUITE 100
NOVI, MICHIGAN 48275
P: (248) 442-1101 F: (248) 442-1241 www.zemetwozniak.com

MISS DIG SYSTEM, INC.
THREE HULL WORKING DAYS BEFORE YOU DIG, CALL THE MISS DIG SYSTEM 1-800-482-7171

PROJECT SPONSOR:
GRAND SAKWA PROPERTIES
28470 THIRTEEN MILE ROAD, SUITE 220
FARMINGTON HILLS, MI (248) 855-5500

ADAMS MARKETPLACE
GRADING PLAN (STORE)
MEIJER
ROCHESTER HILLS, MICHIGAN

NOT FOR CONSTRUCTION
CITY FILE 08-005

DATE: 9/22/08 SCALE: HOR: 1" = 50' VER: 1" = N/A
DESIGNED BY: SRB JOB NO.: 97144
DRAWN BY: DAB SHEET: SP-1.1

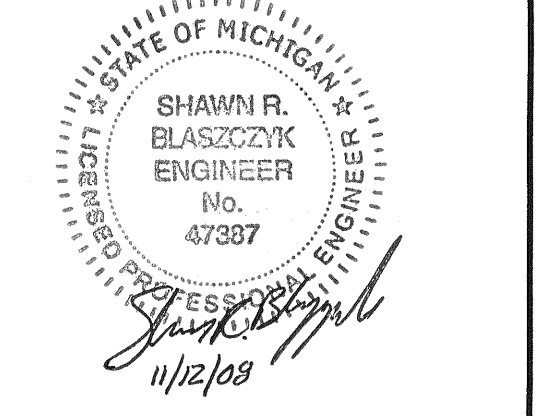

H:\Projects\0714\AdamsMarketplace\Grading\Store_Site_Plan.dwg, grading store, 11/12/2008 7:18:01 AM, SBBlaszczk

© COPYRIGHT 2008

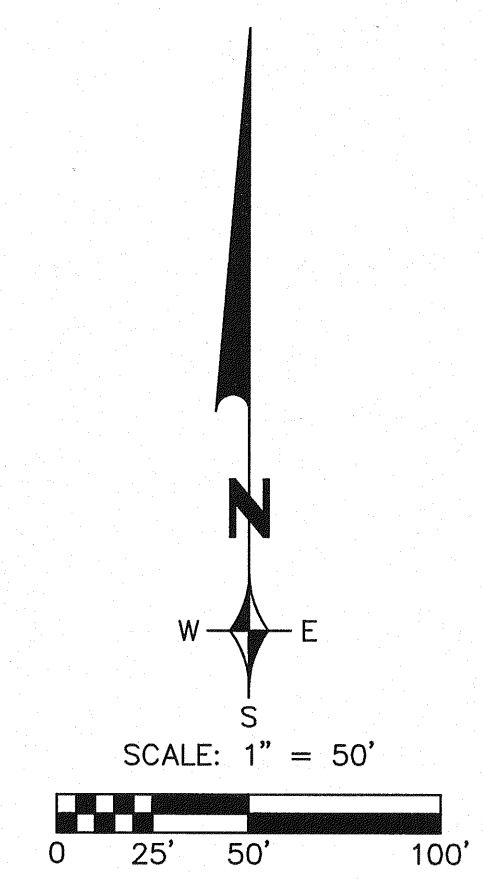
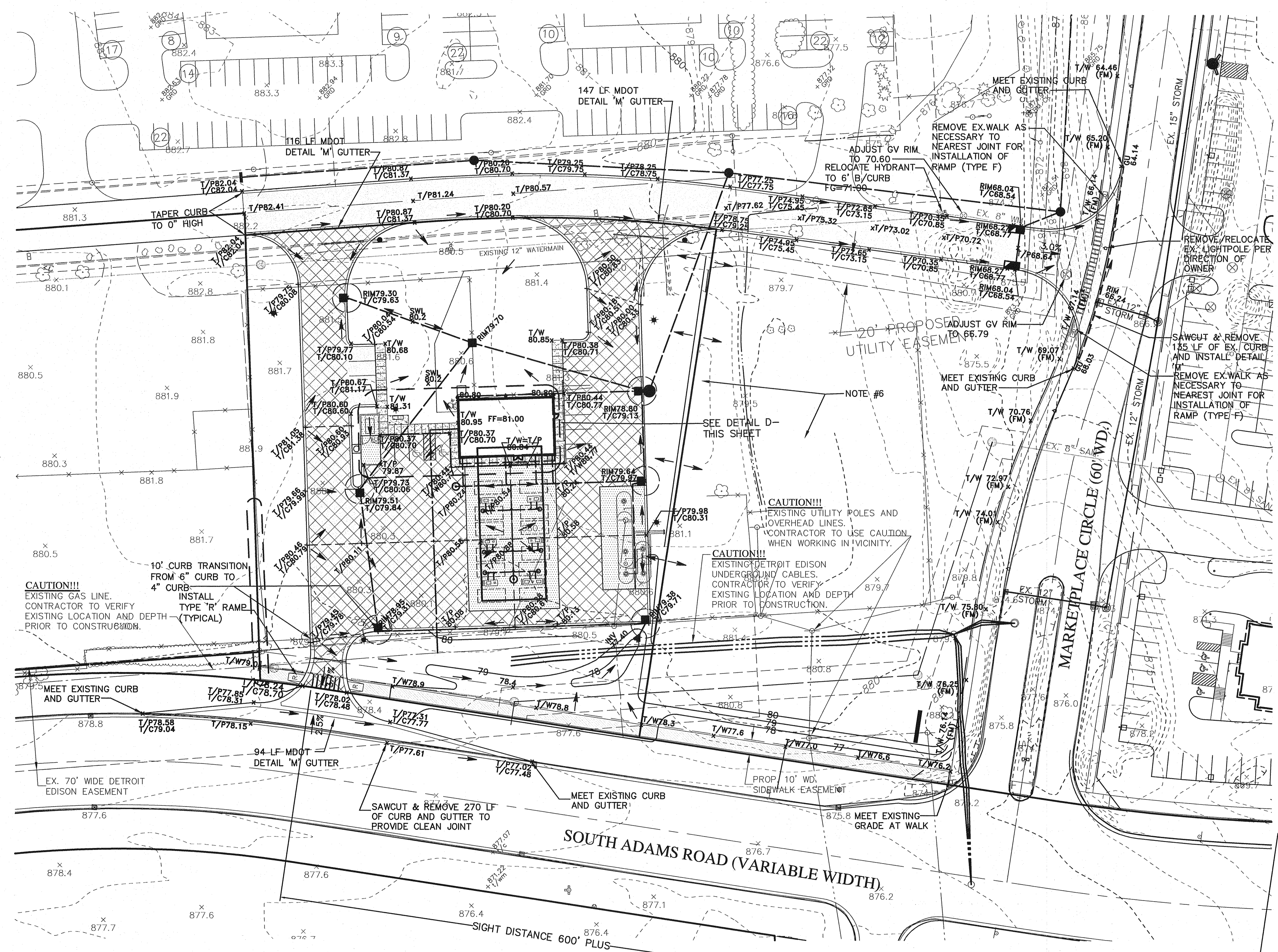

- BENCH MARKS**
- 1) BENCH MARK TIE W/ YELLOW FLAG WEST SIDE OF POWER POLE AT NORTHWEST CORNER OF WAL MART PARCEL. ELEV. 856.54
 - 2) ARROW ON HYDRANT, WEST SIDE OF ADAMS RD. AT INTERSECTION OF INDUSTRIAL DRIVE. ELEV. 867.28
 - 3) BENCH MARK TIE W/ YELLOW FLAG SOUTH SIDE OF POWER POLE AT NORTHEAST CORNER OF WAL MART PARCEL. ELEV. 842.28
 - 4) BENCH MARK TIE W/ YELLOW FLAG EAST SIDE OF POWER POLE NORTH SIDE OF INDUSTRIAL DRIVE AT EAST END OF ROAD. ELEV. 874.96

- LEGEND**
- | EXISTING | PROPOSED |
|------------------|------------------|
| ○ MANHOLE | ● MANHOLE |
| □ CATCH BASIN | ■ CATCH BASIN |
| ◇ INLET | ◆ INLET |
| ○ CLEANOUT | ○ CLEANOUT |
| ○ END SECTION | ○ END SECTION |
| ○ ROOF DRAIN | ○ ROOF DRAIN |
| ○ GATE VALVE | ○ GATE VALVE |
| ○ HYDRANT | ○ HYDRANT |
| ○ WATER SHUT-OFF | ○ WATER SHUT-OFF |
| ○ UTILITY POLE | ○ UTILITY POLE |
| ○ GUY ANCHOR | ○ GUY ANCHOR |
| ○ LIGHT POLE | ○ LIGHT POLE |
| ○ SIGN | ○ SIGN |
| ○ TREE | ○ TREE REMOVAL |
| ○ TREE LINE | ○ TREE LINE |
| ○ SANITARY SEWER | ○ SANITARY SEWER |
| ○ STORM SEWER | ○ STORM SEWER |
| ○ WATER MAIN | ○ WATER MAIN |
| ○ GAS MAIN | ○ GAS MAIN |
| ○ ELECTRIC CABLE | ○ ELECTRIC CABLE |
| ○ CONTOUR MAJOR | ○ CONTOUR MAJOR |
| ○ CONTOUR MINOR | ○ CONTOUR MINOR |
| ○ SPOT ELEVATION | ○ SPOT ELEVATION |

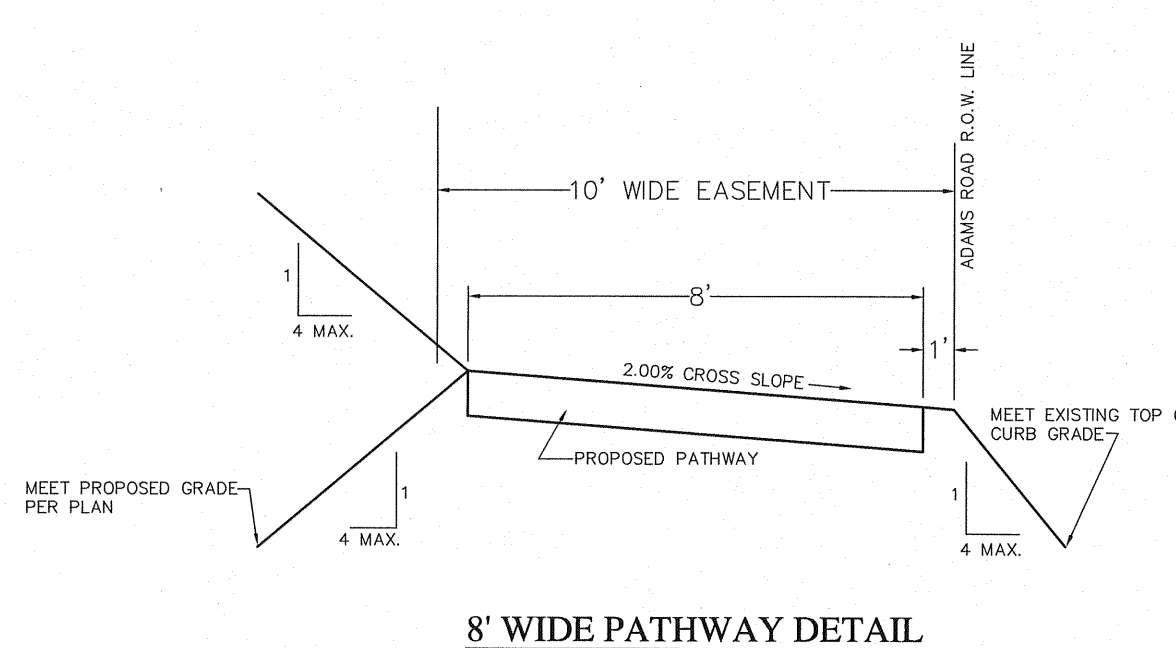

CAUTION!!!
EXISTING GAS LINE. CONTRACTOR TO VERIFY EXISTING LOCATION AND DEPTH PRIOR TO CONSTRUCTION.

CAUTION!!!
EXISTING DETROIT EDISON UNDERGROUND CABLES. CONTRACTOR TO VERIFY EXISTING LOCATION AND DEPTH PRIOR TO CONSTRUCTION.

CAUTION!!!
EXISTING UTILITY POLES AND OVERHEAD LINES. CONTRACTOR TO USE CAUTION WHEN WORKING IN VICINITY.

- NOTES:**
1. EXISTING TOPOGRAPHY SHOWN AS PROVIDED BY AIR-LAND SURVEYS INC., JOB NO. 01408.
 2. SEED & MULCH ALL DISTURBED AREAS DUE TO GRADING.
 3. PEAT, OR ANY OTHER UNSUITABLE MATERIALS ENCOUNTERED IN CONSTRUCTION AREAS SHALL BE REMOVED AND BACKFILLED WITH COMPACTED SUITABLE MATERIAL (95% DENSITY). ALL ON-SITE WORK SHALL CONFORM, AT A MINIMUM, TO THE CURRENT STANDARDS AND SPECIFICATIONS OF THE CITY OF ROCHESTER HILLS.
 4. ALL WORK SHALL CONFORM TO THE CURRENT STANDARDS AND SPECIFICATIONS OF THE CITY OF ROCHESTER HILLS.
 5. ADD 800.00 TO ALL PROPOSED GRADES TO OBTAIN SITE DATUM ELEVATION.
 6. EXISTING BUILDINGS TO BE REMOVED BY OTHERS UNDER SEPARATE PERMIT.
 7. PROVIDE DETECTABLE WARNING STRIP AT ALL BARRIER FREE RAMPS.

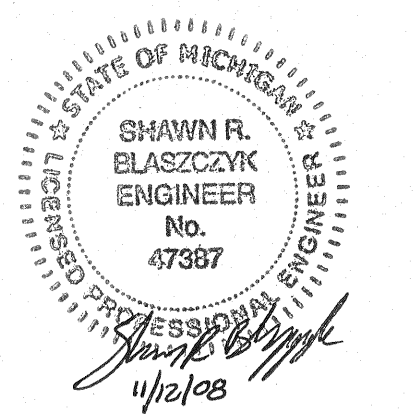

NOTICE:

CONSTRUCTION SITE SAFETY IS THE SOLE RESPONSIBILITY OF THE CONTRACTOR. NEITHER THE OWNER NOR THE ENGINEER SHALL BE EXPECTED TO ASSUME ANY RESPONSIBILITY FOR SAFETY OF THE WORK, OF PERSONS ENGAGED IN THE WORK, OF ANY NEARBY STRUCTURES, OR OF ANY OTHER PERSONS.

NOTE:

THE LOCATIONS OF EXISTING UNDERGROUND UTILITIES ARE SHOWN IN AN APPROXIMATE WAY ONLY AS DISCLOSED BY AVAILABLE UTILITY COMPANY RECORDS AND HAVE NOT BEEN INDEPENDENTLY VERIFIED BY THE COMPANY. NO GUARANTEE IS EITHER EXPRESSED OR IMPLIED AS TO THE COMPLETENESS OR ACCURACY THEREOF. THE CONTRACTOR SHALL DETERMINE THE EXACT LOCATION OF ALL EXISTING UTILITIES BEFORE COMMENCING WORK, AND AGREES TO BE FULLY RESPONSIBLE FOR ANY AND ALL DAMAGES WHICH MIGHT BE OCCASIONED BY THE CONTRACTOR'S FAILURE TO EXACTLY LOCATE AND PRESERVE ANY AND ALL UNDERGROUND UTILITIES. THE CONTRACTOR SHALL NOTIFY THE DESIGN ENGINEER IMMEDIATELY IF A CONFLICT IS APPARENT.

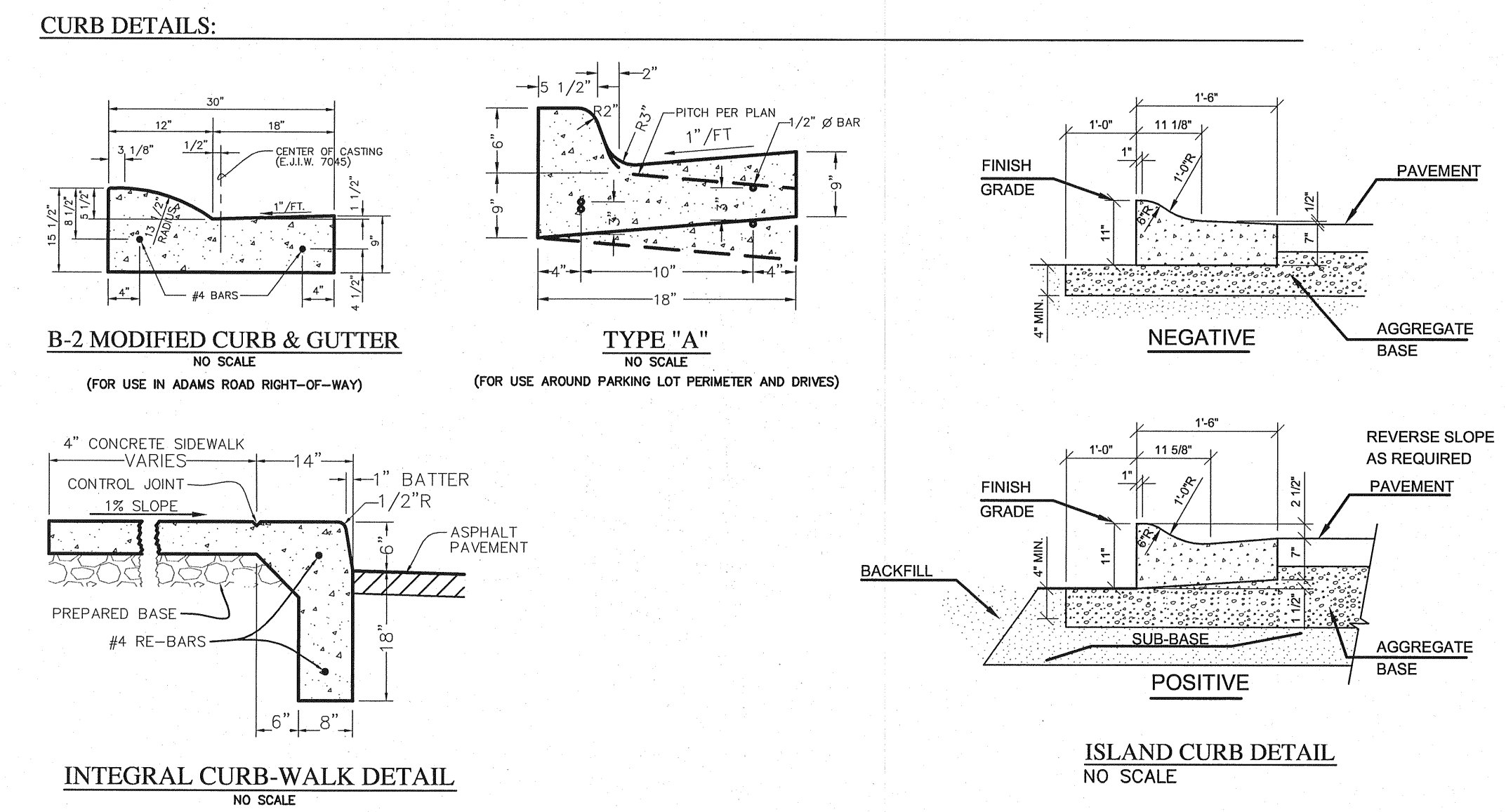
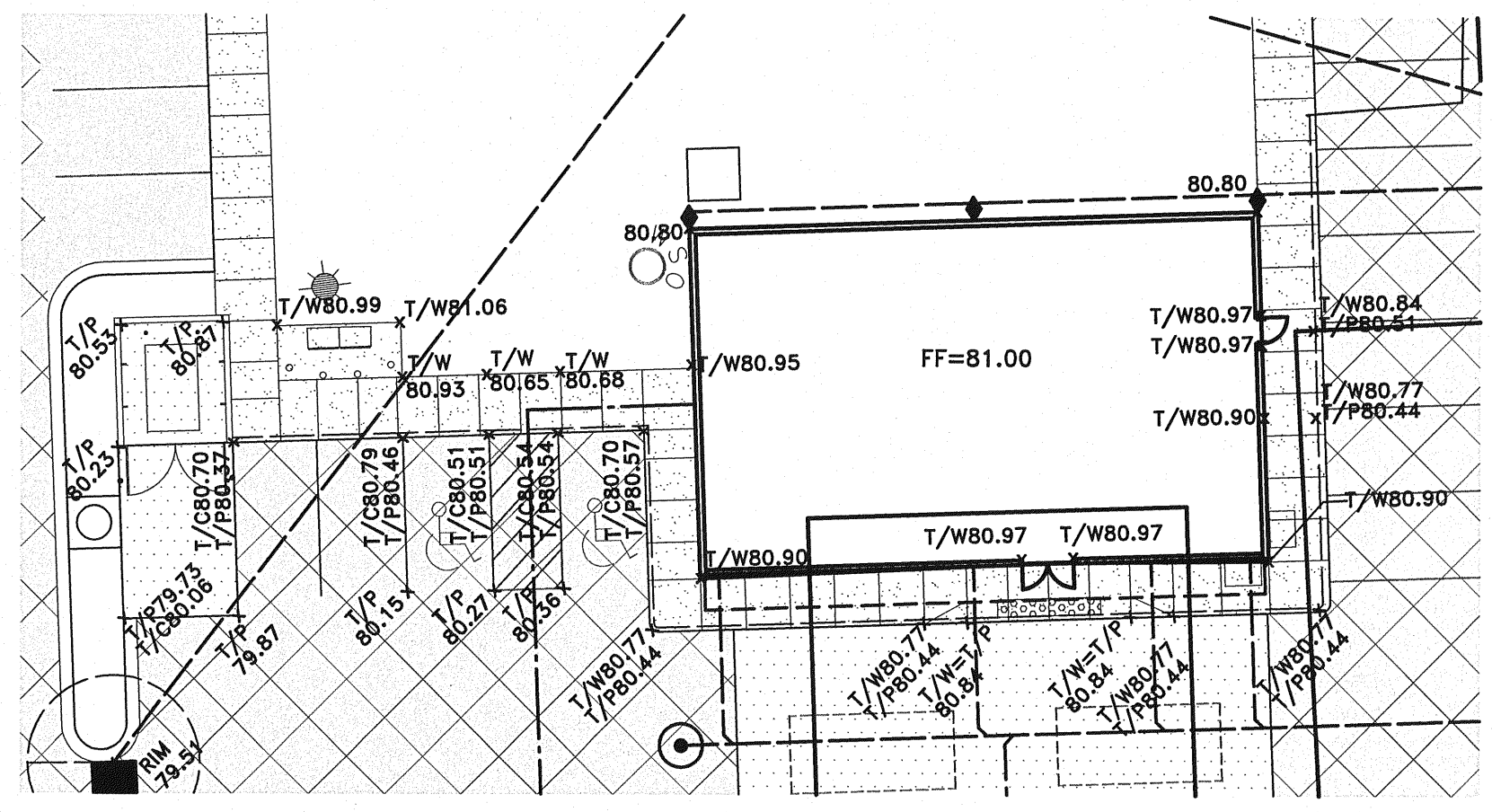

- PAVEMENT SPECIFICATIONS:**
- | | | | |
|--|--|--|--|
| | HEAVY DUTY ASPHALT: 2.0" M.D.O.T. 1100T, 20AA 2.5" M.D.O.T. 1100L, 20AA 10" 21AA AGGREGATE BASE (COMPACTED TO 95% MAX. UNIT DENSITY) BOND COAT SS-1H @ 0.1 GAL/SY | | CONCRETE TANK SLAB: 8" MDO P1 CONCRETE ON 4" 21AA AGGREGATE BASE (COMPACTED TO 95% MAX. UNIT DENSITY) |
| | CONCRETE DRIVEWAY: 8" REINFORCED MDO P1 CONCRETE ON 4" 21AA AGGREGATE BASE (COMPACTED TO 95% MAX. UNIT DENSITY) | | CONCRETE SIDEWALK: 4" UNIFORM CONCRETE ON 4" SAND BASE (COMPACTED TO 95% MAX. UNIT DENSITY) |
| | CONCRETE DUMPSTER PAD AND PUMP SLAB: 6" MDO P1 CONCRETE ON 4" 21AA AGGREGATE BASE (COMPACTED TO 95% MAX. UNIT DENSITY) | | ASPHALT PATHWAY: 2" M.D.O.T. 1100T 2" M.D.O.T. 1100L ON 4" 21AA AGGREGATE (COMPACTED TO 95% MAX. UNIT DENSITY) BOND COAT SS-1H @ 0.1 GAL/SY |

| REVISIONS | DATE | BY | REVISIONS | DATE | BY | REVISIONS | DATE | BY | REVISIONS | DATE | BY |
|-----------------|----------|-----|-----------|------|----|-----------|------|----|-----------|------|----|
| PER CITY REVIEW | 10/3/08 | SRB | | | | | | | | | |
| PER CITY REVIEW | 11/12/08 | SRB | | | | | | | | | |

ZEIMET WOZNAK ASSOCIATES
Civil Engineers & Land Surveyors
4024 GRAND RIVER AVE, SUITE 100
NOVI, MICHIGAN 48375
P: (248) 442-1101 F: (248) 442-1241 www.zeimetwoznak.com

MISS DIG SYSTEM, INC.
1-800-482-7171
THREE FULL WORKING DAYS BEFORE YOU DIG. CALL THE MISS DIG SYSTEM

PROJECT SPONSOR:
GRAND SAKWA PROPERTIES
28470 THIRTEEN MILE ROAD, SUITE 220
FARMINGTON HILLS, MI (248) 855-5500

ADAMS MARKETPLACE
GRADING PLAN (CONVENIENCE STORE)
MEIJER
ROCHESTER HILLS, MICHIGAN

NOT FOR CONSTRUCTION
CITY FILE 08-005

| | | | |
|-------------|--------|---------|---------------|
| DATE | 9/2/08 | SCALE | HOR: 1" = 50' |
| DESIGNED BY | SRB | JOB NO. | 97144 |
| DRAWN BY | DAB | SHEET | SP-2 |

H:\Projects\07144\dwg\MEIJER\07144_Meijer_Site_Plan.dwg, grading gas station, 11/12/2008 7:18:15 AM, SBlaszczak

© COPYRIGHT 2008

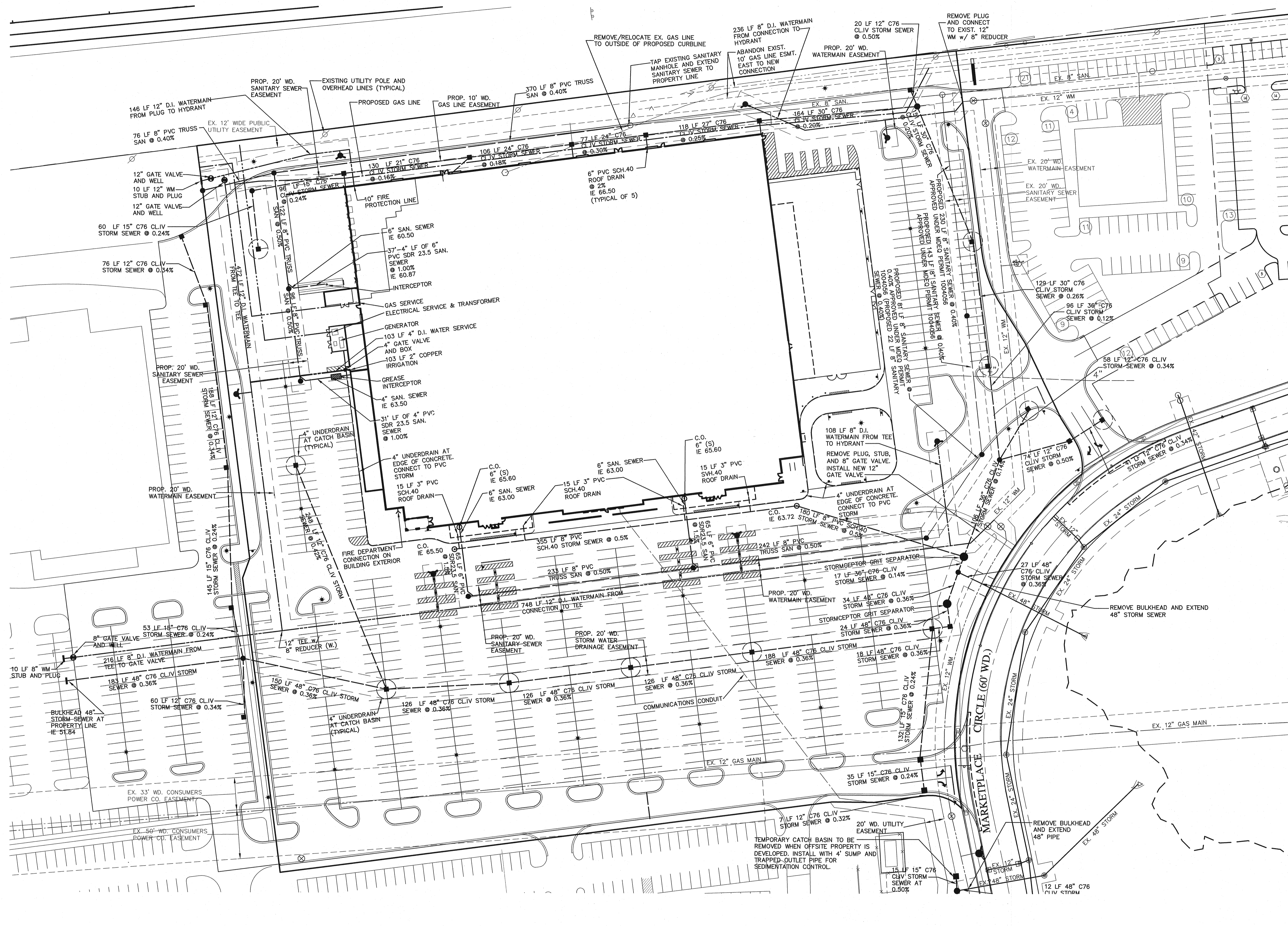

BENCH MARKS

- 1) BENCH MARK TIE W/ YELLOW FLAG WEST SIDE OF POWER POLE AT NORTHWEST CORNER OF WAL MART PARCEL. ELEV. 856.54
- 2) ARROW ON HYDRANT, WEST SIDE OF ADAMS RD. AT INTERSECTION OF INDUSTRIAL DRIVE. ELEV. 867.28
- 3) BENCH MARK TIE W/ YELLOW FLAG SOUTH SIDE OF POWER POLE AT NORTHEAST CORNER OF WAL MART PARCEL. ELEV. 842.28
- 4) BENCH MARK TIE W/ YELLOW FLAG EAST SIDE OF POWER POLE NORTH SIDE OF INDUSTRIAL DRIVE AT EAST END OF ROAD. ELEV. 874.96

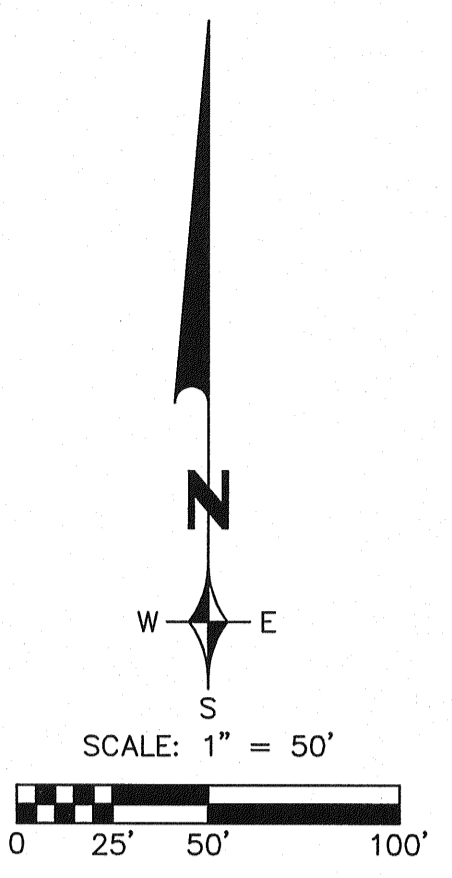

UTILITY LEGEND

- | EXISTING | PROPOSED |
|------------------|------------------|
| ○ MANHOLE | ● MANHOLE |
| □ CATCH BASIN | ■ CATCH BASIN |
| ⊕ CLEANOUT | ⊕ CLEANOUT |
| △ END SECTION | △ END SECTION |
| ⊙ ROOF DRAIN | ⊙ ROOF DRAIN |
| ⊗ GATE VALVE | ⊗ GATE VALVE |
| ⊕ HYDRANT | ⊕ HYDRANT |
| ⊕ WATER SHUT-OFF | ⊕ WATER SHUT-OFF |
| ⊕ UTILITY POLE | ⊕ UTILITY POLE |
| ⊕ GUY ANCHOR | ⊕ GUY ANCHOR |
| ⊕ LIGHT POLE | ⊕ LIGHT POLE |
| ⊕ SIGN | ⊕ SIGN |
| ⊕ TREE | ⊕ TREE REMOVAL |
| — TREE LINE | — SANITARY SEWER |
| — SANITARY SEWER | — STORM SEWER |
| — STORM SEWER | — WATER MAIN |
| — WATER MAIN | — GAS MAIN |
| — GAS MAIN | — ELECTRIC CABLE |
| — ELECTRIC CABLE | — DITCH |

SANITARY SEWER NOTES:

1. ALL CONSTRUCTION SHALL CONFORM TO THE CURRENT STANDARDS AND SPECIFICATIONS OF THE AGENCY HAVING JURISDICTION OVER THAT WORK.
2. ALL SANITARY SEWER BUILDING LEADS WILL BE SOLID WALL PVC SDR 23.5 PIPE.
3. SANITARY SEWER DROP CONNECTIONS MUST BE EXTERNAL TYPE.
4. THE MINIMUM SLOPE FOR 6" SANITARY BUILDING LEADS IS 1.00%.
5. ALL PROPOSED SEWERS SHALL HAVE CHEMICALLY WELDED JOINTS.
6. ALL PROPOSED SANITARY SEWER SHALL BE PVC TRUSS PIPE.

WATERMAIN NOTES:

1. ALL CONSTRUCTION SHALL CONFORM TO THE CURRENT STANDARDS AND SPECIFICATIONS OF THE AGENCY HAVING JURISDICTION OVER THAT WORK.
2. ALL HYDRANTS, INCLUDING NOZZLES AND PROJECTIONS SHALL BE 3" MINIMUM FROM EDGE OF SIDEWALK, OR 6" MINIMUM FROM BACK OF CURB.
3. THE WATERMAIN WILL HAVE A MINIMUM OF 6 FEET OF COVER.
4. THE CONTRACTOR SHALL DETERMINE DEGREE OF BEND FOR THE WATERMAIN FITTINGS. PIPE DEFLECTIONS SHALL NOT EXCEED 75% OF THE MANUFACTURER'S MAXIMUM ALLOWABLE DEFLECTION.
5. WATERMAIN SHALL BE CEMENT-LINED (DOUBLE THICKNESS), DUCTILE IRON PIPE, CLASS 54.
6. A VERTICAL SEPARATION OF 18 INCHES MUST BE MAINTAINED BETWEEN THE WATERMAIN AND SANITARY SEWERS, STORM SEWERS, OR OTHER PROPOSED UTILITIES.
7. ALL GATE VALVES SHALL BE RESILIENT WEDGE OR SEATED TYPE GATE VALVE (E.J.I.W. OR U.S. PIPE).
8. PER THE SOIL BORINGS, ALL WATERMAIN SHALL REQUIRE POLYWRAP.
9. RESTRAINED RODDED JOINTS SHALL BE USED AT ALL VERTICAL BENDS. THE NUMBER OF RESTRAINED RODDED JOINTS REQUIRED SHALL BE DETERMINED BY THE MANUFACTURER, SUBJECT TO APPROVAL BY THE CITY ENGINEER.
10. USE HYDRANT CONNECTION DETAIL 'A' (STANDARD DETAIL SHEET A)

STORM SEWER NOTES:

1. PROPOSED STRUCTURE COVERS/GRATES SHALL BE PROVIDED AS REQUIRED ON THE CITY OF ROCHESTER HILLS STANDARD DETAIL SHEETS.
2. EDGE DRAIN TO BE 20" IN EACH DIRECTION AT 90° ANGLES FROM INLET STRUCTURES LOCATED IN PAVED AREAS.
3. STRUCTURAL CALCULATIONS AND SHOP DRAWINGS, SIGNED AND SEALED BY A PROFESSIONAL ENGINEER (REGISTERED IN THE STATE OF MICHIGAN) SHALL BE SUBMITTED TO THE CITY FOR REVIEW PRIOR TO CONSTRUCTION OF ALL STORM SEWER STRUCTURES GREATER THAN 6 FEET IN DIAMETER.
4. PROPOSED ROOF DRAINS SHALL BE SCHEDULE 40 PVC PIPE WITH CHEMICALLY WELDED JOINTS.
5. PROPOSED STORM SEWER PIPE SHALL BE REINFORCED CONCRETE CLASS IV WITH RUBBER GASKETS AND CLASS B BEDDING.

GENERAL NOTES:

1. M.D.O.T. CLASS II BACKFILL TO BE COMPACTED IN 6" LAYERS TO 95% OF MAXIMUM UNIT WEIGHT, ABOVE REQUIRED UNDER OR WITHIN A 1 ON 1 SLOPE OF EXISTING OR PROPOSED PAVEMENT.
2. ALL CONTRACTORS SHALL NAME ZEIMET-WOZNAK & ASSOCIATES AS ADDITIONALLY INSURED ON ALL INSURANCE POLICIES.

NOTE:
 THE LOCATIONS OF EXISTING UNDERGROUND UTILITIES ARE SHOWN IN AN APPROXIMATE WAY ONLY AS DISCLOSED BY AVAILABLE UTILITY COMPANY RECORDS AND HAVE NOT BEEN INDEPENDENTLY VERIFIED BY THE COMPANY. NO GUARANTEE IS EITHER EXPRESSED OR IMPLIED AS TO THE COMPLETENESS OR ACCURACY THEREOF. THE CONTRACTOR SHALL DETERMINE THE EXACT LOCATION OF ALL EXISTING UTILITIES BEFORE COMMENCING WORK, AND AGREES TO BE FULLY RESPONSIBLE FOR ANY AND ALL DAMAGES WHICH MIGHT BE OCCASIONED BY THE CONTRACTOR'S FAILURE TO EXACTLY LOCATE AND PRESERVE ANY AND ALL UNDERGROUND UTILITIES. THE CONTRACTOR SHALL NOTIFY THE DESIGN ENGINEER IMMEDIATELY IF A CONFLICT IS APPARENT.

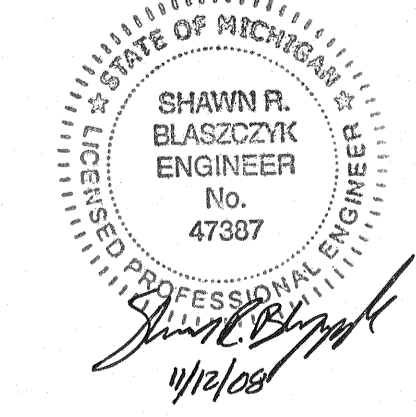

| REVISIONS | DATE | BY | REVISIONS | DATE | BY | REVISIONS | DATE | BY | REVISIONS | DATE | BY |
|-----------------|----------|-----|-----------|------|----|-----------|------|----|-----------|------|----|
| PER CITY REVIEW | 10/3/08 | SRB | | | | | | | | | |
| PER CITY REVIEW | 11/12/08 | SRB | | | | | | | | | |

ZEIMET WOZNAK & ASSOCIATES
 Civil Engineers & Land Surveyors
 4024 GRAND RIVER AVE, SUITE 100
 NOVI, MICHIGAN 48375
 P: (248) 442-1101 F: (248) 442-1241 www.zeimetwoznak.com

MISS DIG SYSTEM, INC.
 1-800-482-7171
 THREE FULL WORKING DAYS BEFORE YOU DIG, CALL THE MISS DIG SYSTEM

PROJECT SPONSOR:
 GRAND SAKWA PROPERTIES
 28470 THIRTEEN MILE ROAD, SUITE 220
 FARMINGTON HILLS, MI (248) 855-5500

ADAMS MARKETPLACE
UTILITY PLAN (STORE)
MEIJER
 ROCHESTER HILLS, MICHIGAN

NOT FOR CONSTRUCTION
CITY FILE 08-005

DATE: 9/2/08 SCALE: HOR: 1" = 50' VER: 1" = N/A
 DESIGNED BY: SRB JOB NO.: 97144
 DRAWN BY: DAB SHEET: SP-3