

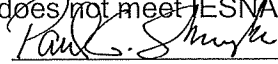

Exhibit A to Master Agreement

Purchase Agreement

This Purchase Agreement (this "Agreement") is dated as of February 8, 2019 between DTE Electric Company ("Company") and the City of Rochester Hills ("Customer").

This Agreement is a "Purchase Agreement" as referenced in the Master Agreement for Municipal Street Lighting dated October 3, 2014 (the "Master Agreement") between Company and Customer. All of the terms of the Master Agreement are incorporated herein by reference. In the event of an inconsistency between this Agreement and the Master Agreement, the terms of this Agreement shall control.

Customer requests the Company to furnish, install, operate and maintain street lighting equipment as set forth below:

1. DTE Work Order Number:	52084474 If this is a conversion or replacement, indicate the Work Order Number for current installed equipment: N/A	
2. Location where Equipment will be installed:	[Johnny Blacks and Emmons Ave. Parking Lots], as more fully described on the map attached hereto as <u>Attachment 1</u> .	
3. Total number of lights to be installed:	17	
4. Description of Equipment to be installed (the " <u>Equipment</u> "):	<p>Johnny Blacks: Install five (5) Special Order Material (SOM) twin luminaire posts on high-band foundations, with ten (10) SOM 71w LED Lithonia DSX Series area lights. Install three (3) SOM single luminaire posts on high-band foundations, with three (3) SOM 71w LED Lithonia DSX Series area lights (with houseside shields).</p> <p>Emmons Ave: Install four (4) SOM single luminaire posts on high-band foundations, with four (4) SOM 71w LED Lithonia DSX Series area lights. The two fixtures on the north side of parking to have houseside shields. One(1) Twin Assembly and One (1) Single Assembly included in pricing below. ALL MATERIAL IS SPECIAL ORDER WITH CUSTOM PAINT FINISH</p>	
5. Estimated Total Annual Lamp Charges	\$4,163.30	
6. Computation of Contribution in aid of Construction (" <u>CIAC Amount</u> ")	Total estimated construction cost, including labor, materials, and overhead:	\$53,210.36
	Credit for 3 years of lamp charges:	\$12,489.90
	CIAC Amount (cost minus revenue)	\$40,720.46
7. Payment of CIAC Amount:	Due promptly upon execution of this Agreement	
8. Term of Agreement	5 years. Upon expiration of the initial term, this Agreement shall continue on a month-to-month basis until terminated by mutual written consent of the parties or by either party with thirty (30) days prior written notice to the other party.	
9. Does the requested Customer lighting design meet IESNA recommended practices?	(Check One) <input type="checkbox"/> YES <input checked="" type="checkbox"/> NO If "No", Customer must sign below and acknowledge that the lighting design does not meet IESNA recommended practices  PAUL G SHUMETSKO 	
10. Customer Address for Notices:	City of Rochester Hills 1000 Rochester Hills Dr Rochester Hills, MI 48309	

11. Special Order Material Terms:

All or a portion of the Equipment consists of special order material: (check one) YES NO

If "Yes" is checked, Customer and Company agree to the following additional terms.

A. Customer acknowledges that all or a portion of the Equipment is special order materials ("SOM") and not Company's standard stock. Customer will purchase and stock replacement SOM and spare parts. When replacement equipment or spare parts are installed from Customer's inventory, the Company will credit Customer in the amount of the then current material cost of Company standard street lighting equipment.

B. Customer will maintain an initial inventory of at least 1 twin post and 1 single post and any other materials agreed to by Company and Customer, and will replenish the stock as the same are drawn from inventory. Costs of initial inventory are included in this Agreement. The Customer agrees to work with the Company to adjust inventory levels from time to time to correspond to actual replacement material needs. If Customer fails to maintain the required inventory, Company, after 30 days' notice to Customer, may (but is not required to) order replacement SOM and Customer will reimburse Company for such costs. Customer's acknowledges that failure to maintain required inventory could result in extended outages due to SOM lead times.

C. The inventory will be stored at Rochester Hills DPS: 511 E. Auburn Rd. Access to the Customers inventory site must be provided between the hours of 9:00 am to 4:00 pm, Monday through Friday with the exceptions of federal Holidays. Customer shall name an authorized representative to contact regarding inventory: levels, access, usage, transactions, and provide the following contact information to the Company:

Name: Bud Clark Title: Crew Leader
Phone Number: 248-841-2650 Email: clarkb@rochesterhills.org

The Customer will notify the Company of any changes in the Authorized Customer Representative. The Customer must comply with SOM manufacturer's recommended inventory storage guidelines and practices. Damaged SOM will not be installed by the Company.

D. In the event that SOM is damaged by a third party, the Company may (but is not required to) pursue a damage claim against such third party for collection of all labor and stock replacement value associated with the damage claim. Company will promptly notify Customer as to whether Company will pursue such claim.

E. In the event that SOM becomes obsolete or no longer manufactured, the Customer will be allowed to select new alternate SOM that is compatible with the Company's existing infrastructure.

F. Should the Customer experience excessive LED equipment failures, not supported by LED manufacturer warrantees, the Company will replace the LED equipment with other Company supported Solid State or High Intensity Discharge luminaires at the Company's discretion. The full cost to complete these replacements to standard street lighting equipment will be the responsibility of the Customer.

Company and Customer have executed this Purchase Agreement as of the date first written above.

Company:

DTE Electric Company

By: _____

Name: _____

Title: _____

Customer:

City of Rochester Hills

By: _____

Name: _____

Title: _____



Attachment 1 to Purchase Agreement

Map of Location

[To be attached]

Photometric Profile View 1

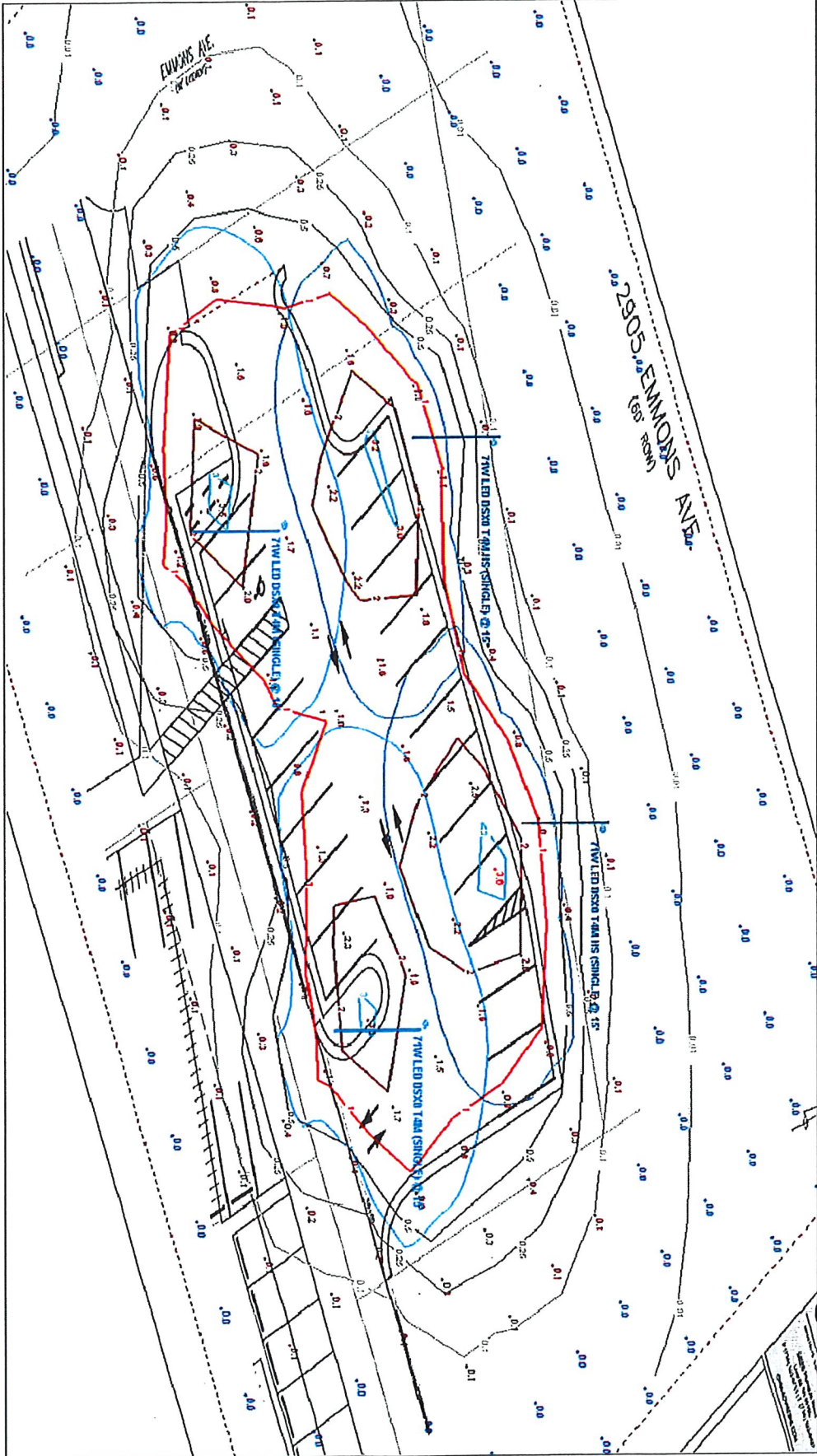

Designer
 M. Valascho
 Date
 1/14/2019
 Scale
 Not to Scale
 Drawing No.
 Summary

Emmons Parking Lot
 71W LED Lithonia DSX0 Series (15' MH)
 DTE Photometric Site Plan 1
 Community Lighting Group



DTE Energy

Photometric Profile View 1

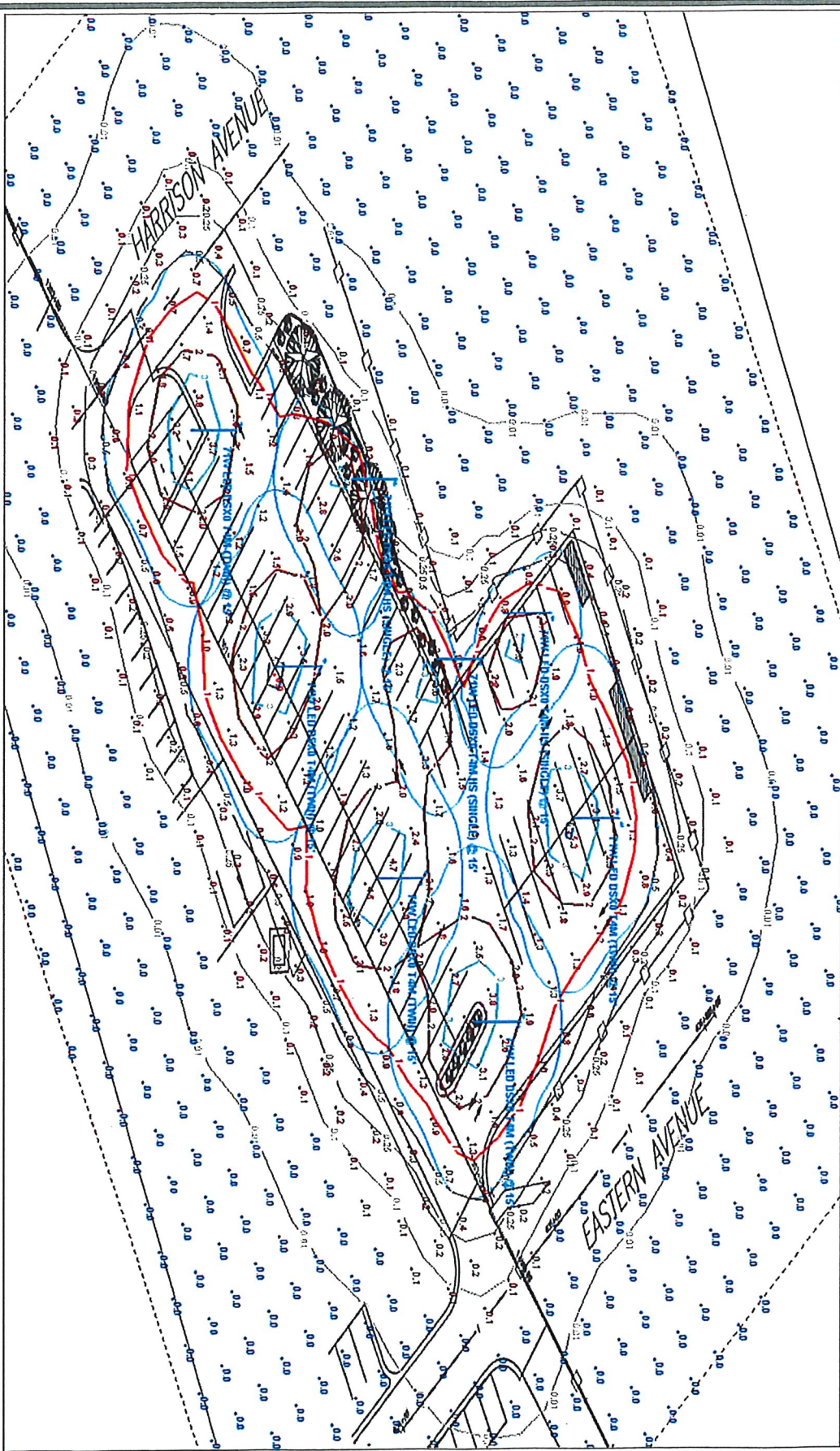

Summary
Drawing No.
Not to Scale
Scale
12/06/2018
Date
M. Valascho
Designer

Johnny Black's Parking Lot - Revision 2
71W LED Lithonia DSX0 Series (15' MH)
DTE Photometric Site Plan 2
Community Lighting Group



DTE Energy®