

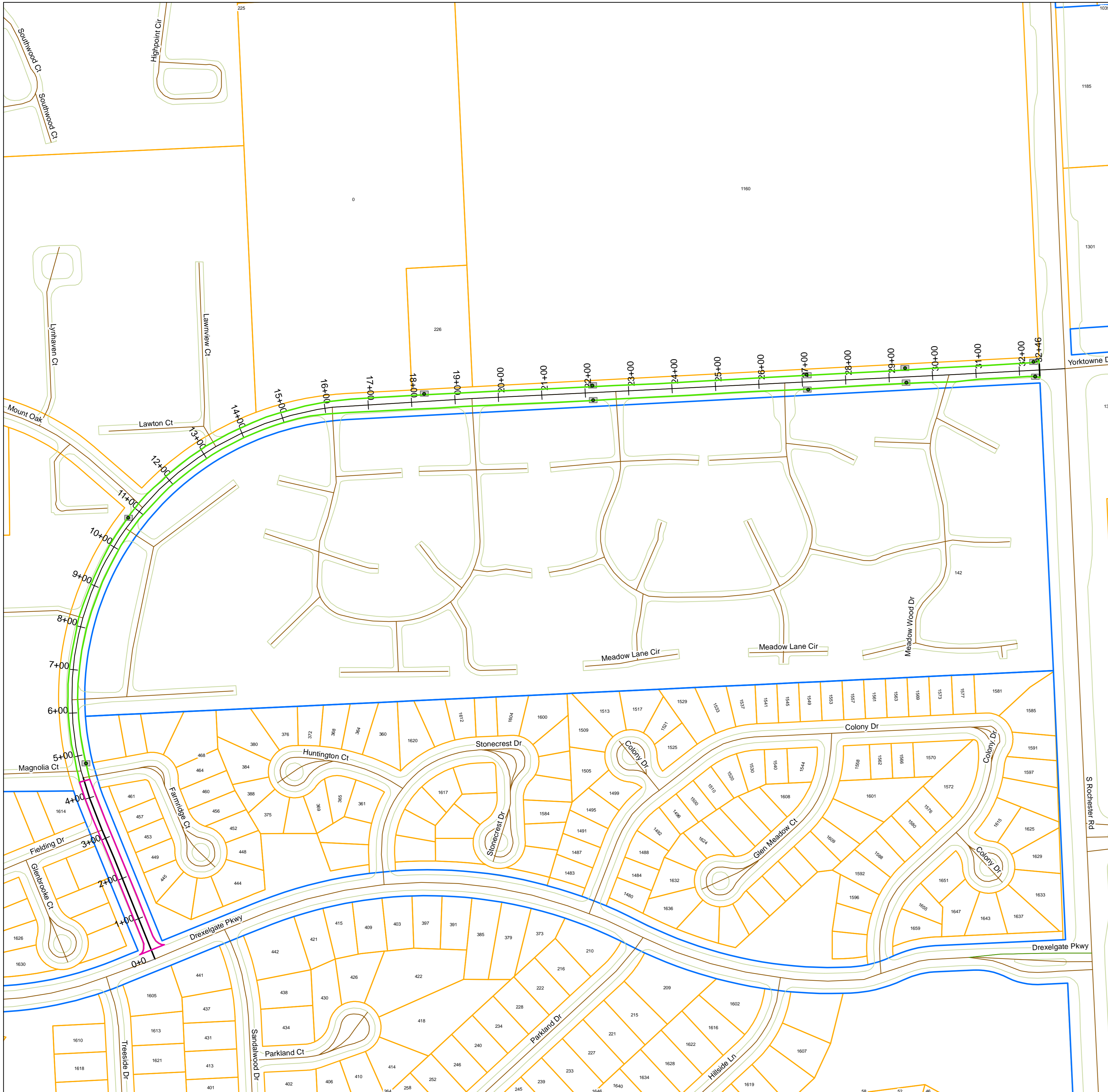



2008 Asphalt Rehabilitation Program

Meadowfield Drive

City File #E08-002



-  Property Lines
-  All concrete to be removed and replaced in this area
-  All asphalt to be removed and replaced in this area
-  Silt cover over curb drain structures

Meadowfield Drive
 Concrete:
 Area = 11,060 S.F.
 Length = 400 L.F.
 Asphalt:
 Area = 78,632 S.F.
 Length = 2,905 L.F.

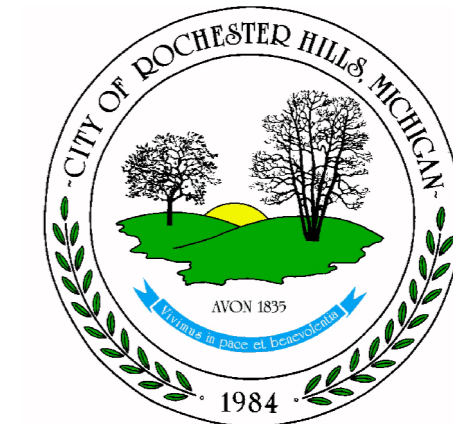

City of
ROCHESTER HILLS