

**LEGEND**

	854.6	EXIST. CONTOUR
	x 854.6	EXIST. SPOT ELEVATION
	---	EXIST. STORM SEWER
	o	EXIST. MANHOLE
	o	EXIST. CATCH BASIN/INLET
	---	EXIST. SANITARY SEWER
	+	EXIST. CLEANOUT
	---	EXIST. WATER MAIN
	h	EXIST. HYDRANT
	+	EXIST. SHUTOFF OR CURB BOX
	+	EXIST. GATE VALVE IN BOX
	+	EXIST. GATE VALVE IN MANHOLE
	---	EXIST. OVERHEAD ELECTRIC
	---	EXIST. UNDERGROUND ELECTRIC
	o	EXIST. LIGHT POLE
	o	EXIST. UTILITY POLE
	---	GUY WIRE
	+	EXIST. ELECTRIC TRANSFORMER
	---	EXIST. OVERHEAD TELEPHONE
	---	EXIST. UNDERGROUND TELEPHONE
	---	EXIST. GAS
	+	EXIST. GAS RISER
	+	EXIST. TELEPHONE RISER
	---	EXIST. CURB AND GUTTER
	---	CENTERLINE OF DITCH OR EDGE OF WATER
	---	EDGE OF WETLAND
	---	EXISTING FENCE
	---	EXIST. UTILITY UNSPECIFIED
	+	EXIST. SIGN
	---	EXIST. TREE OR BRUSH LIMIT
	o	CONTROL POINT
	o	FOUND IRON PIPE
	o	SET IRON PIPE
	o	FOUND CONCRETE MONUMENT
	o	SET CONCRETE MONUMENT
	o	FOUND PK NAIL
	o	SET PK NAIL
	o	FOUND LEADED CHISEL HOLE
	o	SET LEADED CHISEL HOLE
	o	FOUND REBAR
	+	APPROX. LOCATION OF SOIL BORING
	+	APPROX. LOCATION OF MONITORING WELL
	+	APPROX. LOCATION OF PENETRATION TEST
	o	EXIST. DECIDUOUS TREE
	o	EXIST. CONIFEROUS TREE
	+	SECTION CORNER
	---	PROP. RIDGELINE

**SITE GRADING NOTES**

- CONTRACTOR SHALL ADJUST AND/OR CUT EXISTING PAVEMENT AS NECESSARY TO ASSURE A SMOOTH FIT AND CONTINUOUS GRADE.
- CONTRACTOR SHALL ASSURE POSITIVE DRAINAGE AWAY FROM BUILDINGS FOR ALL NATURAL AND PAVED AREAS.
- ALL UNSURFACED AREAS DISTURBED BY GRADING OPERATION SHALL RECEIVE 4 INCHES OF TOPSOIL. CONTRACTOR SHALL APPLY STABILIZATION FABRIC TO ALL SLOPES 3H:1V OR STEEPER. CONTRACTOR SHALL SOD DISTURBED AREAS AS NEEDED IN ACCORDANCE WITH CITY SPECIFICATIONS. CONTRACTOR SHALL ESTABLISH PERMANENT ON-SITE BENCH MARK PRIOR TO CLEARING/DEMOLITION.
- ALL RECONSTRUCTED PEDESTRIAN WALKWAYS AND RAMPS SHALL BE DESIGNED PER ADA STANDARDS.
- ALL PROPOSED GRADES SHOWN ARE TOP OF PAVEMENT UNLESS SPECIFIED OTHERWISE. FOR TOP OF CURB GRADES ADD 0.5' TO TOP OF PAVEMENT GRADES.
- EXISTING INTEGRAL CURB AND SIDEWALK IS TO REMAIN EXCEPT AS SPECIFIED ON THE APPROVED CONSTRUCTION PLANS.
- ASPHALT PARKING LOT TO BE PULVERIZED, CRUSHED AND RESHAPED AS BASE MATERIAL. NEW ASPHALT BASE AND WEARING COURSE TO BE INSTALLED. WORK SHALL BE PERFORMED IN ACCORDANCE WITH THE 2003 MDT STANDARD SPECIFICATIONS FOR CONSTRUCTION.
- PLACE NEW ASPHALT PAVEMENT TO PROVIDE A 6" DROP FROM TOP OF EXISTING SIDEWALK.
- EXCESS RECYCLED ASPHALT PAVEMENT MATERIAL SHALL BE THE CONTRACTORS RESPONSIBILITY TO PROPERLY DISPOSE OF OFF-SITE. CONSTRUCTION OF THE NORTHERN PARKING LOT WITHIN THE FLOODPLAIN LIMITS SHALL STRICTLY ADHERE TO THE DESIGN OF THE APPROVED CONSTRUCTION PLANS. ANY DEVIATION FROM THE PROPOSED ELEVATIONS SHALL BE REVIEWED BY THE DESIGN ENGINEER TO ASSURE CONFORMANCE WITH THE MDEQ PERMIT.

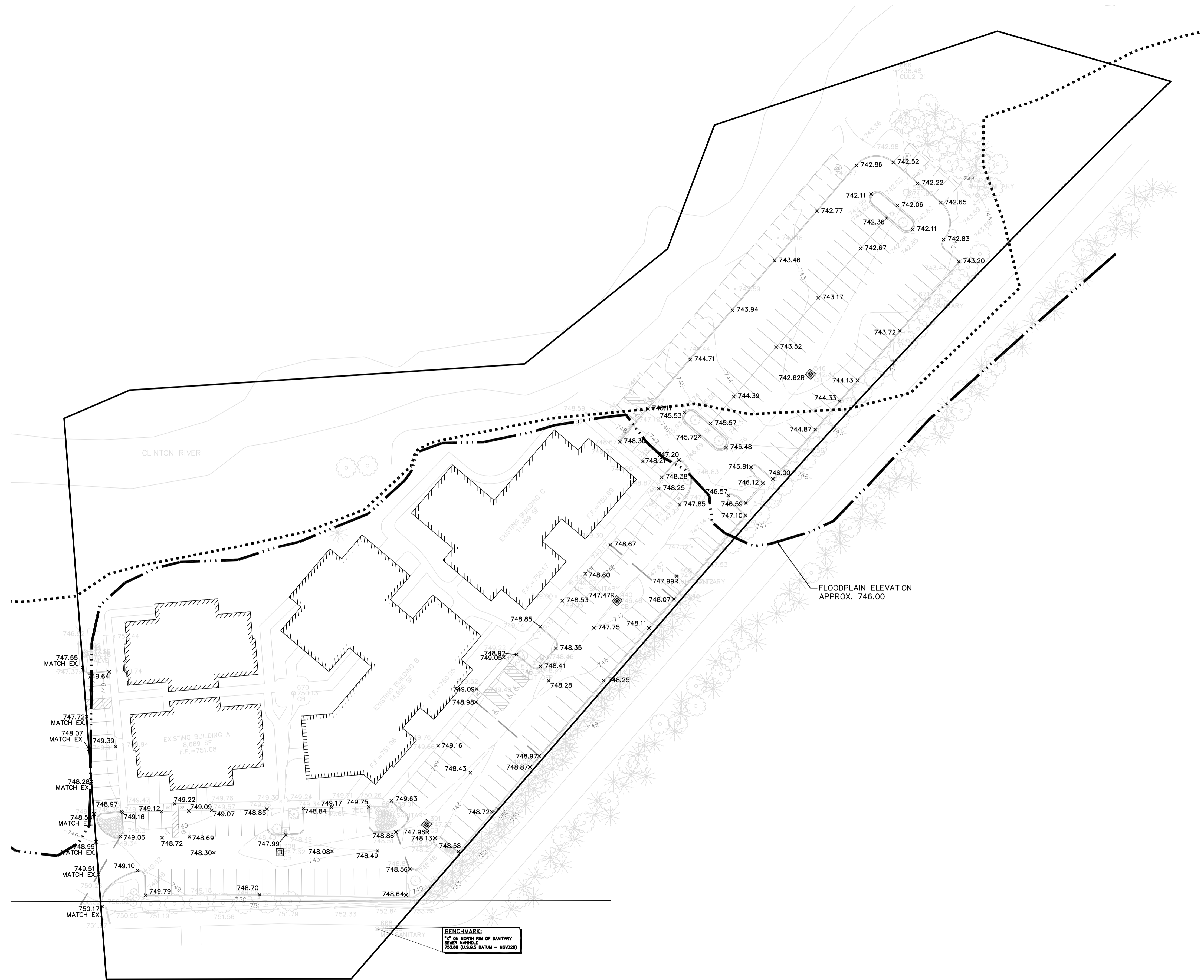

**BENCHMARK:**  
 "C" ON NORTH RM OF SANITARY  
 SEWER MANHOLE  
 753.86 (GLASS DATUM - NGVD29)



THE LOCATIONS OF EXISTING UNDERGROUND UTILITIES ARE SHOWN IN AN APPROXIMATE WAY ONLY AND HAVE NOT BEEN INDEPENDENTLY VERIFIED BY THE OWNER OR ITS REPRESENTATIVE. THE CONTRACTOR SHALL DETERMINE THE EXACT LOCATION OF ALL EXISTING UTILITIES BEFORE COMMENCING WORK, AND AGREES TO BE FULLY RESPONSIBLE FOR ANY AND ALL DAMAGES WHICH MIGHT BE OCCASIONED BY THE CONTRACTOR'S FAILURE TO EXACTLY LOCATE AND PRESERVE ANY AND ALL UNDERGROUND UTILITIES.

**NOTICE:**  
 CONSTRUCTION SITE SAFETY IS THE SOLE RESPONSIBILITY OF THE CONTRACTOR. NEITHER THE OWNER NOR THE ENGINEER SHALL BE EXPECTED TO ASSUME ANY RESPONSIBILITY FOR SAFETY OF THE WORK, OF PERSONS ENGAGED IN THE WORK, OF ANY NEARBY STRUCTURES, OR OF ANY OTHER PERSONS.

COPYRIGHT © 2008 ATWELL-HICKS  
 NO REPRODUCTION SHALL BE MADE WITHOUT THE PRIOR WRITTEN CONSENT OF ATWELL-HICKS

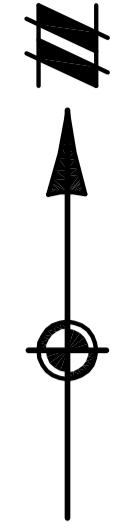

**ATWELL-HICKS**  
 www.atwell-hicks.com  
 ARIZONA FLORIDA ILLINOIS MICHIGAN  
 OHIO PENNSYLVANIA TENNESSEE  
 8 6 6 8 5 0 4 2 0 0  
 Engineering  
 Surveying  
 Planning  
 Environmental  
 Ecological  
 Water Resources

SECTION 15
TOWN 3 NORTH, RANGE 11 EAST
CITY OF ROCHESTER HILLS
OAKLAND COUNTY, MICHIGAN

CLIENT  
**IN RHODES MANAGEMENT, INC.**  
 RIVERCREST PROFESSIONAL  
 CENTER PARKING LOT  
 CONSTRUCTION PLANS  
 GRADING PLAN

DATE	05-05-2008
REVISIONS	9-18-08: REVISED PER CITY

**AI**  
 SCALE 0 20 40  
 1" = 40 FEET  
 DR. JEK | CH. WJH  
 P.M. D. PIONK  
 BOOK ---  
 CAD FILE: 08000352-06-G  
 JOB 08000352  
 FILE CODE: CP-0-1  
 SHEET NO. CP-06

CITY FILE #84-435.2

K:\08000352\08000352.dwg (P) Site Construction\08000352.dwg, 07/18/2008 11:23:49 AM, j\_kluc