



City of ROCHESTER HILLS

1000 Rochester Hills Drive, Rochester Hills, Michigan 48309-3033

NOTICE OF PUBLIC HEARING ROCHESTER HILLS CITY COUNCIL

REQUEST: A Wetland Use Permit for approximately .25 acre of permanent wetland impacts which will result from grading activities and the construction of a paved loading area. The area is zoned B-3, Shopping Center Business and affects Parcel Nos. 15-35-100-035 and -042 (City File No. 05-037)

LOCATION: East side of Rochester Road, North of M-59

APPLICANT: Lowe's Home Centers, Inc.
Hwy. 268 East
North Wilkesboro, NC 28659

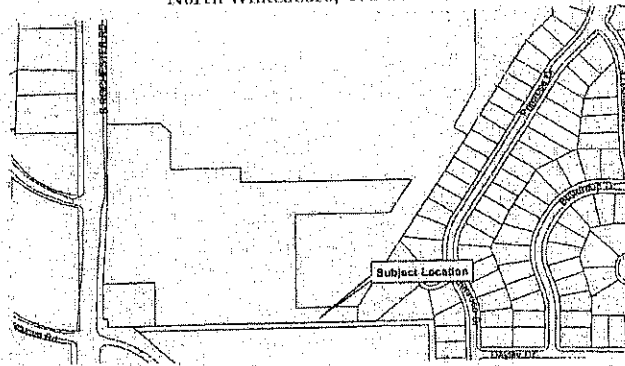

DATE OF PUBLIC HEARING: Wednesday, October 4, 2006
at 7:30 p.m.

LOCATION OF HEARING: City of Rochester Hills
Municipal Offices
1000 Rochester Hills Drive
Rochester Hills, MI 48309

Information concerning this request may be obtained from the Planning Department, during regular business hours from 8:00 a.m. to 5:00 p.m., Monday through Friday, or by calling (248) 656-4660. Written comments concerning this request will be received by the City of Rochester Hills Planning Department, 1000 Rochester Hills Drive, Rochester Hills, Michigan 48309, prior to the public hearing or by the City Council at the Public Hearing.

Note: Anyone planning to attend the meeting who has need of special assistance under the Americans Disabilities Act (ADA) is asked to contact the Facilities Division (248) 656-4658 forty-eight (48) hours prior to the meeting. Staff will be pleased to make the necessary arrangements.

Publish: August 24, 2006

OE00470216