

Location Map

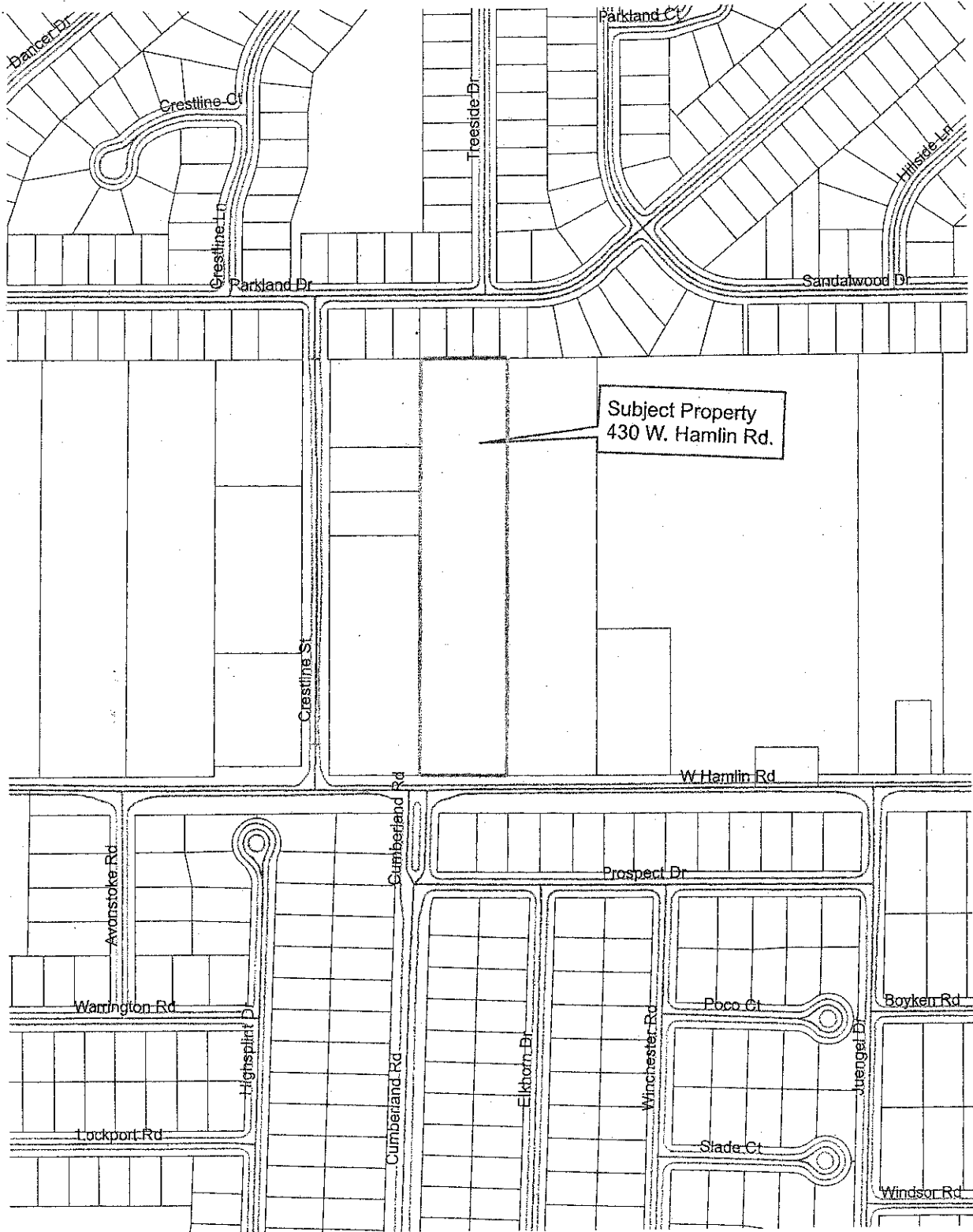

Subject Property
430 W. Hamlin Rd.



Legend
 [Symbol] Tax Parcel Boundary
 [Symbol] Street
 [Symbol] Right-of-Way

Aerial photographs as of April 2010
 Tax Parcel lines were obtained on 1/2/12 from Oakland County.
 Although the information provided by this map is believed to be reliable, its accuracy is not warranted in any way. The City of Rochester Hills assumes no liability for any claims arising from the use of this map.

7-5-11

1 inch = 349 feet