

# Rezoning Request Portion of 15-22-451-033

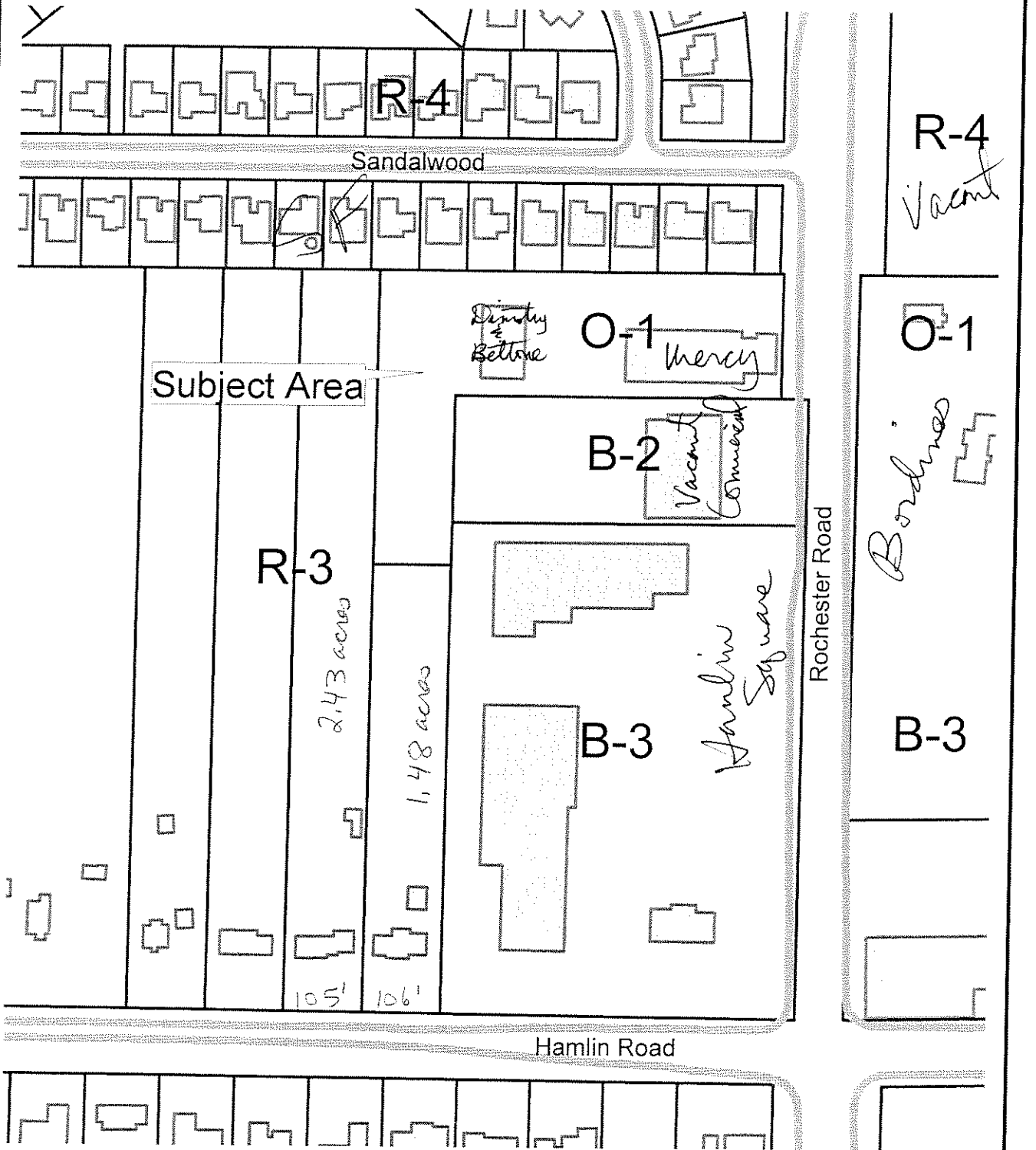

Aerial photographs as of April 2002.  
Parcel lines were obtained on 03-01-03 from Oakland County.  
Although the information provided by this map is believed to  
be reliable, its accuracy is not warranted in any way. The City  
of Rochester Hills assumes no liability for any claims arising  
from the use of this map.

1"=200'  
10/15/03