

OWNER: Attar Leasing, LLC  
42266 Ryan Road  
Sterling Heights, MI 48314-2804

**PERMIT TO GRADE**  
City of Rochester Hills

The undersigned grants to the City of Rochester Hills, its Agents and Representatives permission to enter upon Attar Leasing property at 1603 E. Auburn Road, City of Rochester Hills, Michigan 48307 for the purposes of constructing sidewalk along the frontage of the property and transitioning the alley pavement in the rear of the property, as per plan.

The activities will be conducted so as to minimize inconvenience with the owners and occupants of the property and upon completion of the reconstruction, the property will be restored.

This Permit expires July 31, 2020

Grading Permit Description: See Attachment "A"

Signed this 15<sup>th</sup> day of October, 2018

*Attar Leasing, L.L.C., a Michigan  
limited liability company*

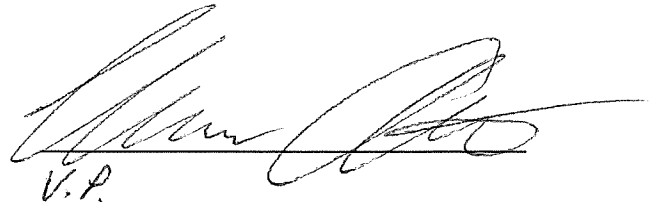

V.P.

---

Paul Davis, PE, City Engineer,  
City of Rochester Hills



**QUANTITIES THIS SHEET (SITE 3)**

TOTAL	UNIT	DESCRIPTION
7	EA	Tree Retention Tree 7" dia
7	EA	Tree Retention Tree 8" dia
2K	QTY	Embankment 2'P
247	QTY	Excavation 4' dia
121	EA	Asphalt 18"
121	EA	Asphalt 12"
42	EA	Asphalt 6"
14	EA	Grass 18" x 18" 1/4"
14	EA	Grass 12" x 12" 1/4"
14	EA	Grass 6" x 6" 1/4"
7	EA	Grass 18" x 18" 1/4"
1	EA	Grass 12" x 12" 1/4"
1	EA	Grass 6" x 6" 1/4"
202	EA	Grass 18" x 18" 1/4"
74	EA	Grass 12" x 12" 1/4"
1	EA	Grass 6" x 6" 1/4"
1	EA	Grass 18" x 18" 1/4"

**QUANTITIES THIS SHEET (SITE 4)**

TOTAL	UNIT	DESCRIPTION
46	EA	Timber Mill Run
15	EA	Landscaping Run
20	EA	Grass 18" x 18" 1/4"
226	EA	Grass 12" x 12" 1/4"
276	EA	Grass 6" x 6" 1/4"
20	EA	Grass 18" x 18" 1/4"

**QUANTITIES THIS SHEET (SITE 5)**

TOTAL	UNIT	DESCRIPTION
22	EA	Timber Mill Run
4	EA	Landscaping Run
1	EA	Grass 18" x 18" 1/4"
22	EA	Grass 12" x 12" 1/4"
22	EA	Grass 6" x 6" 1/4"
220	EA	Grass 18" x 18" 1/4"
14	EA	Grass 12" x 12" 1/4"
2	EA	Grass 6" x 6" 1/4"
1	EA	Grass 18" x 18" 1/4"
22	EA	Grass 12" x 12" 1/4"
22	EA	Grass 6" x 6" 1/4"
14	EA	Grass 18" x 18" 1/4"
2	EA	Grass 12" x 12" 1/4"
1	EA	Grass 6" x 6" 1/4"
14	EA	Grass 18" x 18" 1/4"

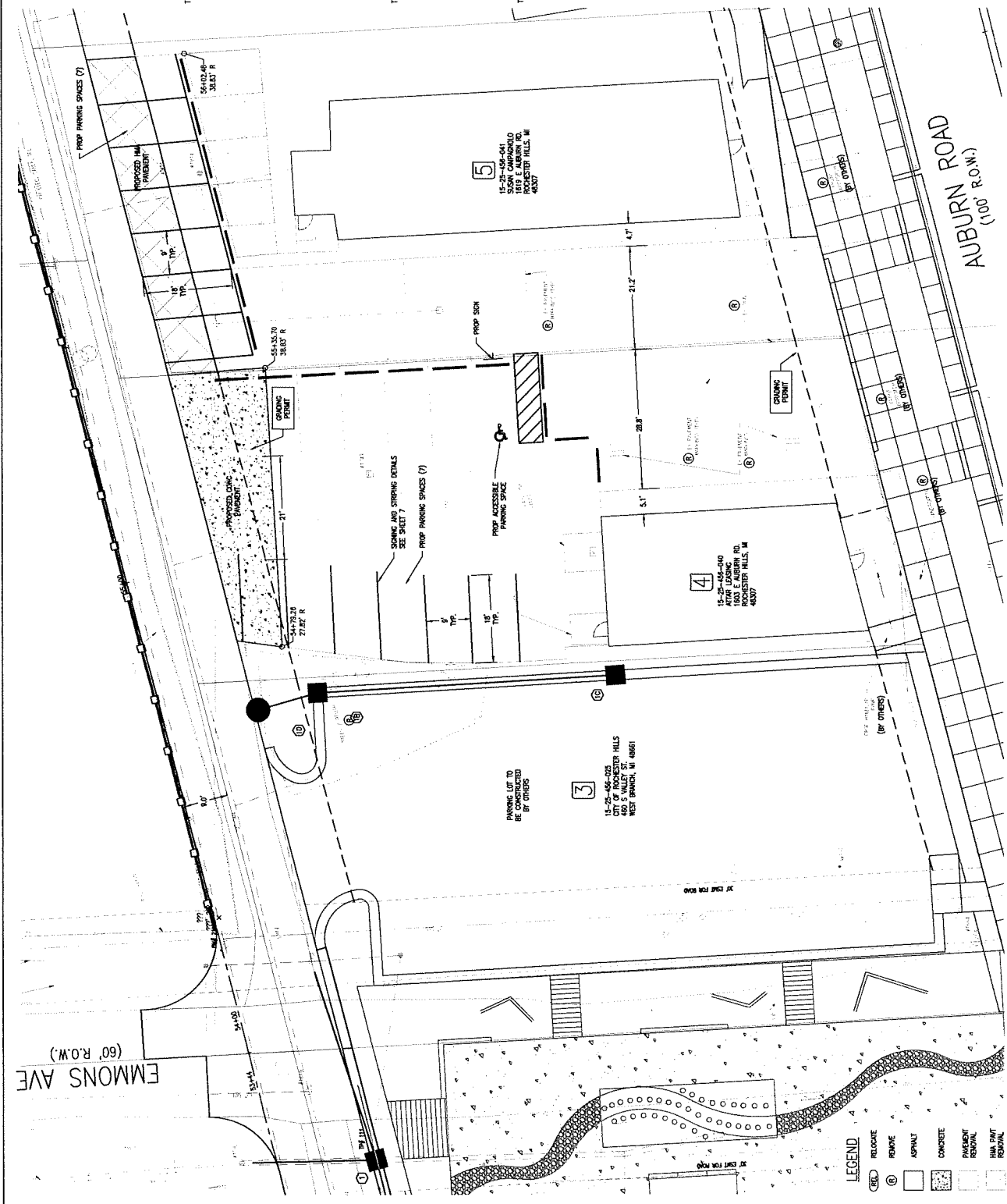

Know what's below.  
Call before you dig.