

# Auburn / Livernois

Mixed Use P.U.D. Request  
 Rochester Hills, MI 48307  
 Parcel I.D. # 15-27-351-007

## 120 Unit Multi-Family Development

Maximum Lot Coverage: n/a

Setbacks:  
 Required / Proposed  
 Front-  
 15' Min  
 25' Max  
 Up to 70' w/ 70' Proposed

Sides - 0  
 Rear - 0

Maximum Building Height:  
 3 Stories / 36'

Minimum Lot Size:  
 n/a  
 Minimum Width:  
 n/a

Parking:  
 120 Residential Units (1 & 2 Bedroom)  
 1.5 Spaces / Unit + 24 Visitor =  
 204 Spaces Required

20,500 Sq. Ft. Retail =  
 60 Spaces Provided

259 Spaces Required Per Code

41 Garage Spaces  
 205 Parking Spaces  
 246 Total Spaces Provided w/ Shared Parking

April 11, 2018

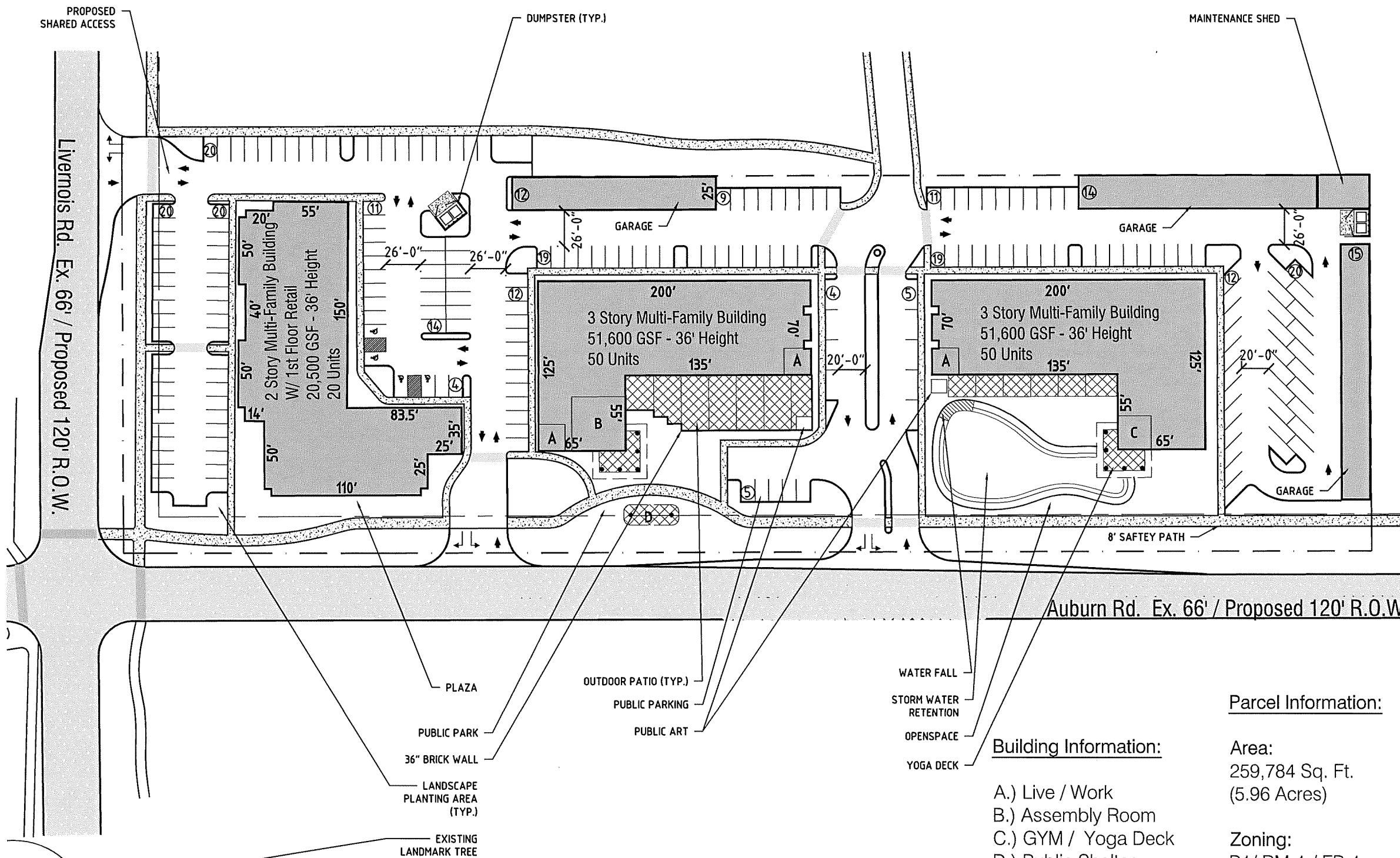

### Building Information:

- A.) Live / Work
- B.) Assembly Room
- C.) GYM / Yoga Deck
- D.) Public Shelter

### Parcel Information:

Area:  
 259,784 Sq. Ft.  
 (5.96 Acres)

Zoning:  
 B1/ RM-1 / FB-1

## Site Plan

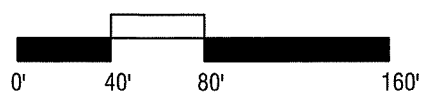

301 Walnut Blvd. Rochester, MI 48307  
 p 248.601.4422 www.designhaus.com