

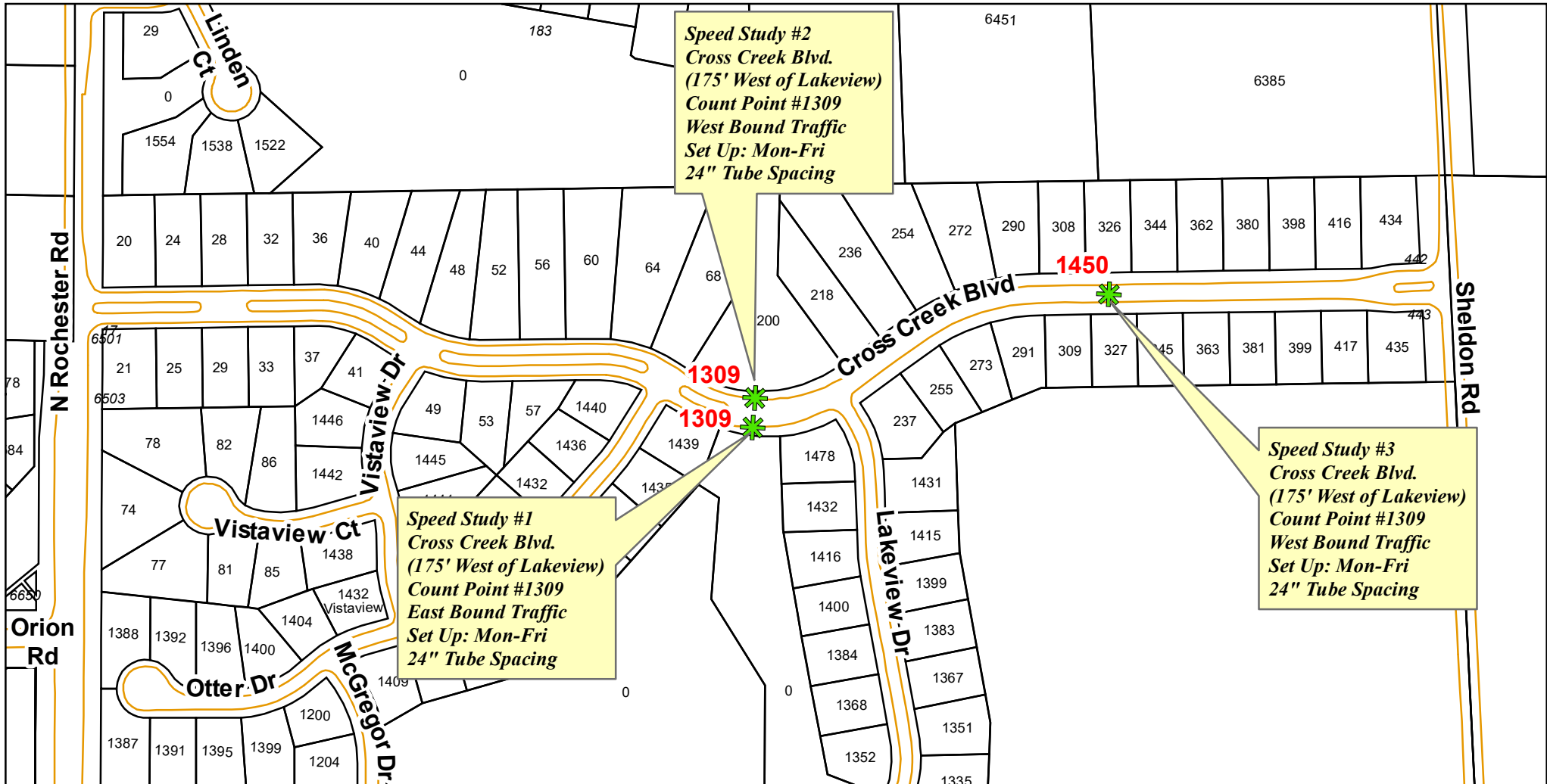

# Cross Creek Subdivision 2021 Speed Study Section # 02



## Legend



Count Points



Road Edge



Parcels

1 inch = 300 feet

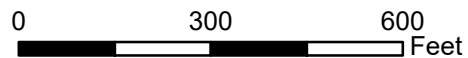

Although the information provided by this map is believed to be reliable its accuracy is not warranted in any way. The City of Rochester Hills assumes no liability for any claims arising from the use of this map.

## Map Description:

2021 speed study performed for the Cross Creek Homeowner's Association. Three locations were determined for counters. Speed study 1 & 2, respectively, recorded west, and east bound traffic conditions. Location 3 recorded both east and west bound traffic.

## Study Location Map

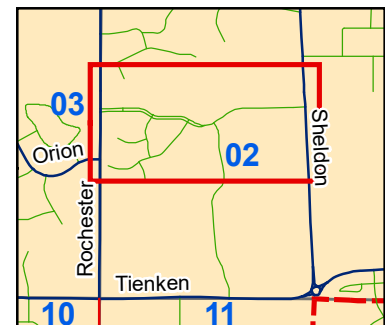

Drawn By: Seth Bucholz  
Date: 9/13/2021