

TEMPORARY EASEMENT

KNOW ALL PERSONS that **Shadow Woods Subdivision Association**, Grantors, whose address is 3128 Walton Blvd., Suite 102, Rochester Hills, MI 48309 party of the first part, hereby grant(s) to the City of Rochester Hills, a Michigan municipal corporation, party of the second part, whose address is 1000 Rochester Hills Drive, Rochester Hills 48309-3033 , an easement for a Temporary period of time ("Temporary Easement") in the construction of **Tienken Road** ("Project"), at the following described premises ("Property") situated in the City of Rochester Hills, County of Oakland, State of Michigan. To wit:

Exhibits A & B attached

Commonly known as: Timberline Park
(Part of) Tax Parcel No.: 15-08-128-033

This Temporary Easement is conveyed for the sum of **\$250.00** (two hundred fifty and 00/100 dollars) and shall expire at the completion of the Project. The purpose of this Temporary Easement is to grant to the Party of the second part the right to move workers, equipment, and materials on, over, and through the Property and to store equipment, material, and excavated matter on the Property. This Temporary Easement includes, but is not limited to, the consent of the Grantor(s) to the removal of any trees, shrubs, and/or vegetation, to grading, to the temporary occupancy of the Property by public utilities, and to other matters which, in the sole discretion of the Party of the second part, may be necessary in connection with the Project. Grantor(s) waive(s) further notice of such actions.

The permission stated in this Temporary Easement shall begin on the date the Project begins and shall end on the date the Project is completed. The work described above shall be constructed and/or restored, as may be applicable in the sole discretion of the Party of the second part, in a workmanlike manner and in accordance with applicable state and county standards. Upon completion of the work described above, the Party of the second part and its agents shall have no further or ongoing responsibilities in relation to the work described.

This Temporary Easement runs with the land and shall bind the Grantor(s) and the Grantor(s)'s heir, representatives, successors, and assigns. This Temporary Easement contains the entire understanding of the Grantor(s) and the Party of the second part, and there are no other verbal promises between the Grantor(s) and the Party of the second part except as shown herein.

WHEREFORE, upon approval by the Party of the second part, the undersigned Grantor(s) hereby create(s), confirm(s), and convey(s) the Temporary Easement described herein.

TIME -01-DEC-2014 08:12

PEN TBL -\msv8\working\block.dwg

D:\EVE -\m\p\l\Survey -\Legal-CADD\ TBL -\msv8\data\nccolor2.tbl

DESIGN FILE -\v\201401\20140197\FV140197.as80.dgn

USER NAME - dhubert

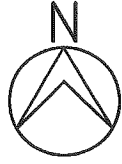

SCALE: 1" = 40'

EXHIBIT "A"
15-08-128-033
TIMBERLINE
PARK

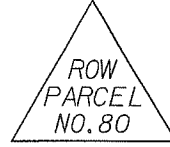

TEMPORARY
CONSTRUCTION
EASEMENT

TEMPORARY CONSTRUCTION EASEMENT = 3229 S.F.

TIENKEN ROAD
276.11'

168.00'

TEMPORARY CONSTRUCTION EASEMENT

50.00'

BREWSTER ROAD

699.19'

400.00'

15-08-128-033
TIMBERLINE PARK
NO ADDRESS AVAILABLE

"SHADOW WOODS SUB. NO. 2"
L. 165, P. 13-16, O.C.R.

TEMPORARY CONSTRUCTION EASEMENT = 

NOTE: ONLY PORTION OF PROPERTY SHOWN.

BEARINGS BASED ON - "SHADOW WOODS SUB. NO. 2", L. 165, P. 13-16, O.C.R.

TIENKEN ROAD
PROJECT NO. 52461
PARCEL 80

JOB NO. 20140197	HUBBELL, ROTH & CLARK, INC.	SHEET NO.
DATE 11-26-14	CONSULTING ENGINEERS 555 HULET DRIVE BLOOMFIELD HILLS, MICH.	1
	P.O. BOX 824 48303-0824	OF 2

EXHIBIT “B”

TIENKEN ROAD
Project No. 52461
Parcel 80

Temporary Construction Easement Description

The East 20.00 feet of the North 50.00 feet and the North 15.00 of the East 168.00 feet of Timberline Park (Private Park) of “Shadow Woods Sub. No. 2” part of the Northwest ¼ of Section 8, T.3N., R.11E, Avon Township (now City of Rochester Hills), Oakland County, Michigan, as recorded in Liber 168 of plats, Pages 13 -16, Oakland County Records.

Part of Tax Parcel No. 15-08-128-033
Commonly known as Timberline Park – No address Available