



LSA, Inc.

4743 PARKSIDE CT.
ANN ARBOR, MI 48105

734.417.0260 (PHONE)
734.212.2130 (FAX)

27.LU@LSA-MI.COM

OCEANIA INN

(FORMERLY:
PANERA BREAD)
37 S LIVERNOIS ROAD
ROCHESTER HILLS, MI 48307

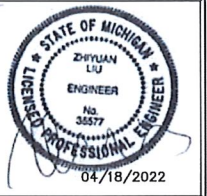

SHEET TITLE
FLOOR
PLAN
SCHEDULES
& NOTES

PROJECT NO: 2202016

DRAWN _____
CHECKED Z.L.
APPROVED _____

ISSUED FOR _____ DATE _____

04/18/2022 REVISION
03/14/2022 REVIEW
SHEET

A.1

2

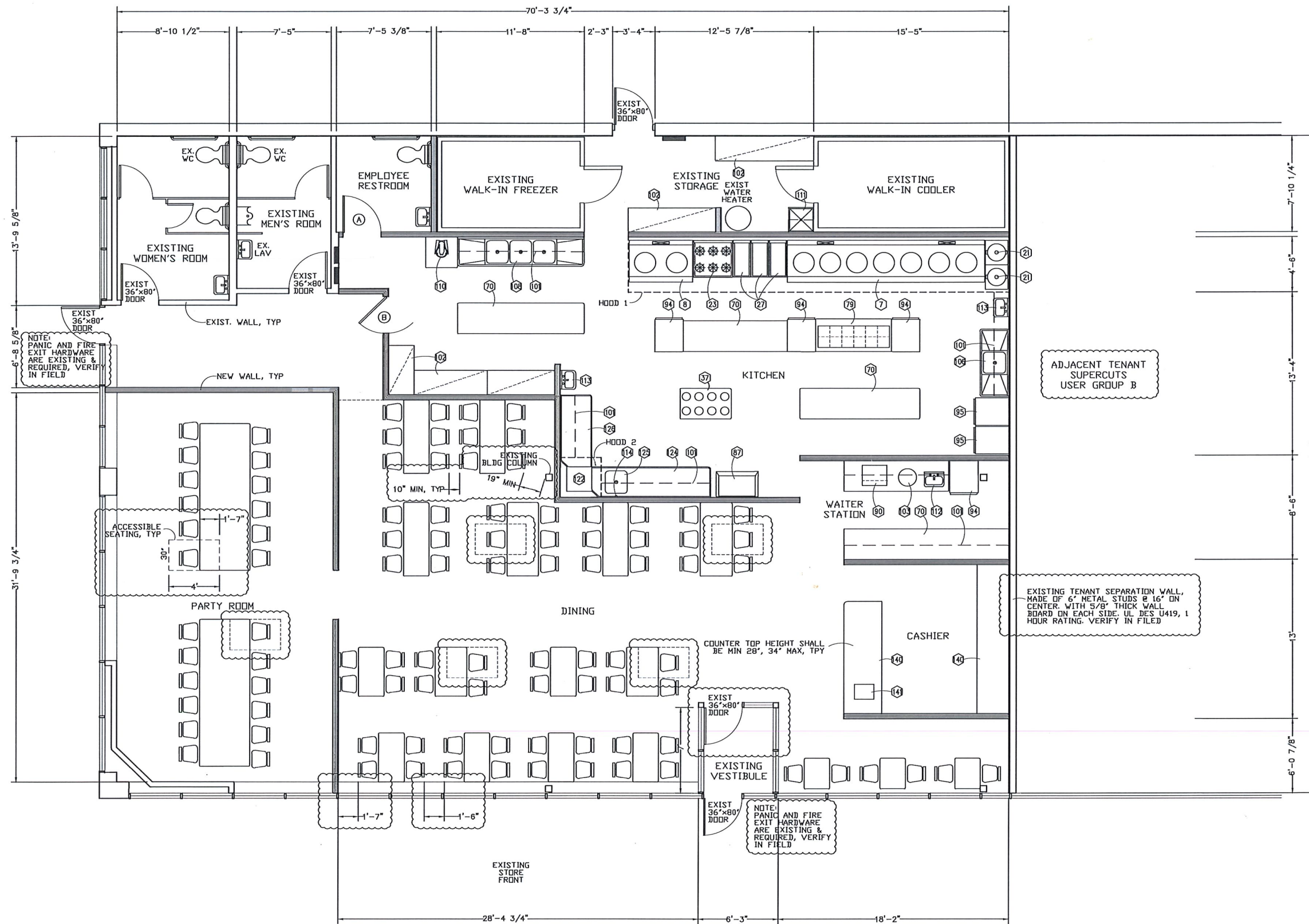

FLOOR PLAN
SCALE: 1/4" = 1'-0"



NOTE:
PROVIDE SPLASH GUARDS ON
BOTH SIDES OF ALL HAND
SINKS

REVISED -
REVIEWED
05/04/2022
City of Rochester Hills
Building Department